



**Dong Ying FUDA Solar Power Co.,LTD**  
**High-Tech.Development Zone, Dongying City,**  
**Shandong Province 257000, P. R. China**

<b>Product Specification</b> (54Cell Poly Crystalline156×156mm Solar Photovoltaic Module, 1000V System Voltage)	<b>Product Name</b>	Crystalline Solar Photovoltaic Module
	<b>Document Name</b>	Product Specification:FUDA-190P-54 to 210P-54
	<b>Document Number</b>	FUDA-PS-M-0024
	<b>Revision Number &amp; Date</b>	A, August 2009

### Typical Electrical Characteristics

Model Number	UOM	FUDA-200P-54	FUDA-205P-54	FUDA-210P-54
Rated Maximum Power-Pmax	Wp	200	205	210
Power Tolerance	%	±3	±3	±3
Maximum Power Voltage-Vmp	V	26.7	26.9	27.1
Maximum Power Current-Imp	A	7.50	7.63	7.75
Open Circuit Voltage-Voc	V	33.1	33.3	33.5
Short Circuit Current-Isc	A	8.15	8.25	8.35
Maximum System Voltage-VDC	V	1000		
Encapsulated Solar Cell Efficiency-ηc	%	15.2	15.6	16.0
Module Efficiency-ηm	%	13.6	13.9	14.3
Solar Cell and Configuration		54cells (156mm x 156mm) in a 6x9 matrix connected in series		
Solar Cell Type & Size	mm	Poly Crystalline156*156		
Cable Type, Diameter		4mm <sup>2</sup> (12AWG), TUV Certified		
Type of Connector		Multi-Contact Type IV		
Junction Box		IP65, 1000VDC, TUV Certified		
Number of Bypass Diodes & Type		3 Nos, Schottky By-pass diodes		
Maximum Series Fuse Rating	A	14		
Temperature coefficient of Power	%/℃	- 0.45		
Temperature coefficient of Voc	%/℃	- 0.35		
Temperature coefficient of Isc	%/℃	0.05		
Nominal Operating Cell Temperature-NOCT	℃	45±2		
Standard Test Conditions	STC	STC:AM=1.5, 1000W/m <sup>2</sup> , Cells Temperature 25℃		
Operating Temperature	℃	-40~+85		
Product Certifications		IEC 61215, IEC 61730 & CE		

### Mechanical and Packaging Characteristics

Dimension A*B*C	mm	1474*992*46
Installation Hole Dimension D*E*F	mm	942*1202*702
Cable Length	mm	1000
Weight	Kg	18.0
Number of Draining Holes in the Frame		8
Construction		Superstrate: High transmission 3.2mm tempered low iron glass; Substrate: White Back Sheet; Encapsulant: Fast Cure EVA
Frame		Clear anodized aluminum alloy type 6063T5; Color: silver
Packing Configuration and Quantity per Pallet		20pcs per carton and one carton per pallet
Container Loading Capacity		560pcs per 40ft High Cubic Container

<b>Prepared by:</b>	<b>Approved by :</b>
---------------------	----------------------

<b>Product Specification</b> (54Cell Poly Crystalline 156×156mm Solar Photovoltaic Module, 1000V System Voltage)	<b>Product Name</b>	Crystalline Solar Photovoltaic Module
	<b>Document Name</b>	Product Specification:FUDA-190P-54 to 210P-54
	<b>Document Number</b>	FUDA-PS-M-0024
	<b>Revision Number &amp; Date</b>	A, August 2009

### I-V Characteristics at different Irradiances & Temperatures

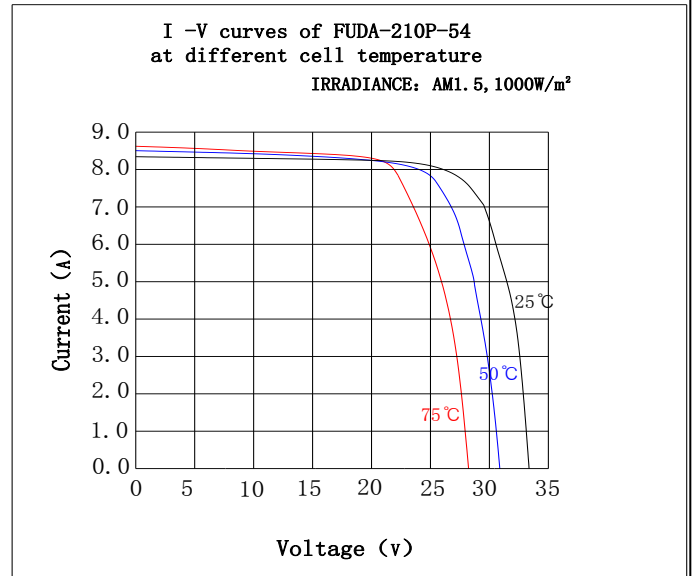
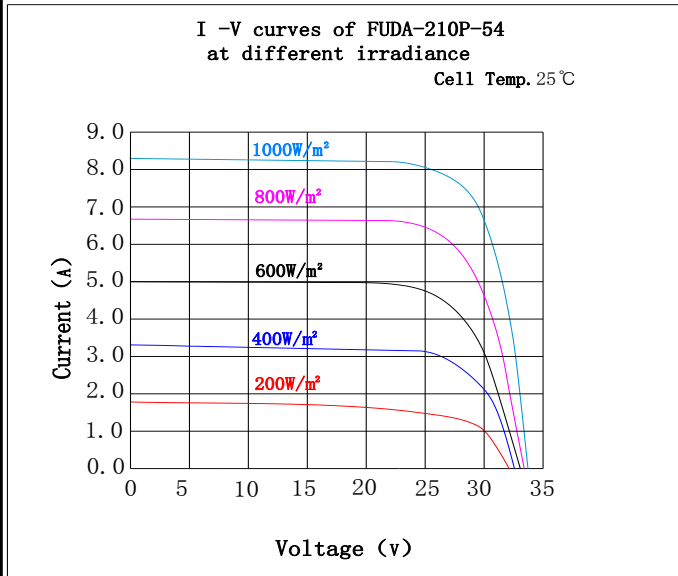

### Dimensional Characteristics

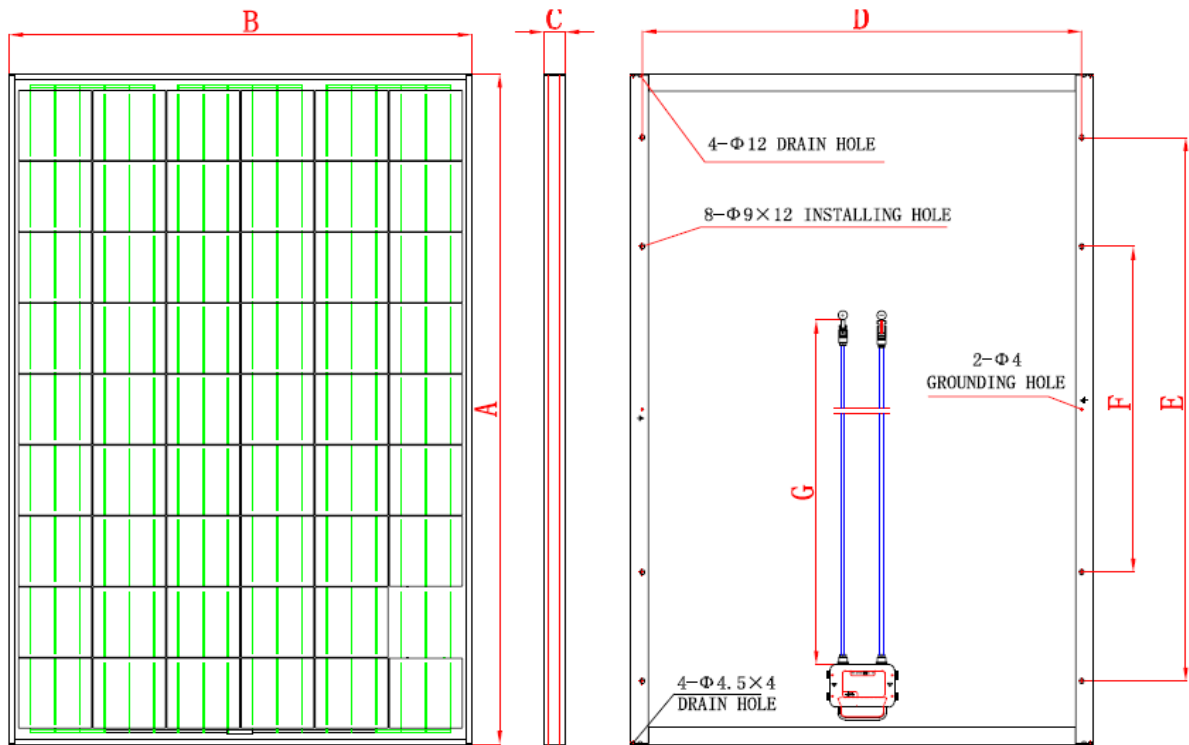

Prepared by:

Approved by :