

## PHOTOVOLTAIC MODULE IFRI 250-60

### MAIN FEATURES OF IFRI 250-60 MODULE



- Aluminium anodized compact frame, more than 15µm anodize thickness. RTV silicone used for its assembly.
- Totally tempered safety glass sheet and PVF-PET-PVF back sheet provides a complete protection and sealing against mechanical damage and water ingress.
- IP67 Junction box.
- Fast response by-pass diodes provide electrical protection.
- Easy to mount solar grade cables with quick snap-in connectors and safety auto-blocking system.

### SPECIFICATIONS

Electrical Specifications (Standard Test Conditions)									
Model: 156mm Multi crystalline 6x10		IFRI 225-60	IFRI 230-60	IFRI 235-60	IFRI 240-60	IFRI 245-60	IFRI 250-60	IFRI 255-60	IFRI 260-60
Maximum rated power ( $P_{max}$ )	W	225	230	235	240	245	250	255	260
Tolerance	%	+/- 3	+/- 3	+/- 3	+/- 3	+/- 3	+/- 3	+/- 3	+/- 3
Maximum power voltage ( $V_{mp}$ )	V	30,28	30,35	30,58	30,76	31,01	31,38	31,66	32,05
Maximum power current ( $I_{mp}$ )	A	7,44	7,56	7,68	7,79	7,89	7,95	8,03	8,1
Open circuit voltage ( $V_{oc}$ )	V	36,66	36,72	36,9	37,08	31,01	31,38	31,66	32,05
Short circuit current ( $I_{sc}$ )	A	7,97	8,09	8,21	8,32	8,42	8,5	8,58	8,65

\*Measured at STC conditions: Light spectrum of AM 1.5; Irradiation 1000 W/m<sup>2</sup>; Cell temperature 25 °C

Limits	
Operating temperature	-40 a +85 °C
Maximum system voltage	1000 VDC

Temperature Correction Coefficients	
NOCT	46 °C ± 2 °C
Current correction coef.	0,06 %/K
Voltage correction coef.	-0,33 %/K
Power correction coef.	-0,45 %/K

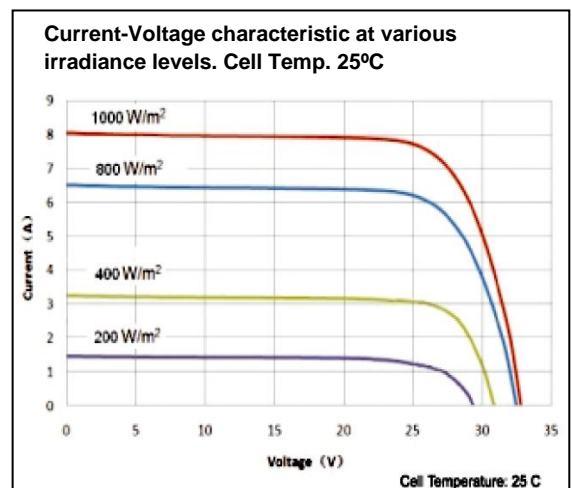

## PHOTOVOLTAIC MODULE IFRI 250-60

Constructive Specifications	
Cell type	P-type Multicrystalline 156 mm
Number of cells in series	60
Number of cells in paralel	1
Dimensions (L x W x H)	1649 mm x 992 mm x 40 mm
Weight	19,5 kg
Front face	High transmission, low iron, 3.2 mm thickness, fully tempered glass sheet
Encapsulant	Fast cure, UV stabilized EVA
Back face	UV stabilized, high reflectance, white/white color 3 layer PVF / PET / PVF film (TPT), or similar
Junction box	IP67 weatherproof
Electrical cables and connectors	Double insulated and halogen free Solar jacket, 4 mm <sup>2</sup> cable and 4 mm <sup>2</sup> snap-in Solar connector, 1000 mm length
Frame	Clear anodized aluminum alloy AL6063/6060-T6, 15 µm minimum anodize thickness. Tubular section
Electrical protection	6 Schottky barrier rectifier type bypass diodes integrated in Jbox

### MODULE DIMENSIONS

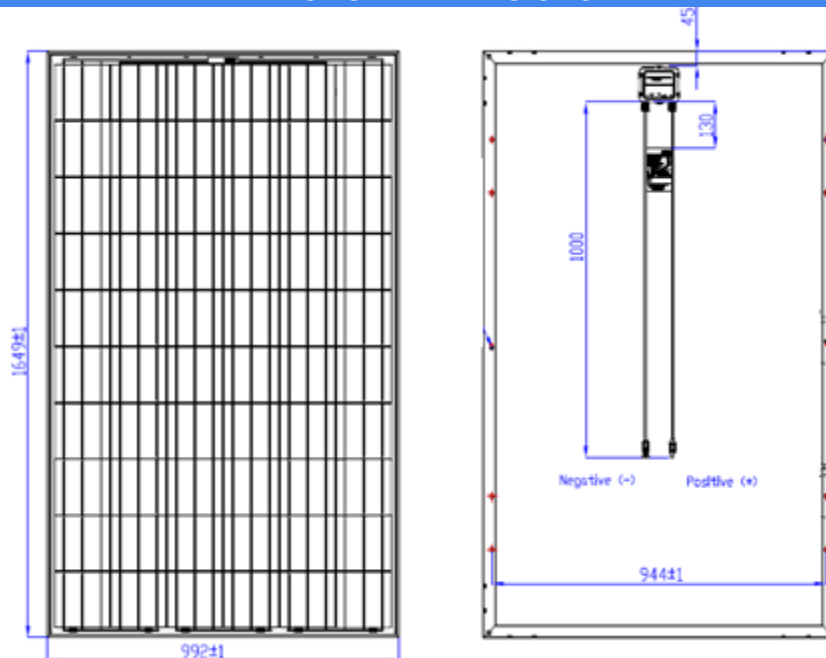

### WARRANTY TERMS

- **Power Warranty**
  - Up to the tenth year : 92%
  - From year 11th to 25th : 85%
- **Product Warranty**
  - 10 years freedom from defects

*Measured at STC conditions with product cable terminations: Light spectrum of AM 1.5; Irradiation 1000 W/m<sup>2</sup>; Cell temperature 25 °C*

### CERTIFICATIONS

**IEC 61215, IEC 61730 certifications by TÜV Rheinland (In process).**