

Play it safe



Premium Modules
MADE IN GERMANY

Illustration only

Premium XM poly black Premium incell XM poly black

195 W ▪ 200 W ▪ 205 W ▪ 210 W

- Homogeneous appearance for aesthetically demanding projects
- Plus-sorted
- Guaranteed high yields for decades
- Premium XM: Improved innoframe stability
Premium incell XM: For roof-integrated systems – with patented SOLRIF® frame



Premium XM poly black / Premium incell XM poly black

Electrical data under STC (Standard Test Conditions: 1000 W/m², 25 °C, AM 1.5)

Rated power	P_{max}	195 W	200 W	205 W	210 W
Sorting limits of performance		-0/+5 W	-0/+5 W	-0/+5 W	-0/+5 W
Voltage	U_{MPP}	23.65 V	24.10 V	24.60 V	25.00 V
Open circuit voltage	U_{OC}	29.27 V	29.75 V	30.34 V	30.83 V
Current	I_{MPP}	8.25 A	8.30 A	8.35 A	8.40 A
Short-circuit current	I_{SC}	8.45 A	8.60 A	8.80 A	8.95 A
Efficiency	Premium XM poly black	14.5 %	14.8 %	15.2 %	15.6 %
	Premium incell XM poly black	14.3 %	14.7 %	15.0 %	15.4 %

Electrical data at 800 W/m², NOCT (45°C +/- 2K), AM 1.5

Power in MPP	P_{max}	147 W	151 W	155 W	159 W
Voltage	U_{MPP}	22.13 V	22.55 V	23.02 V	23.39 V
Open circuit voltage	U_{OC}	26.92 V	27.37 V	27.91 V	28.36 V
Current	I_{MPP}	6.66 A	6.70 A	6.74 A	6.78 A
Short-circuit current	I_{SC}	6.82 A	6.94 A	7.10 A	7.22 A

The efficiency decreases by approximately 3% compared to the efficiency under STC at an irradiation of 200 W/m² and 25 °C.

Temperature data

Power temperature coefficient	$T_K(P_{MPP})$	-0.43 %/K
Voltage temperature coefficient	$T_K(U_{OC})$	-0.32 %/K
Current temperature coefficient	$T_K(I_{SC})$	0.04 %/K

Further information

Number of cells	60	
Max. system voltage	1000 V	
Reverse current loading capability	17 A	
Front cover	Special hardened low-iron glass with anti-reflex coating; Glare reduced to a minimum	
Module connection	Junction box 3 bypass diodes IP 67 no potting, 2 x approx. 1 m solar cable Ø 4 mm ² , plug connector PV4 IP 68	
Snow load*	Premium XM poly black	innoframe framed: 5400 Pa $\hat{=}$ 550 kg/m ²
	Premium incell XM poly black	With SOLRIF®: 5400 Pa $\hat{=}$ 550 kg/m ²

12-year product warranty, 25-year linear performance warranty according to our additional warranty conditions for solar power modules of the "Premium" product series, which we will gladly send you

Subject to technical modifications with corresponding follow-up certifications. Errors excepted.

*Load tested according to EN IEC 61215 (ed. 2) In compliance with the installation and operating manual.

**SOLRIF® in-roof mounting system: The manufacturer of this system, Ernst Schweizer AG, Hedingen, Switzerland, gives Solar-Fabrik a guarantee of 10 years on the delivered material and the parts of the system, in accordance with the guarantee terms of Schweizer, which we will gladly provide if requested. Guarantee claims will be processed for you by Solar-Fabrik. This guarantee warranted by Ernst Schweizer AG does not include the solar modules and does not affect the contractual warranty of Solar-Fabrik. by Ernst Schweizer AG does not include the solar modules and does not affect the contractual warranty of Solar-Fabrik.

Certifications

EN IEC 61215 (ed. 2)¹
 EN IEC 61730-1, -2¹
 EN 13501-1, class E
 Protection class II
 Directive 2006/95/EG (CE)
 CSTB for Premium incell system
 Hail protection class 3

¹Subject to follow-up certifications.

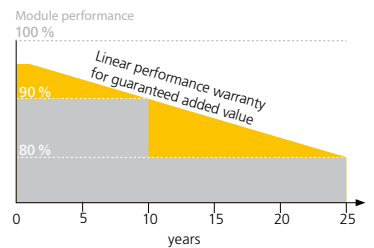

■ Linear performance warranty
 ■ Standard tiered warranty

Your specialist dealer:

Solar-Fabrik AG
 Munzinger Str. 10
 79111 Freiburg
 Germany
 Phone +49 (0)761 4000-0
 Fax +49 (0)761 4000-199
 info@solar-fabrik.de
www.solar-fabrik.de

Premium XM
 poly black
 Weight:
 approx. 15 kg

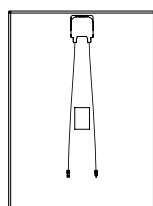
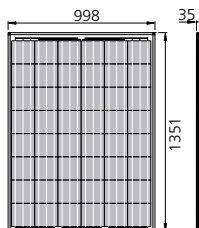

Premium incell XM
 poly black
 Weight:
 approx. 17 kg

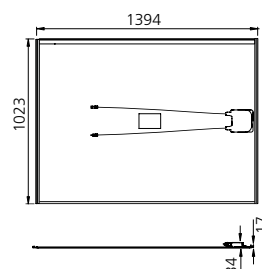
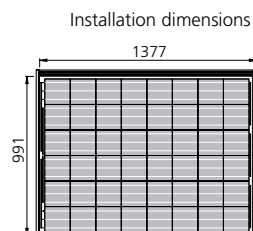

Note: Ensure correct polarity!