



Mono Crystalline Solar Module

HS-MB1 Series

Physical Characteristics

Cells per Module	72 Cells (6x12)
Cell Type	Mono-crystalline Silicon
Module Dimension (L x W x H)	1954x990x38 (mm)
Module Weight	23Kg
Frame	Anodized Aluminum (Black frame available by customer order)
Front Glass	4 mm Tempered Glass
Junction Box	IP66/IP65, 4mm ²
Cable Length	1000mm

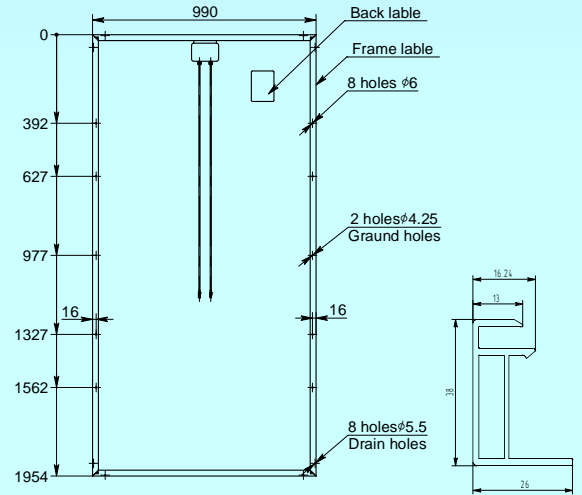

Electrical Characteristics

Item	Unit	HS-MB1/300	HS-MB1/305	HS-MB1/310	HS-MB1/315	HS-MB1/320	HS-MB1/325	HS-MB1/330
Max. Power (Pmax)	W	300	305	310	315	320	325	330
Open circuit voltage (Voc)	V	44,90	45,30	45,40	45,80	45,90	46,10	46,10
Short circuit current (Isc)	A	8,75	8,95	8,96	8,99	9,12	9,13	9,14
Max. Power voltage (Vmp)	V	36,60	36,60	37,00	37,20	37,40	37,80	38,50
Max. Power current (Imp)	A	8,20	8,34	8,38	8,47	8,56	8,60	8,58
Module efficiency	%	15,51	15,77	16,03	16,28	16,54	16,80	17,06
Power tolerance	W	0...+4,99						

*STC (Standard Test Condition): 1000W/m², AM 1.5, 25°C

Permissible operating conditions

Temperature range	-40 to +85 °C
Maximum system voltage	1,000V DC(IEC), 600V DC(UL)
Maximum surface load cap	5,400Pa
Maximum hailstone impact (diameter / velocity)	25mm / 23m/s

*NOCT (Nominal Operating Cell Temperature): 800W/m², 20°C, wind speed 1m/s

Thermal Characteristics

Rating	Unit	Value	
NOCT	°C	47±2	
Temperature coefficient	Isc	%/°C	+ 0,04
	Voc	%/°C	- 0,32
	P _{MAX}	%/°C	- 0,44

Packing Specifications

Packing box dimension (L x W x H)	1980 x 800 x 1150 (mm)
Number of modules per pallet	20

I-V curves

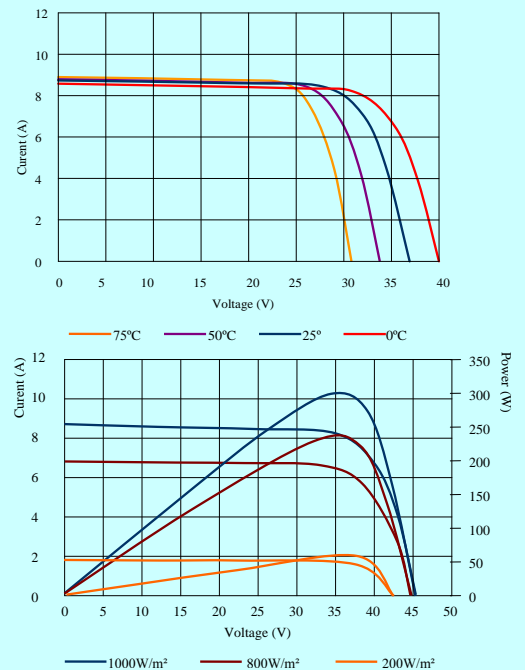

Warranty

10 Years of product warranty.
 10 Years for 90% of warranty min. power.
 25 Years for 80% of warranty min. power.

Qualifications and Certificates

