

70-75 Watt

MONO CRYSTALLINE MODULE 36x(156mmx78mm)

www.risenenergy.com
THE POWER OF RISING VALUE

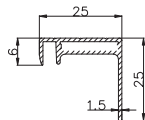

Electrical Characteristics

Model	Pm(Wp)	Tolerance	Vm(V)	Im(A)	Voc(V)	Isc(A)
SYP70M	70W	+3%	17.9	3.92	22.1	4.30
SYP75M	75W	+3%	18.0	4.17	22.3	4.63

Valued at STC (AM 1.5, 1000W/m², 25°C)

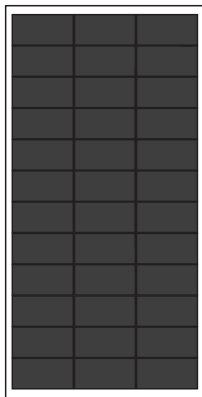
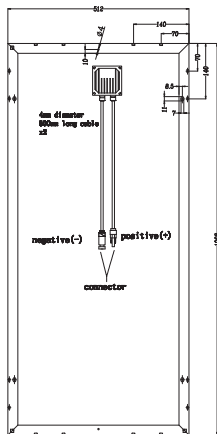

Specifications

- Number of mono crystalline solar cell 36pcsx(156mmX78mm)
- Aluminum frame, dimension1008x512x25mm
- Weight 6.0kg
- Temperature coefficient of VOC(β)=-0.39%/°C
- Temperature coefficient of ISC(α)=+0.033%/°C
- Temperature coefficient of Pmax=-0.44%/°C
- Bypass diodes to reduce loss in partial shadow
- IP65
- CE Standard
- Performance test data for each module