

210-230 Watt

MONO CRYSTALLINE MODULE 72x(156mmx117mm)

www.risenenergy.com
THE POWER OF RISING VALUE



Electrical Characteristics

Model	Pm(Wp)	Tolerance	Vm(V)	Im(A)	Voc(V)	Isc(A)
SYP210M	210W	+3%	35.1	5.99	43.8	6.66
SYP215M	215W	+3%	35.4	6.08	44.2	6.76
SYP220M	220W	+3%	35.8	6.15	44.7	6.84
SYP225M	225W	+3%	36.0	6.25	45.0	6.95
SYP230M	230W	+3%	36.2	6.36	45.2	7.07

Valued at STC (AM 1.5, 1000W/m², 25°C)

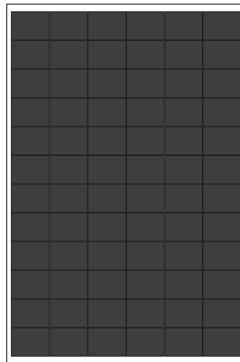
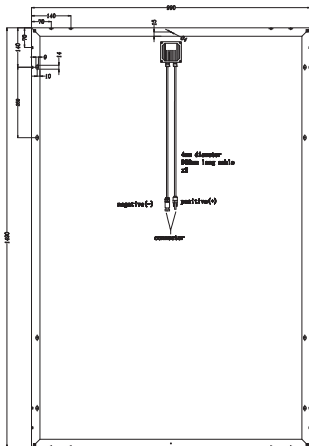
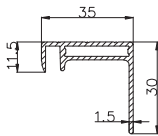

Specifications

- Number of mono crystalline solar cell 72pcsx(156mmX117mm)
- Aluminum frame, dimension 990x1490x35mm
- Weight 16.5kg
- Temperature coefficient of VOC(β) = -0.39%/°C
- Temperature coefficient of ISC(α) = +0.033%/°C
- Temperature coefficient of Pmax = -0.44%/°C
- Bypass diodes to reduce loss in partial shadow
- IP65
- CE Standard
- Performance test data for each module