

Monocrystalline Type



RNG— Mono

10/20/30/50/60/100/150/250W

Key Features

- High module conversion efficiency
- Top ranked PTC rating
- Quick and inexpensive mounting
- 100% EL testing on all Renogy modules
- No hot spots guaranteed



Electrical Characteristics

Maximum Power at STC (Pmax)	10W	20W	30W	50W	100W	150W	250W
Dimensions	7.3×16.3×1in	13.5×18.5×1in	13.5×23.8×1in	24.8×21.3×1in	47×21.3×1.4in	39.5×39×1.4in	64.5×39×1.6in
Optimum Operating Voltage (Vmp)	17.5V	17.5V	17.5V	18.5V	18.9V	17.9V	30.1V
Optimum Operating Current (Imp)	0.57A	1.14A	1.71A	2.70A	5.29A	8.38A	8.32A
Open-Circuit Voltage (Voc)	21.6V	21.6V	21.6V	22.7V	22.5V	22.5V	37.50V
Short-Circuit Current (Isc)	0.62A	1.23A	1.85A	2.84A	5.75A	9.05A	8.87A
Module Efficiency	13.03%	12.33%	14.37%	14.67%	15.47%	15.15%	15.37%
Weight	3.5lbs(1.58kg)	4.8lbs(2.2kg)	6.2lbs(2.8kg)	9.9lbs(4.5kg)	16.5lbs(7.5kg)	25.5lbs(11.5kg)	40lbs(18kg)

STC : Irradiance 1000 W/m², Module temperature 25°C, AM = 1.5

Application

- On-grid Rooftop/ Ground Mounted
- Residential/ Commercial/ Power Stations
- Compatible with Enphase Inverters

Linear Warranty

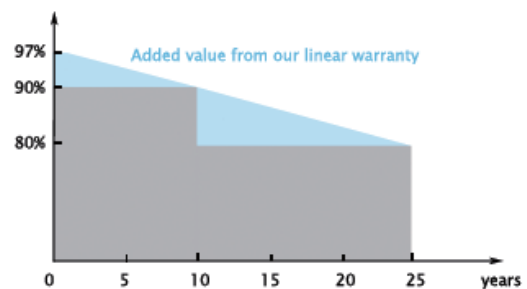

Safety Guide

Only qualified personnel should install or perform maintenance.
Please read the Renogy Installation Manual before installation;
Be aware of dangerously high DC voltage;
Do not install modules when wet or broken.

Renogy Modules' performance is guaranteed within 25 years from the time of purchase according to the above chart. Our Warranty includes:

1. 25 year transferrable power warranty : 5 years / 95%, 10 years / 90%, 25 years / 80%
2. 10 year material and workmanship warranty

Note:

3.5% in the first year, thereafter 0.68% per year, ending with 80.1% in the 25 year after the warranty start date.



RNG-10D

10W Monocrystalline Solar Panel

Electrical Data

Maximum Power at STC*	10 W
Optimum Operating Voltage (V_{mp})	17.5 V
Optimum Operating Current (I_{mp})	0.57 A
Open Circuit Voltage (V_{oc})	21.6 V
Short Circuit Current (I_{sc})	0.62 A
Module Efficiency	13.03%
Maximum System Voltage	600 VDC UL
Maximum Series Fuse Rating	5 A

Thermal Characteristics

Operating Module Temperature	-40°C to +90°C
Nominal Operating Cell Temperature (NOCT)	47±2°C
Temperature Coefficient of Pmax	-0.23%/°C
Temperature Coefficient of Voc	-0.33%/°C
Temperature Coefficient of Isc	0.05%/°C

Junction Box

IP Rating	IP 67
Diode Type	HY 10A10
Number of Diodes	1 Diode(s)
Output Cables	14 AWG (3 ft long)

Module Diagram

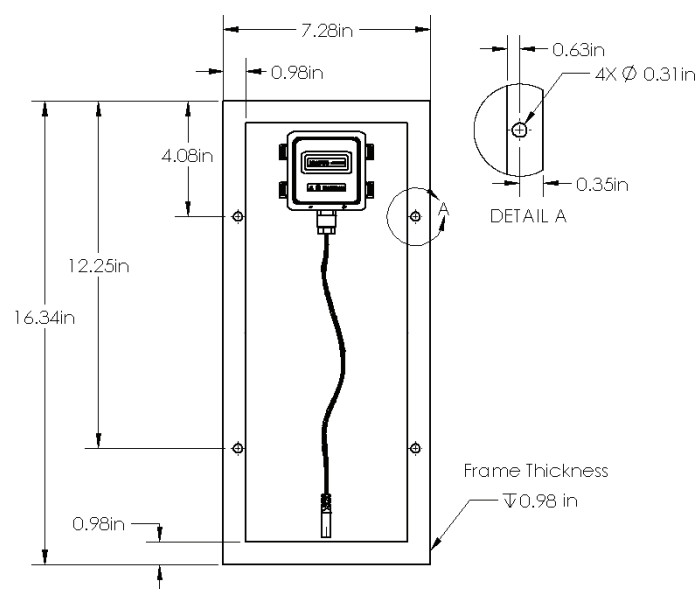

*All specifications and data described in this data sheet are tested under Standard Test Conditions (STC - Irradiance: 1000W/m², Temperature: 25 °C, Air Mass: 1.5) and may deviate marginally from actual values. Renogy and any of its affiliates has reserved the right to make any modifications to the information on this data sheet without notice. It is our goal to supply our customers with the most recent information regarding our products. These data sheets can be found in the downloads section of our website, www.renogy-store.com

Mechanical Data

Solar Cell Type	Monocrystalline (2.0 x 1.14 in)
Number of Cells	36 (12 x 3)
Dimensions	7.3 x 16.3 x 1 in (185 x 415 x 25 mm)
Weight	3.5 lbs (1.58 kg)
Front Glass	Tempered Glass 0.13 in (3.2 mm)
Frame	Anodized Aluminium Alloy
Connectors	MC4 Connectors
Fire Rating	Class C

MC4 Connectors

Rated Current	30A
Maximum Voltage	1000VDC
Maximum AWG Size Range	10 AWG
Temperature Range	-40°F to 194°F
IP Rating	IP 67

Certifications



IV-Curve

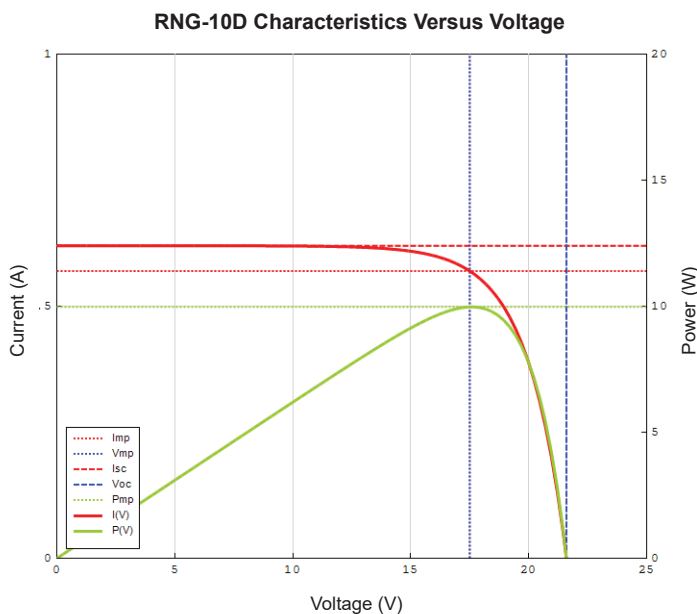

RNG-20D

20W Monocrystalline Solar Panel

Electrical Data

Maximum Power at STC*	20 W
Optimum Operating Voltage (V_{mp})	17.5 V
Optimum Operating Current (I_{mp})	1.14 A
Open Circuit Voltage (V_{oc})	21.6 V
Short Circuit Current (I_{sc})	1.23 A
Module Efficiency	12.33%
Maximum System Voltage	600 VDC UL
Maximum Series Fuse Rating	10 A

Thermal Characteristics

Operating Module Temperature	-40°C to +90°C
Nominal Operating Cell Temperature (NOCT)	47±2°C
Temperature Coefficient of Pmax	-0.23%/°C
Temperature Coefficient of Voc	-0.33%/°C
Temperature Coefficient of Isc	0.05%/°C

Junction Box

IP Rating	IP 67
Diode Type	HY 10A10
Number of Diodes	1 Diode(s)
Output Cables	14 AWG (3ft long)

Module Diagram

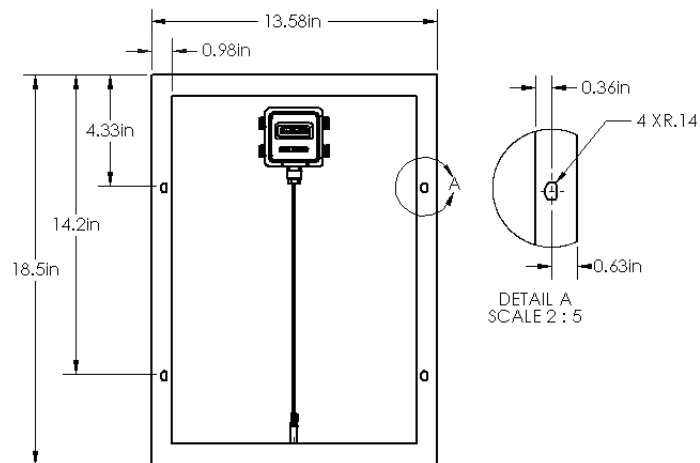

Mechanical Data

Solar Cell Type	Monocrystalline (6.1 x 0.75in)
Number of Cells	36 (2 x 18)
Dimensions	13.5 x 18.5 x 1 in (345 x 470 x 25 mm)
Weight	4.8 lbs (2.2 kg)
Front Glass	Tempered Glass 0.13 in (3.2 mm)
Frame	Anodized Aluminium Alloy
Connectors	MC4 Connectors
Fire Rating	Class C

MC4 Connectors

Rated Current	30A
Maximum Voltage	1000VDC
Maximum AWG Size Range	10 AWG
Temperature Range	-40°F to 194°F
IP Rating	IP 67

Certifications



IV-Curve

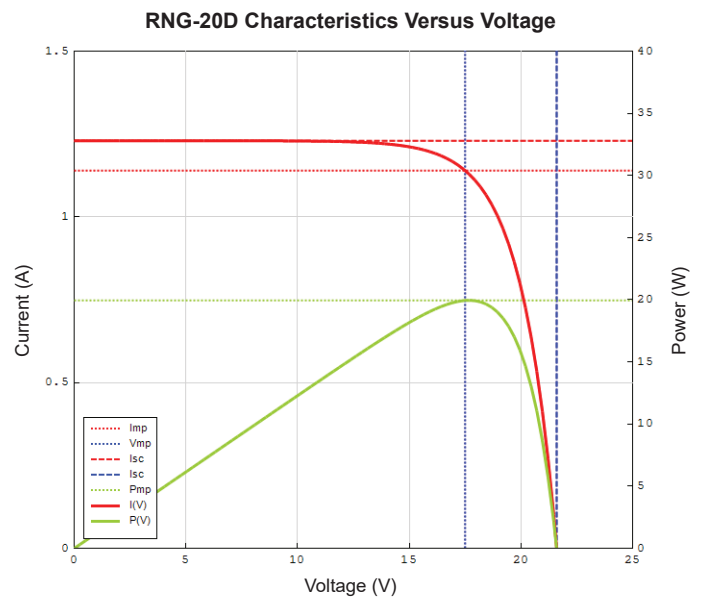

*All specifications and data described in this data sheet are tested under Standard Test Conditions (STC - Irradiance: 1000W/m², Temperature: 25°C, Air Mass: 1.5) and may deviate marginally from actual values. Renogy and any of its affiliates has reserved the right to make any modifications to the information on this data sheet without notice. It is our goal to supply our customers with the most recent information regarding our products. These data sheets can be found in the downloads section of our website, www.renogy-store.com

RNG-30D

30W Monocrystalline Solar Panel

Electrical Data

Maximum Power at STC*	30 W
Optimum Operating Voltage (V_{mp})	17.5 V
Optimum Operating Current (I_{mp})	1.71 A
Open Circuit Voltage (V_{oc})	21.6 V
Short Circuit Current (I_{sc})	1.85 A
Module Efficiency	14.37%
Maximum System Voltage	600 VDC UL
Maximum Series Fuse Rating	5 A

Thermal Characteristics

Operating Module Temperature	-40°C to +90°C
Nominal Operating Cell Temperature (NOCT)	47±2°C
Temperature Coefficient of Pmax	-0.23%/°C
Temperature Coefficient of Voc	-0.33%/°C
Temperature Coefficient of Isc	0.05%/°C

Junction Box

IP Rating	IP 67
Diode Type	HY 10A10
Number of Diodes	1 Diode(s)
Output Cables	14 AWG (3 ft long)

Module Diagram

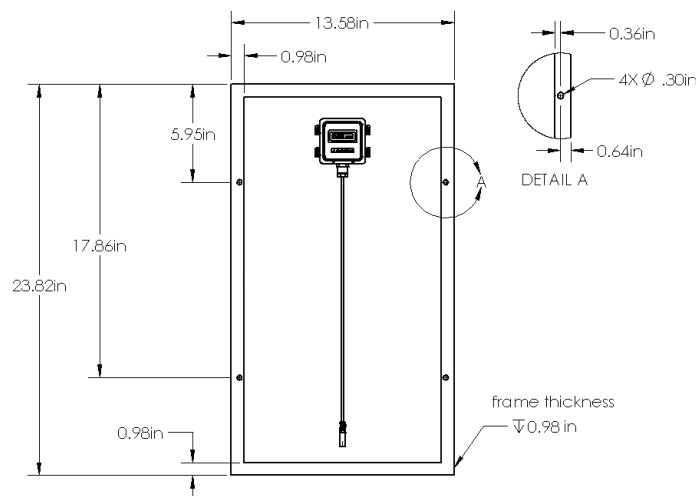

Mechanical Data

Solar Cell Type	Monocrystalline (6.1 x 1.14 in)
Number of Cells	36 (2 x 18)
Dimensions	13.5 x 23.8 x 1 in (345 x 605 x 25 mm)
Weight	6.2 lbs (2.8 kg)
Front Glass	Tempered Glass 0.13 in (3.2 mm)
Frame	Anodized Aluminium Alloy
Connectors	MC4 Connectors
Fire Rating	Class C

MC4 Connectors

Rated Current	30A
Maximum Voltage	1000VDC
Maximum AWG Size Range	10 AWG
Temperature Range	-40°F to 194°F
IP Rating	IP 67

Certifications



IV-Curve

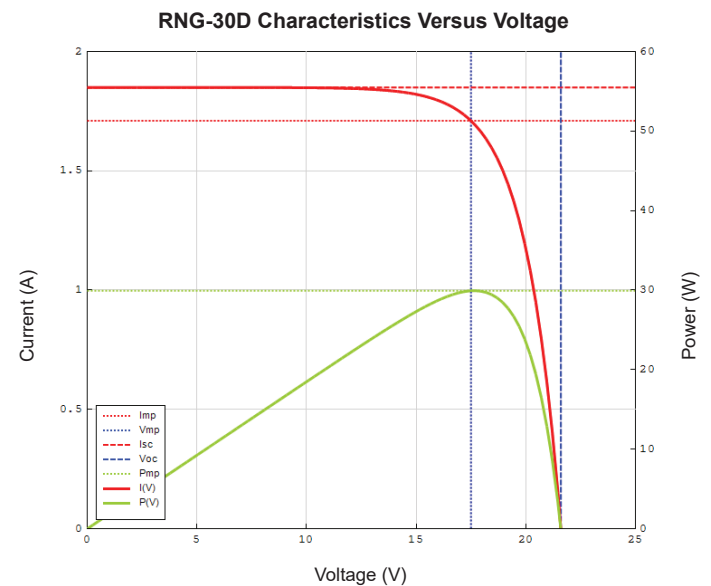

*All specifications and data described in this data sheet are tested under Standard Test Conditions (STC - Irradiance: 1000W/m², Temperature: 25°C, Air Mass: 1.5) and may deviate marginally from actual values. Renogy and any of its affiliates has reserved the right to make any modifications to the information on this data sheet without notice. It is our goal to supply our customers with the most recent information regarding our products. These data sheets can be found in the downloads section of our website, www.renogy-store.com

RNG-50D

50W Monocrystalline Solar Panel

Electrical Data

Maximum Power at STC*	50 W
Optimum Operating Voltage (V_{mp})	18.5 V
Optimum Operating Current (I_{mp})	2.70A
Open Circuit Voltage (V_{oc})	22.7 V
Short Circuit Current (I_{sc})	2.84 A
Module Efficiency	14.67%
Maximum System Voltage	600 VDC UL
Maximum Series Fuse Rating	15 A

Thermal Characteristics

Operating Module Temperature	-40°C to +90°C
Nominal Operating Cell Temperature (NOCT)	47±2°C
Temperature Coefficient of Pmax	-0.23%/°C
Temperature Coefficient of Voc	-0.33%/°C
Temperature Coefficient of Isc	0.05%/°C

Junction Box

IP Rating	IP 67
Diode Type	HY 10SQ05
Number of Diodes	1 Diode(s)
Output Cables	12 AWG (1.12 ft long)

Module Diagram

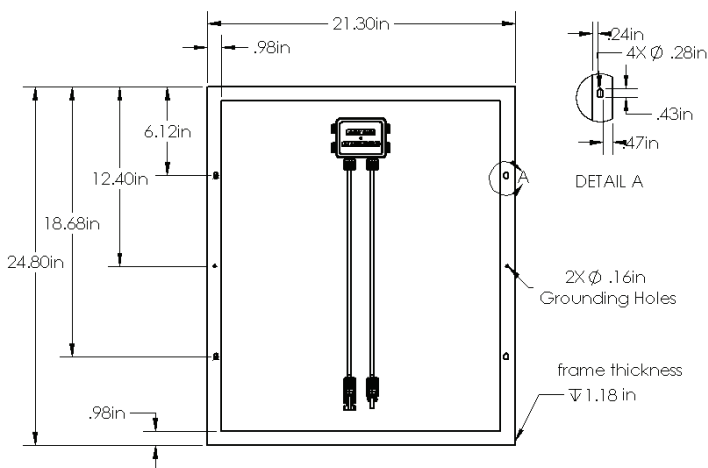

Mechanical Data

Solar Cell Type	Monocrystalline (4.9 x 2.5 in)
Number of Cells	36 (4 x 9)
Dimensions	24.8 x 21.3 x 1.2 in (630 x 541 x 30 mm)
Weight	9.9 lbs (4.5 kg)
Front Glass	Tempered Glass 0.13 in (3.2 mm)
Frame	Anodized Aluminium Alloy
Connectors	MC4 Connectors
Fire Rating	Class C

MC4 Connectors

Rated Current	30A
Maximum Voltage	1000VDC
Maximum AWG Size Range	10 AWG
Temperature Range	-40°F to 194°F
IP Rating	IP 67

Certifications



IV-Curve

RNG-50D Characteristics Versus Voltage

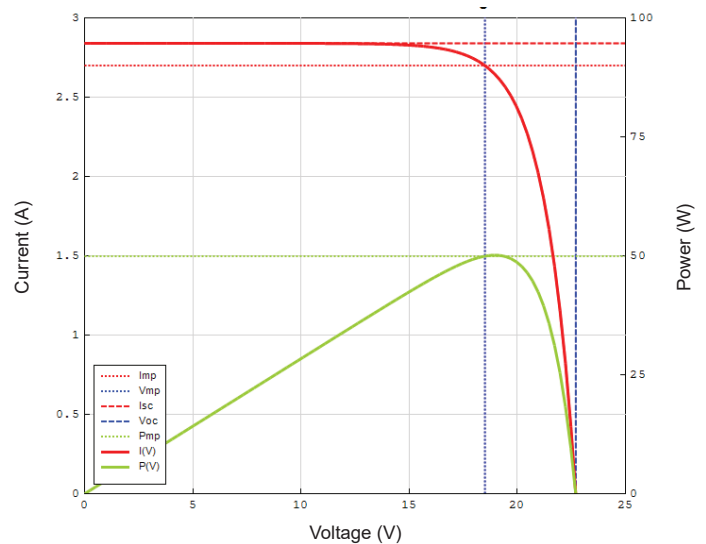

*All specifications and data described in this data sheet are tested under Standard Test Conditions (STC - Irradiance: 1000W/m², Temperature: 25°C, Air Mass: 1.5) and may deviate marginally from actual values. Renogy and any of its affiliates has reserved the right to make any modifications to the information on this data sheet without notice. It is our goal to supply our customers with the most recent information regarding our products. These data sheets can be found in the downloads section of our website, www.renogy-store.com

RNG-100D

100W Monocrystalline Solar Panel

Electrical Data

Maximum Power at STC*	100 W
Optimum Operating Voltage (V_{mp})	18.9 V
Optimum Operating Current (I_{mp})	5.29 A
Open Circuit Voltage (V_{oc})	22.5 V
Short Circuit Current (I_{sc})	5.75 A
Module Efficiency	15.47%
Maximum System Voltage	600 VDC UL
Maximum Series Fuse Rating	15 A

Thermal Characteristics

Operating Module Temperature	-40°C to +80°C
Nominal Operating Cell Temperature (NOCT)	47±2°C
Temperature Coefficient of Pmax	-0.44%/°C
Temperature Coefficient of Voc	-0.30%/°C
Temperature Coefficient of Isc	0.04%/°C

Junction Box

IP Rating	IP 67
Diode Type	HY 10SQ050
Number of Diodes	2 Diode(s)
Output Cables	12 AWG (2.10 ft long)

Module Diagram

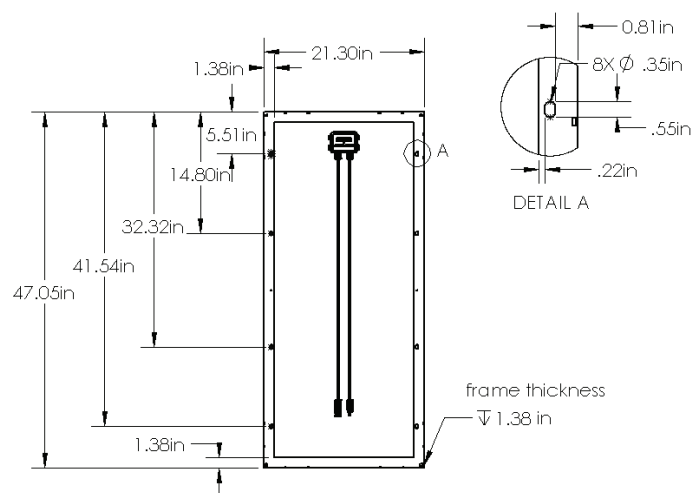

Mechanical Data

Solar Cell Type	Monocrystalline (4.92 x 4.92 in)
Number of Cells	36 (4 x 9)
Dimensions	47 x 21.3 x 1.4 in (1195 x 541 x 35 mm)
Weight	16.5 lbs (7.5 kg)
Front Glass	Tempered Glass 0.13 in (3.2 mm)
Frame	Anodized Aluminium Alloy
Connectors	MC4 Connectors
Fire Rating	Class C

MC4 Connectors

Rated Current	30A
Maximum Voltage	1000VDC
Maximum AWG Size Range	10 AWG
Temperature Range	-40°F to 194°F
IP Rating	IP 67

Certifications



IV-Curve

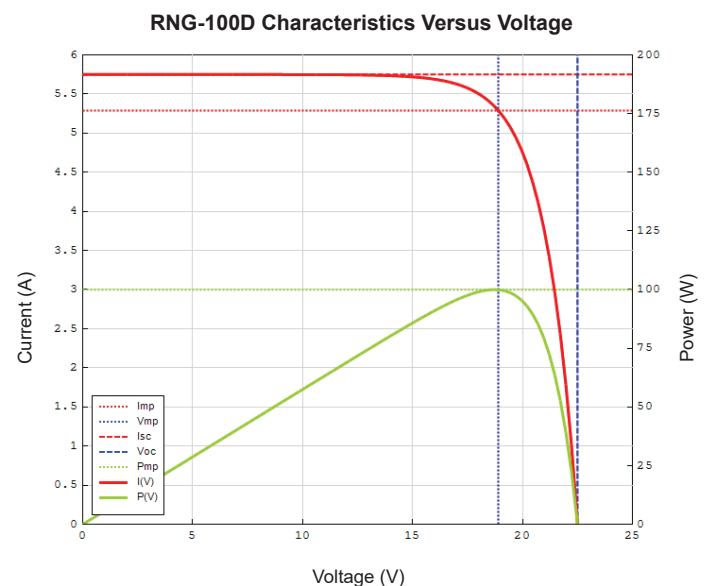

*All specifications and data described in this data sheet are tested under Standard Test Conditions (STC - Irradiance: 1000W/m², Temperature: 25°C, Air Mass: 1.5) and may deviate marginally from actual values. Renogy and any of its affiliates has reserved the right to make any modifications to the information on this data sheet without notice. It is our goal to supply our customers with the most recent information regarding our products. These data sheets can be found in the downloads section of our website, www.renogy-store.com

RNG-150D

150W Monocrystalline Solar Panel

Electrical Data

Maximum Power at STC*	150 W
Optimum Operating Voltage (V_{mp})	17.9 V
Optimum Operating Current (I_{mp})	8.38 A
Open Circuit Voltage (V_{oc})	22.5 V
Short Circuit Current (I_{sc})	9.05 A
Module Efficiency	15.15%
Maximum System Voltage	600 VDC UL
Maximum Series Fuse Rating	15 A

Thermal Characteristics

Operating Module Temperature	-40°C to +80°C
Nominal Operating Cell Temperature (NOCT)	47±2°C
Temperature Coefficient of Pmax	-0.44%/°C
Temperature Coefficient of Voc	-0.30%/°C
Temperature Coefficient of Isc	0.04%/°C

Junction Box

IP Rating	IP 67
Diode Type	HY 10SQ050
Number of Diodes	2 Diode(s)
Output Cables	12 AWG (2.40 ft long)

Module Diagram

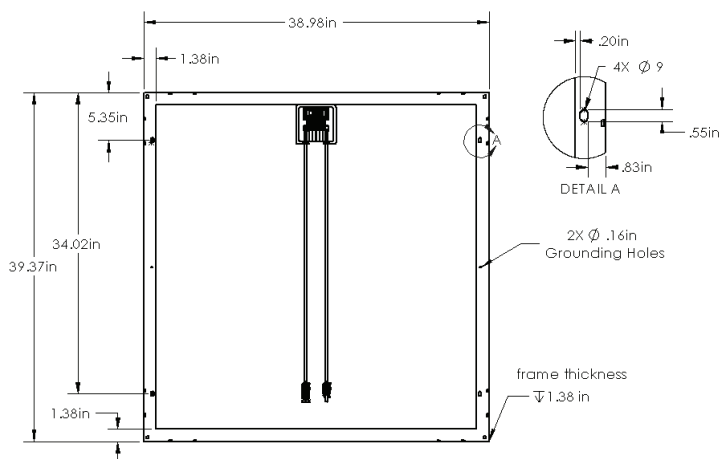

Mechanical Data

Solar Cell Type	Monocrystalline (6.10 x 6.10in)
Number of Cells	36 (6 x 6)
Dimensions	39.5 x 39 x 1.4 in (1000 x 990 x 35 mm)
Weight	25.5 lbs (11.5 kg)
Front Glass	Tempered Glass 0.13 in (3.2 mm)
Frame	Anodized Aluminium Alloy
Connectors	MC4 Connectors
Fire Rating	Class C

MC4 Connectors

Rated Current	30A
Maximum Voltage	1000VDC
Maximum AWG Size Range	10 AWG
Temperature Range	-40°F to 194°F
IP Rating	IP 67

Certifications



IV-Curve

RNG-150D Characteristics Versus Voltage

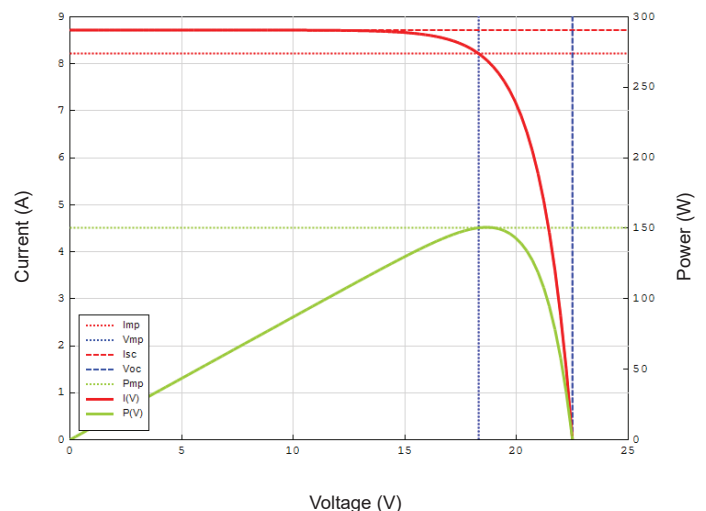

*All specifications and data described in this data sheet are tested under Standard Test Conditions (STC - Irradiance: 1000W/m², Temperature: 25°C, Air Mass: 1.5) and may deviate marginally from actual values. Renogy and any of its affiliates has reserved the right to make any modifications to the information on this data sheet without notice. It is our goal to supply our customers with the most recent information regarding our products. These data sheets can be found in the downloads section of our website, www.renogy-store.com

