

Company

Sunworth solar, we commit ourselves to R&D, manufacture and technical innovation on PV modules and solar power system. To provide high quality products with various specifications for customers is always our pursuit.

Characteristics

- High efficiency solar cell to keep the modules efficiency reach to 17.28%.
- Positive tolerance to ensure higher output.
- Excellent performance under weak light conditions.
- Modules withstand extremely (temperature, load and impact) TUV certification.
- All modules combination and packing through stepping current to keep effectively reduce mismatch loss within.
- 100% EL test to keep higher quality.



Anodized aluminum frame withstand corrosion and damage, Special osculum can reduce destruction by water freeze.

Warranty

- 25 years power output warranty, 90% power output for 10years, and 80% power output for 25years.
- 5 years workmanship warranty.



IP65 junction box long-term weather endurance.

Quality and safety

- ISO9001:2008 certified supplier, we provide world first class solar products for clients.
- IEC 61215, IEC 61730, IEC, CQC, CGC, CE, approved.





Electrical Characteristics

Model No.	SW155M	SW160M	SW165M	SW170M
Maximum Power (Pmax)	155W	160W	165W	170W
Max-power Voltage (Vmp)	18.7V	18.9V	19.1V	19.2V
Max-power Current (Imp)	8.29A	8.47A	8.64A	8.86A
Open-circuit Voltage (Voc)	22.9V	23.1V	23.3V	23.5V
Short-circuit Current (Isc)	8.64A	8.98A	9.18A	9.41A
Module Efficiency	15.75%	16.26%	16.77%	17.28%
Operating Temperature	-40°C~+85°C			
Maximum System Voltage	1000Vdc			
Maximum Series Fuse Rating	15A			
Power tolerance	0~+5W			

*STC condition: 1000 W/m², 1.5AM and 25°C cell temperature.

I-V Curve

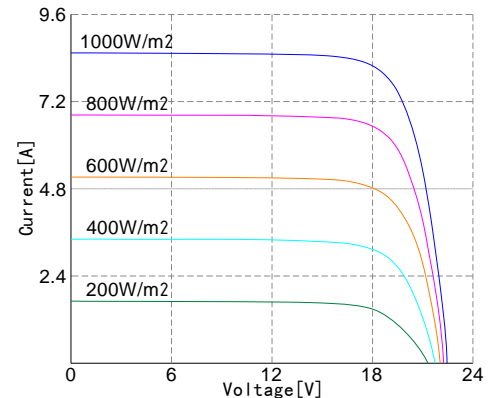

Temperature characteristics

NOCT	46°C±2°C
Temperature Co-efficient of Pmax	-0.43%/°C
Temperature Co-efficient of Voc	-0.35%/°C
Temperature Co-efficient of Isc	0.05%/°C

Mechanical characteristics

Model No.	SW155M/160M/165M/170M
Cell Type	Monocrystalline silicon 156*156mm
Cell Arrangement	36(4*9)
Dimensions	1480*665*30mm
Weight	11.1Kg
Front Cover	3.2mm tempered glass
Frame Material	Anodized aluminium alloy
Junction Box	IP65 rated
Output Cables	Optional
Connectors	Optional

Dimensions

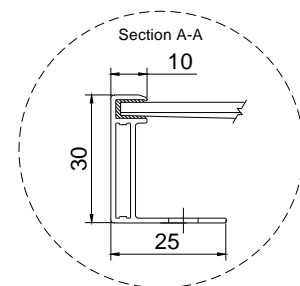
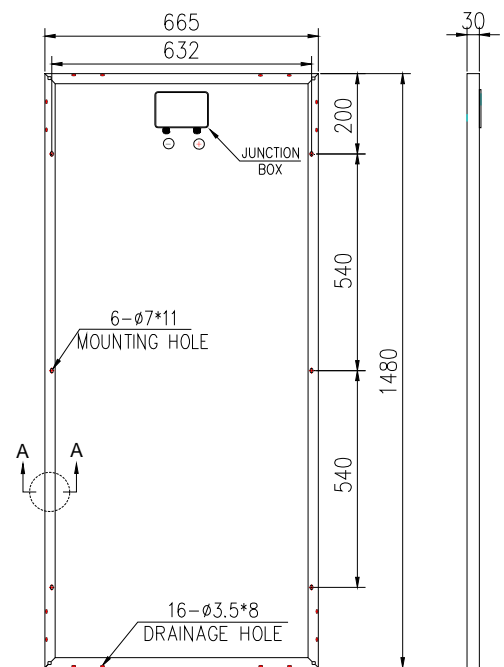

Packing

Packing	20'GP	40'GP
Pieces per Carton	2	2
Carton/Pallet	28	28
Pallet/Container	10	22
Pieces/container	560	1232

SUNWORTH SOLAR ENERGY CO., LTD

TEL: +86-769-2332 0882

Website: www.sun-worth.com

E-mail: sales@sun-worth.com