

# JUSTSOLAR MONO MODULE

JST280M(60)	280W
JST285M(60)	285W
JST290M(60)	290W
JST295M(60)	295W
JST300M(60)	300W
JST305M(60)	305W
JST305M(60)	310W



High conversion efficiency  
High module efficiency to guarantee power output.



0 to +5W positive tolerance  
Detailed information in Electrical Specifications.



Self-cleaning glass  
Coating glass for self-cleaning, reduce surface dust.



48-hour response service



Outstanding low irradiation performance  
Excellent module efficiency even in the weak light conditions, such as morning or cloudy.

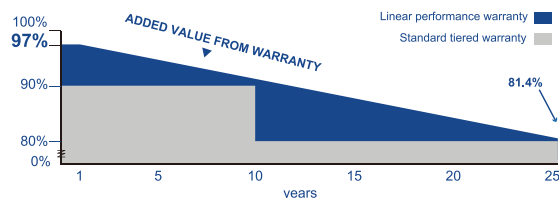

Excellent loading capability  
2400Pa wind loads, 5400Pa snow loads.



25-year performance warranty



10-year warranty on materials and workmanship

IEC 61215 Ed.2  
IEC 61730  
UL 1703



## ELECTRICAL DATA

Model Type	JST280M(60)	JST285M(60)	JST290M(60)	JST295M(60)	JST300M(60)	JST305M(60)	JST310M(60)
Peak Power (Pmax)	280W	285W	290W	295W	300W	305W	310W
Module Efficiency	17.11%	17.41%	17.72%	18.02%	18.33%	18.63%	18.93%
Maximum Power Voltage (Vmp)	31.60V	31.70V	31.80V	32.03V	32.26V	32.46V	32.67V
Maximum Power Current (Imp)	8.86A	8.99A	9.12A	9.21A	9.30A	9.40A	9.49A
Open Circuit Voltage (Voc)	39.05V	39.25V	39.46V	39.64V	39.85V	40.05V	40.26V
Short Circuit Current (Isc)	9.38A	9.46A	9.57A	9.66A	9.75A	9.85A	9.95A
Power Tolerance	0 to +5W						
Maximum System Voltage	1000V						
Nominal Operating Cell Temperature	44.4±2°C						
Maximum Series Fuse Rating	15A						

## MECHANICAL DATA

Cell Type	156×156mm
Number of Cells	60 (10×6)
Weight	18.2kg
Dimension	1650×991×35mm
Max Load	5400 Pascals
Junction Box	IP67 rated MC4
Connector	Compatible PV
Wire Type	Wire

## TEMPERATURE CHARACTERISTICS

Temp. Coeff. of Isc (TK Isc)	0.04% /°C
Temp. Coeff. of Voc (TK Voc)	-0.34% /°C
Temp. Coeff. of Pmax (TK Pmax)	-0.44% /°C

## PACKING MANNER

Container	20' GP	40' GP
Pieces per Pallet	30	30
Pieces per Container	392	840

## PHYSICAL CHARACTERISTICS

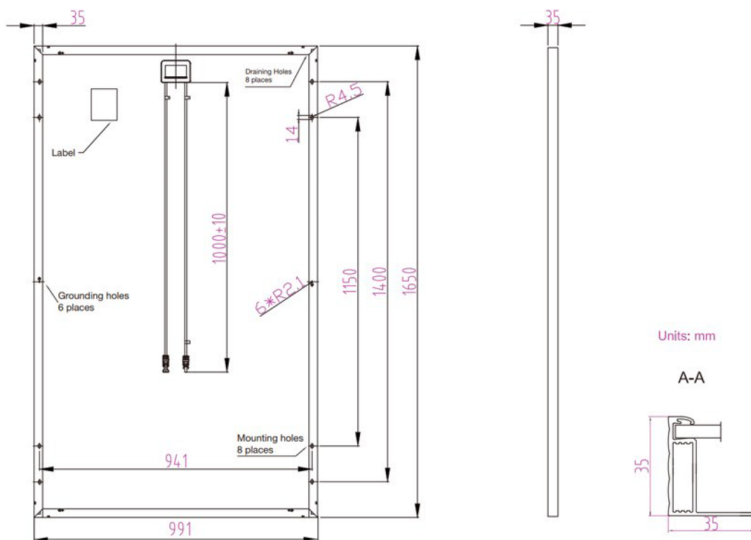

Note: the specifications are obtained under the Standard Test Conditions (STCs): 1000W/m<sup>2</sup> solar irradiance, 1.5 Air Mass, and cell temperature of 25°C. The NOCT is obtained under the Test Conditions: 800W/m<sup>2</sup>, 20°C ambient temperature, 1m/s wind speed, AM 1.5 spectrum.

Please contact support@jusolar.com for technical support. The actual transactions will be subject to the contracts. This parameters is for reference only and it is not a part of the contracts. The specifications are subject to change without prior notice.

## ELECTRICAL CHARACTERISTICS

Current-Voltage & Power-Voltage Curve (AM1.5, Cell Temperature 25°C)

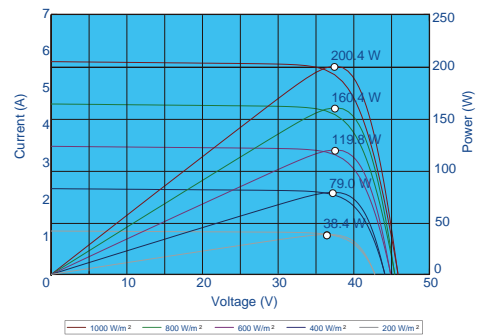

Temperature Dependence of Isc, Voc and Pmax

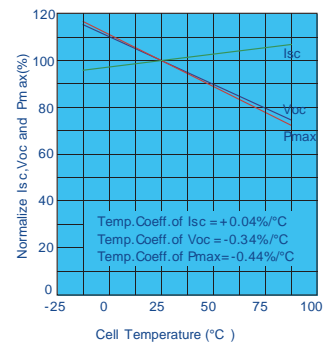

Irradiance Dependence of Isc, Voc and Pmax (Cell Temperature: 25°C)

