

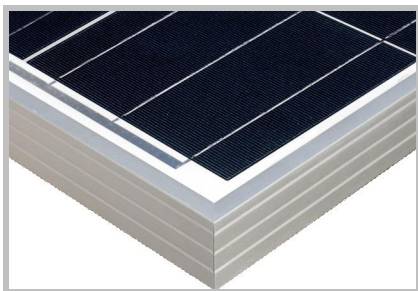

IGNITE THE POWER OF NATURE

Polycrystalline Module 290Watt

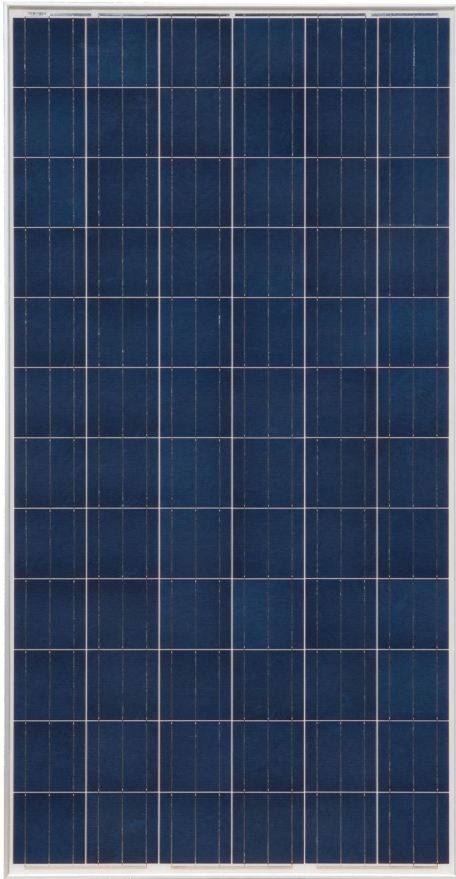

Model (RD290TU-36P) Specifications

Electrical Data

Maximum Power(W)	290
Optimum Power Voltage(Vmp)	37.08
Optimum Operating Current(Imp)	7.82
Open Circuit Voltage(Voc)	44.32
Short Circuit Current(Isc)	8.37
Cell Efficiency (%)	16.88
Module Efficiency (%)	14.95
Tolerance Wattage(%)	0 +3
NOCT	47°C +/-2°C

Temperature Coefficients

Temperature Coefficients of Isc(%)	+0.04
Temperature Coefficients of Voc(%)	-0.35
Temperature Coefficients of Pm(%)	-0.45
Temperature Coefficients of Im(%)	+0.04
Temperature Coefficients of Vm(%)	-0.35

Components & Mechanical Data

Solar Cell	156*156 Poly
Number of Cell(pcs)	6*12
Size of Module(mm)	1956*992*40
Front Glass Thickness(mm)	3.2
Surface Maximum Load Capacity	2400-5400Pa
Allowable Hail Load	23m/s ,7.53g
Weight Per Piece(KG)	22.5
Junction Box Type	Pass the TUV Certificate
Bypass Diode Rating(A)	30
Cable & Connector Type	Pass the TUV Certificate
Frame(Material Corners,etc.)	40#
Temperature Range	-40°C to +85°C
FF (%)	70-76%
Standard Test Conditions	AM1.5 1000W/m ² 25°C

Benefits



Modules sorted by current, optimizing system power generation



High Efficiency



Stable Power



Low Carbon Emission



Excellent Weather Resistance



IGNITE THE POWER OF NATURE

Polycrystalline Module 290Watt

IV-Curves

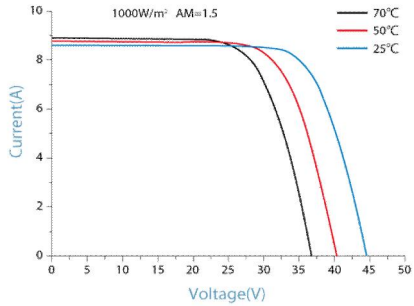

IV-CURVES of PV module
RD290TU-36P

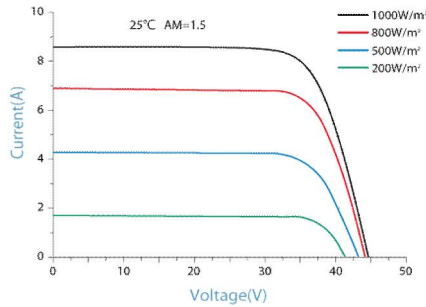

Engineering Drawings

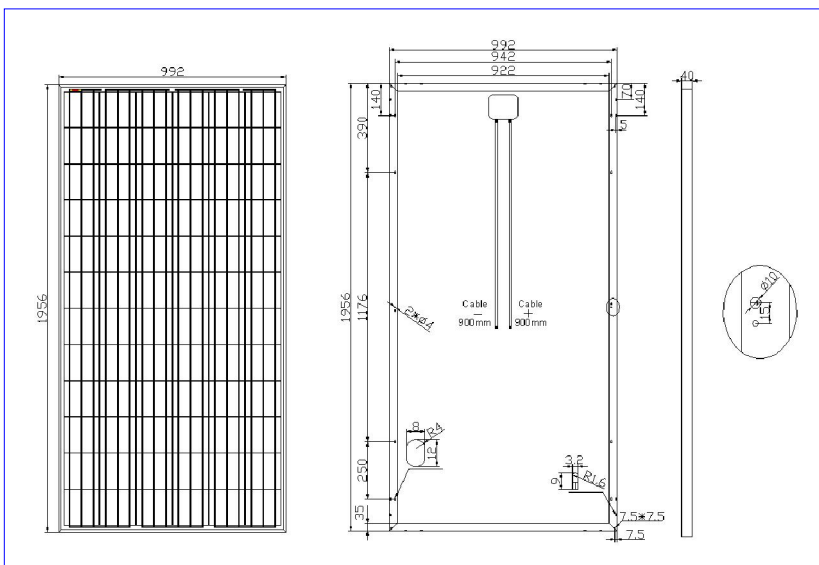

Warranty & Certifications

Warranty	25 years limited power warranty
	10 years limited product warranty
Certifications	IEC 61215, IEC 61730

Packing

Packing	Carton Box
1*20'	12pallets/262pcs
1*40'HQ	24pallets/616pcs

Applications

- ▣ On-grid residential roof-tops
- ▣ On-grid commercial/industrial roof-tops
- ▣ Solar power stations
- ▣ Other on-grid applications

Project Picture



▣ Manufacturing facility certified to **ISO 9001 / ISO 14001 / OHSAS 18001** quality management system standards.

©2016 NINGBO RENELED NEW ENERGY CO.,LTD. All rights reserved.

Specifications included in this datasheet are subject to change without notice.

NINGBO RENELED NEW ENERGY CO.,LTD.

ADD: No. 35 Jintong Road, Binhai Industrial Park,
Xiangshan County, Ningbo, 315700, China

TEL: 0086 (0)574 65893072

FAX: 0086 (0)574 65786317

