

Poly PV Module

Poly



158.75mm

DHP60X 280W-285W

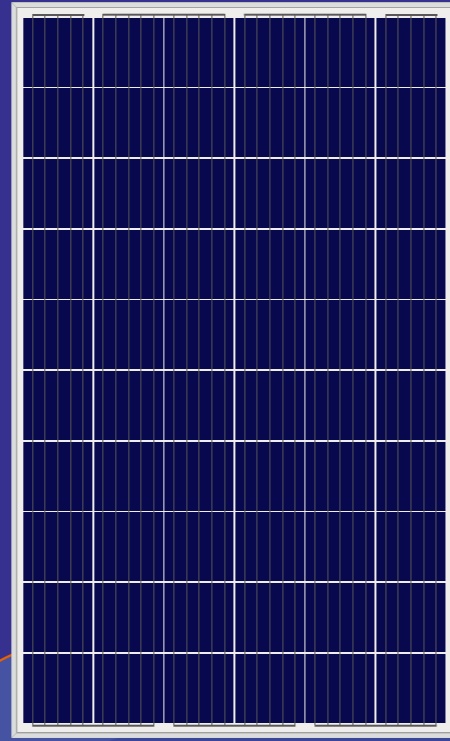

QUALITY GUARANTEE

LINEAR POWER OUTPUT GUARANTEE

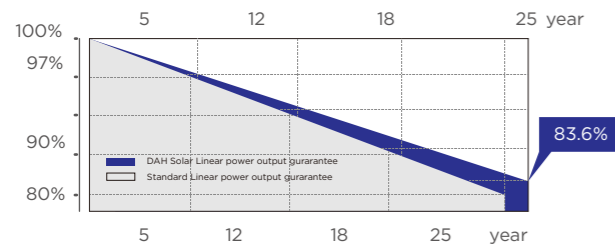

10 years 10-year material & technology warranty

25 years 25-year linear power output warranty

0~+5W

Positive Tolerance

17.08%

Max Module Eff.(%)

PRODUCT PERFORMANCE ADVANTAGE

- Select Grade A crystalline silicon solar cells, high-power output with cost-effective
- Preferred packaging materials and strict process technology, excellent PID free performance
- Certified by dust-sand,salt-mist, ammonia etc. weather resistance tests, strong environmental adaptability
- Larger size of light receiving area, higher solar panel power, lower system cost

Poly PV Module DHP60X 280W-285W

Design

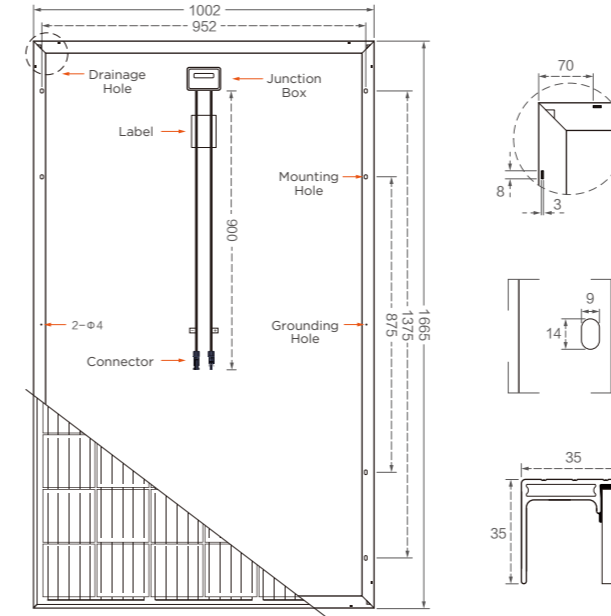

Mechanical Specification

Cells Type	Poly 158.75×158.75mm
Weight	19kg
Dimension (L×W×T)	1665×1002×35mm
Output Cables	Length 900mm, 4.0mm ²
No.of Cells	60(6×10)
Glass	3.2mm High Transmission, Antireflection Coating
Junction box	IP68, 3 Bypass Diodes
Connector	QC4 or MC4 compatible
Packing	30pcs/pallet, 400pcs/20GP, 910pcs/40HQ

Operating Parameters

Maximum system voltage	1000V/1500V DC
Operating Temperature	-40 ~ +85℃
Maximum series fuse rating	16A
Snow load, frontside	5400Pa
Wind load, backside	2400Pa
Nominal operating cell temperature	45℃±2℃
Application level	Class A

Electrical Characteristics(STC)

Module Type	DHP60X-280W-5BB	DHP60X-285W-5BB
Maximum Power (Pmax)	280W	285W
Open-circuit Voltage (Voc)	38.5V	38.7V
Maximum Power Voltage (Vmp)	31.3V	31.5V
Short-circuit Current (Isc)	9.34A	9.64A
Maximum Power Current (Imp)	8.95A	9.05A
Module Efficiency (%)	16.78%	17.08%
Power Tolerance	0~+5W	
Temperature Coefficient of Isc	0.048%/℃	
Temperature Coefficient of Voc	-0.28%/℃	
Temperature Coefficient of Pmax	-0.37%/℃	
Standard Test Environment	Irradiance 1000w/m ² , Cell temperature 25℃, Spectrum AM1.5	

Electrical Characteristics(NOCT)

Module Type	DHP60X-280W-5BB	DHP60X-285W-5BB
Maximum Power (Pmax)	207W	210W
Open-circuit Voltage (Voc)	35.8V	35.9V
Maximum Power Voltage (Vmp)	29.0V	29.1V
Short-circuit Current (Isc)	7.54A	7.68A
Maximum Power Current (Imp)	7.14A	7.22A
Standard Test Environment	Irradiance 800w/m ² , Cell temperature 20℃, Spectrum AM1.5, Wind speed 1m/s	



Top Runner of Smart PV Module

Factory Address: No.358 Tianhe Road, Luyang Industrial Park, Hefei City, Anhui, China
Office Address: Floor 1-3, 6#A, Gongtuo Xinglu Industrial Park, Hefei City, Anhui, China
Email: dhsolar@dh-solar.cn **Tel:** +86-551-65176633



Top Runner of Smart PV Module

Factory Address: No.358 Tianhe Road, Luyang Industrial Park, Hefei City, Anhui, China
Office Address: Floor 1-3, 6#A, Gongtuo Xinglu Industrial Park, Hefei City, Anhui, China
Email: dhsolar@dh-solar.cn **Tel:** +86-551-65176633