

SOLAR MODULE

LNMH120-XXX(350W-370W)

Mono / 9 Busbar / 120 half cells

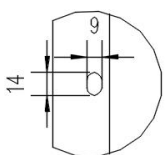
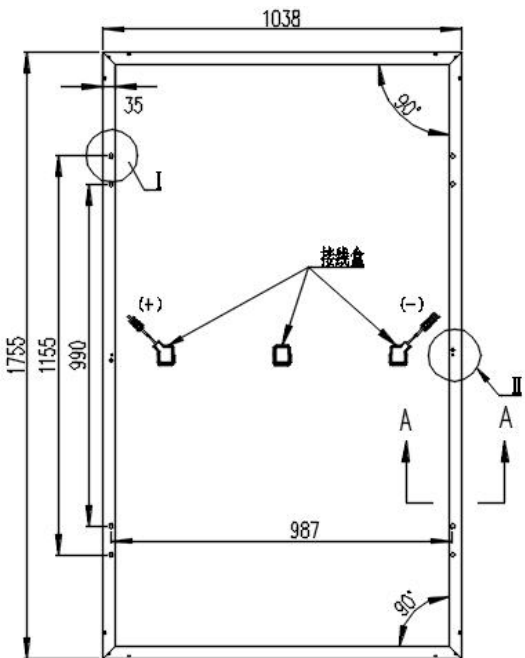
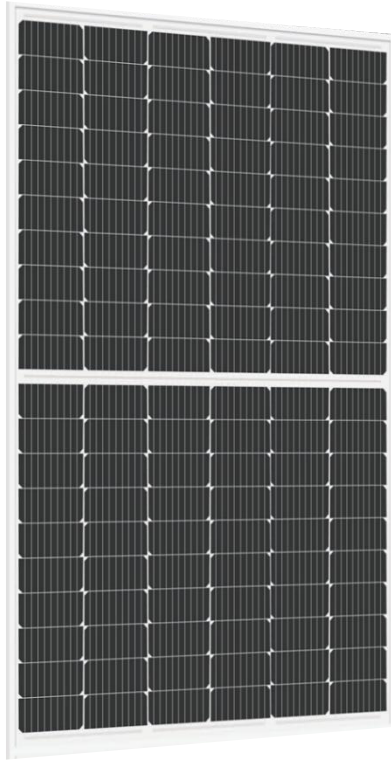

I

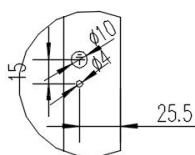

II

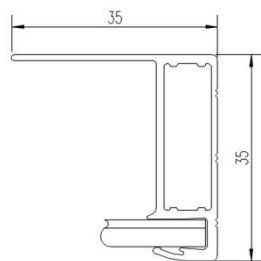

A-A

Unit:mm

Key Features

- Increased MBB (Multi Busbar) reflectance ensure higher power
- Power output: Positive tolerance of up to 5W
- 100%EL 2 times-inspection ensures modules are defect free
- Anti-reflective and self-cleaning surface reduces
- Pass ammonia and salt mist test
- Unique circuit design to reduce shading loss
- Reduced hot spot risk

Comprehensive Certificates

- IEC61215, IEC61730
- TUV, CE
- ISO9001:2015
- ISO14001:2015
- OHSAS 18001:2007

Superior Warranty

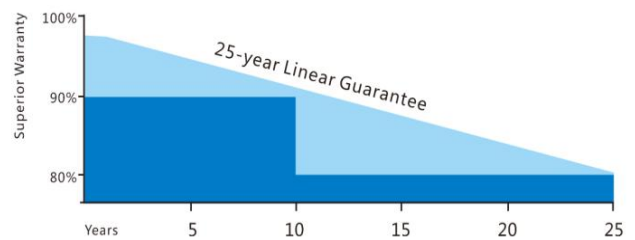

25-year Linear Power Output Warranty

Power output* shall not exceed:

For Mono-crystalline Modules: 3.0 % in the first year, thereafter 0.68% per year, ending with 80.68% in the 25th year after the Warranty Start Date;

For Poly-crystalline Modules: 2.5 % in the first year, thereafter 0.70% per year, ending with 80.7% in the 25th year after the Warranty Start Date.

*measured at STC



SOLAR MODULE

LNMH120-XXX(350W-370W)

Mono / 9 Busbar / 120 half cells

Electrical Parameters@STC

Pmax (W) 0-+5W	Umpp (V)	Impp(A)	Uoc (V) ±3%	Isc(A) ±3%	Module Efficiency	Max System Voltage	Max Series Fuse
350	33.16	10.57	40.30	11.08	19.21%	1500V/1000V	20A
355	33.39	10.65	40.54	11.17	19.49%	1500V/1000V	20A
360	33.63	10.73	40.81	11.25	19.76%	1500V/1000V	20A
365	33.87	10.79	41.09	11.32	20.04%	1500V/1000V	20A
370	34.08	10.88	41.31	11.41	20.31%	1500V/1000V	20A

Temperature Parameter

Temperature Cycling Range:	-40°C ~ +85°C
Norminal Module Operating Temperature:	42±2 °C
Temperature Coefficient of Isc:	0.059%/°C
Temperature Coefficient of Voc :	-0.288 %/°C
Temperature Coefficient of Pmax :	-0.381%/°C

Mechanical Data

Module Dimension:	1755×1038×35mm
Weight:	20 kg
Snow/Wind Load:	5400/2400 Pa
Number of Cells:	120pcs
Thickness of Glass:	3.2mm
Junction Box:	IP68, 3 Diodes
Connector:	HTC-16, IP68

Guarantee

10-year warranty on materials & workmanship
 25-year linear power output warranty

Packaging Configuration

Modules Per Pallet:	31pcs
Modules Per 40' HQ:	806pcs

360W Mono Module I-V Curve

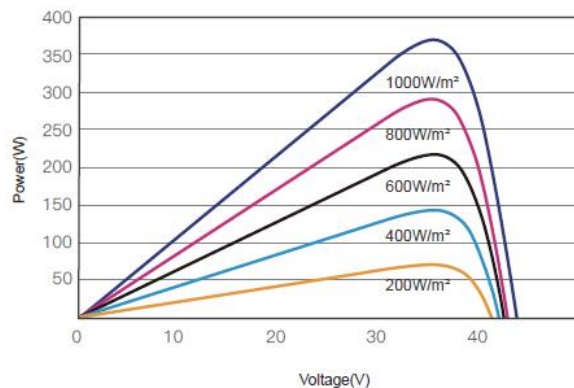
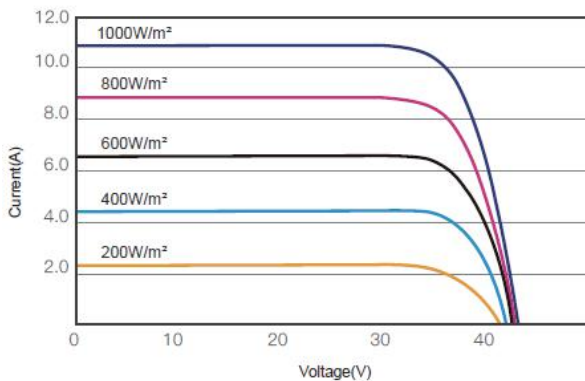

STC: Irradiance 1000W/m² Temperature 25°C AM=1.5
 NMOT: Irradiance 800W/m² Temperature 20°C Wind Speed 1m/s

Specifications subject to technical changes and tests, Linuo Power reserves the right of final interpretation.

To create value to customers