

LN300(36)P-5-XXX(320W-345W)

Poly / 5 Busbar / 72pcs

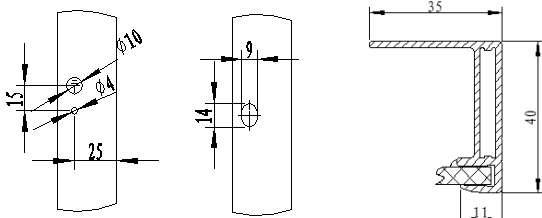
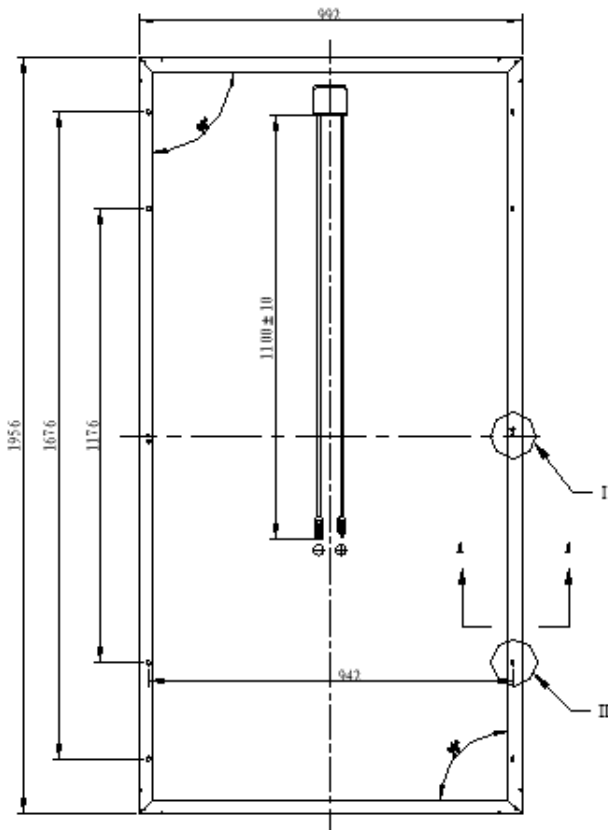
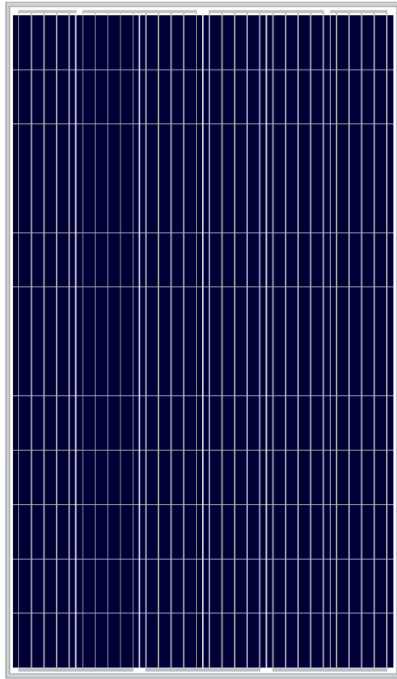

### Key Features

- Power output: Positive tolerance of up to 5W
- 100%EL 2 times-inspection ensures modules are defect free
- Anti-reflective and self-cleaning surface reduces power loss from dirt and dust
- Certified to withstand increased snow loads of up to 5400Pa and wind loads of up to 2400Pa
- High performance and power output in low solar irradiation

### Comprehensive Certificates

- IEC61215, IEC61730, UL1703,
- TUV, UL, JET, INMETRO, CE, IEC
- ISO9001:2015
- ISO14001:2015
- OHSAS 18001:2007

### Superior Warranty

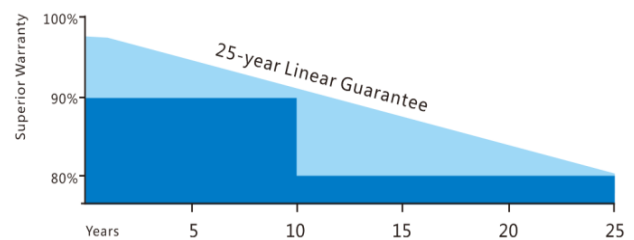

#### 25-year Linear Power Output Warranty

Power output\* shall not exceed:

For Mono-crystalline Modules: 3.0 % in the first year, thereafter 0.68% per year, ending with 80.68% in the 25th year after the Warranty Start Date;

For Poly-crystalline Modules: 2.5 % in the first year, thereafter 0.70% per year, ending with 80.7% in the 25th year after the Warranty Start Date.

\*measured at STC

## LN300(36)P-5-XXX(320W-345W)

Poly / 5 Busbar / 72pcs

### Electrical Parameters@STC

Pmax (W) 0-+5W	Umpp (V)	Impp(A)	Uoc (V) ±3%	Isc(A) ±3%	FF	Module Efficiency	Max System Voltage	Max Series Fuse
320	37.65	8.5	45.17	9.15	77.43%	16.49%	1000V	15A
325	37.88	8.58	45.3	9.25	77.56%	16.75%	1000V	15A
330	38.02	8.68	45.52	9.36	77.46%	17.01%	1000V	15A
335	38.25	8.76	45.7	9.46	77.51%	17.26%	1000V	15A
340	38.38	8.86	45.81	9.55	77.73%	17.52%	1000V	15A
345	38.55	8.95	45.99	9.64	77.82%	17.78%	1000V	15A

### Temperature Parameter

Temperature Cycling Range:	-40°C ~ +85°C
Norminal Module Operating Temperature:	42±2 °C
Temperature Coefficient of Isc:	0.0629%/°C
Temperature Coefficient of Voc :	-0.3462%/°C
Temperature Coefficient of Pmax :	-0.4494%/°C

### Mechanical Data

Module Dimension:	1956×992×40mm
Weight:	23.5kg
Snow/Wind Load:	5400/2400 Pa
Number of Cells:	72pcs
Thickness of Glass:	3.2mm
Junction Box:	IP68, 3 Diodes
Connector:	HTC-16, IP68

### Guarantee

10-year warranty on materials & workmanship  
 25-year linear power output warranty

### Packaging Configuration

Modules Per Pallet:	27pcs
Modules Per 40 ' HQ:	648pcs

### 325W Poly Module I-V Curve

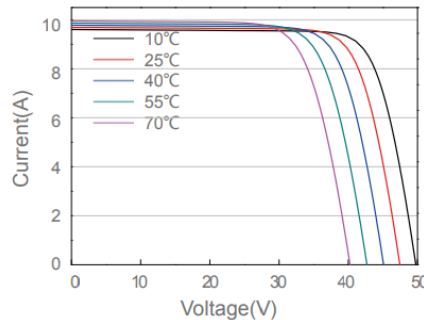
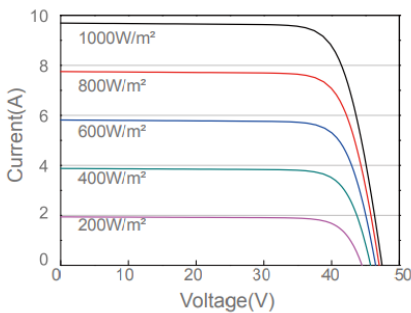

STC: Irradiance 1000W/m<sup>2</sup> Temperature 25°C AM=1.5  
 NMOT: Irradiance 800W/m<sup>2</sup> Temperature 20°C Wind Speed 1m/s



Specifications subject to technical changes and tests, Linuo Power reserves the right of final interpretation.