

## SOLESOLAR SM150W

 0/+5 WP POSITIVE TOLERANCE

 ROOFTOP AND OFF-GRID DESIGN

 HIGH QUALITY

25 year linear performance warranty  
10 year product warranty

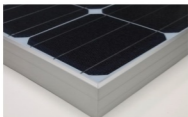

The high voltage solar panels  
designed for solar pumping



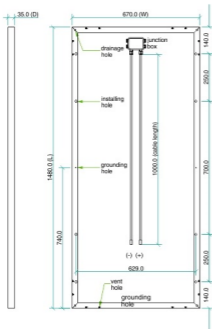

## General characteristics

Cell	monocrystalline solar cell 156 x 156 mm
No. of Cells (Connections)	36 (4 x 9)
Panel Dimensions	1480 x 670 x 35 mm
Weight	11.6 kg
Connectors and Cables	Connectors and 1m cables

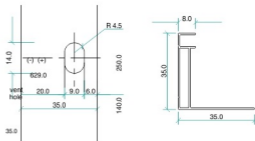

## Thermal conditions

Normal Operating Cell Temperature  
800W/m<sup>2</sup> irradiance, 20°C, AM = 1.5

48°C ± 2°C

Power temperature coefficient

- 0.5%/K

Current temperature coefficient

0.035%/K

Voltage temperature coefficient

- 0.37 mV/K

## Limits

Operating temperature

-40°C to +85°C

Maximum system voltage

1000V DC

## Electric performance at STC \*

Maximum Power

120 W

Power tolerance

0/+5 W<sub>p</sub>

Maximum power voltage

36 V

Maximum power current

3.33 A

Open circuit voltage

44.8 V

Short circuit current

3.92 A

Standard Test Conditions : 1000W/m<sup>2</sup> irradiance, 25°C and AM = 1.5

## High performance

**25** 25 Years  
linear performance

**10** 10 Years  
product warranty

