



PV3000 MPK Series Low Frequency Solar Inverter

Feature:

- Rated power 1kw to 6kw
- Pure sine wave output
- Powerful charge rate up to 70Amp
- Built-in MPPT solar charge controller 40A/60A
- MPPT efficiency max 98%
- Built-in pure copper transformer
- Built-in pure copper UI transformer
- DIP Switch offer customized performance
- High Efficiency Design & "Power Saving Mode" to Conserve Energy
- Supporting RS232 communication, AGS, BTS port
- Remote control panel (optional)
- Compatible to generator

Introduction:

This is a multi-function inverter, combining functions of inverter and mppt solar charger controller, solar charger and battery charger to offer uninterruptible power support with portable size. The comprehensive LCD display offers user-configurable and easy-accessible button operation such as battery charging current, AC/solar charger priority, and selectable input voltage based on different applications.

LCD Display Information

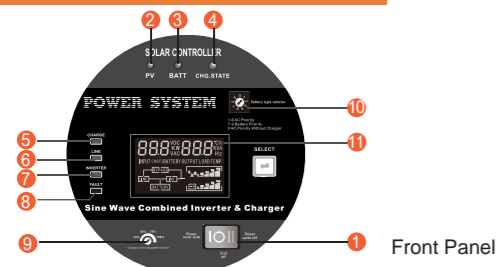

1. Switch	Power saver auto: Power on with saver mode(power saver \leq 25W)
	Unit off: Power totally off(If there is AC power, inverter have charger function)
	Power saver off: Power on without saver mode

- | | |
|---------------------------|--|
| 2. PV voltage normal | 8. check inverter |
| 3. Battery voltage normal | 9. Charge current adjustable:25%,50%,75%,100% (Optional) |
| 4. Charging | 10. Battery type selector |
| 5. AC Charge | 11. LCD display |
| 6. AC power on | |
| 7. inverter mode | |

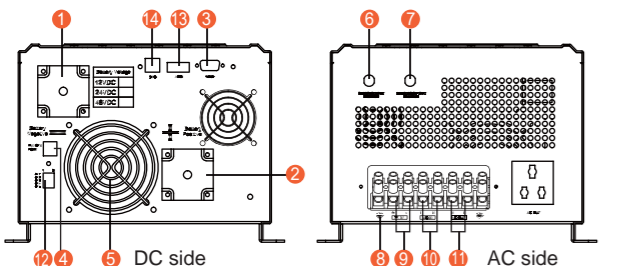

- | | |
|-----------------------------|------------------------------|
| 1. BAT ⁻ | 8. GND |
| 2. BAT ⁺ | 9. PV1 input |
| 3. RS232 communication port | 10. AC input |
| 4. Remote port | 11. AC output |
| 5. FAN | 12. Function switch(SW1~SW5) |
| 6. AC input/Bypass breaker | 13. AGS |
| 7. AC output breaker | 14. BTS |

Solar System Connection



Back Panel



Specification

MODEL	PV30-1KW MPK	PV30-1.5KW MPK	PV30-2KW MPK	PV30-3KW MPK	PV30-4KW MPK	PV30-5KW MPK	PV30-6KW MPK								
Nominal Battery System Voltage	12VDC 24VDC	12VDC 24VDC	12VDC 24VDC	12VDC 24VDC	24VDC/48VDC	24VDC/48VDC	24VDC/48VDC								
INVERTER OUTPUT	Rated Power	1KW	1.5KW	2KW	3KW	4KW	5KW 6KW								
	Surge Rating (20ms)	3KW	4.5KW	6KW	9KW	12KW	15KW 18KW								
	Capable Of Starting Electric Motor	1HP	1HP	1HP	2HP	2HP	3HP 3HP								
	Waveform	Pure sine wave/ same as input (bypass mode)				Pure sine wave/ same as input (bypass mode)									
	Nominal Output Voltage RMS	100V/110V/120VAC 220V/230V/240VAC(+/-10% RMS)				100V/110V/120VAC 220V/230V/240VAC									
	Output Frequency	50Hz/60Hz +/-0.3 Hz				50Hz/60Hz +/-0.3 Hz									
	Inverter Efficiency(Peak)	>88%				>88%									
	Line Mode Efficiency	>95%				>95%									
AC INPUT	Power Factor	0.8				1.0									
	Typical Transfer Time	10ms(max)				10ms(max)									
AC INPUT	Voltage	230VAC				230VAC									
	Selectable Voltage Range	96~132VAC 155~280VAC(For Personal Computers)				96~132VAC/155~280VAC(For Personal Computers)									
BATTERY	Frequency Range	50Hz/60Hz (Auto sensing) 40-80Hz				50Hz/60Hz (Auto sensing) 40-80Hz									
	Minimum Start Voltage	10.0VDC /10.5VDC for12VDC mode (*2 for 24VDC,)				20.0VDC~21.0VDC /40.0VDC~42.0VDC									
	Low Battery Alarm	10.5VDC +/-0.3V for12VDC mode (*2 for 24VDC,)				21.0VDC +/-0.6V /42.0VDC +/-1.2V									
	Low Battery Cutoff	10.0VDC +/-0.3V for12VDC mode (*2 for 24VDC,)				20.0VDC +/-0.6V /40.0VDC +/-1.2V									
	High Voltage Alarm	16.0VDC +/-0.3V for12VDC mode (*2 for 24VDC,)				32.0VDC +/-0.6V /64.0VDC +/-1.2V									
	High Battery Voltage Recover	15.5VDC +/-0.3V for12VDC mode (*2 for 24VDC,)				31.0VDC +/-0.6V /62.0VDC +/-1.2V									
	Idle Consumption-Search Mode	<25W when power saver on				<50W when power saver on									
AC CHARGER	Output Voltage	Depends on battery type				Depends on battery type									
	Charger AC Input Breaker Rating	10A	30A	30A	30A	40A									
	Overcharge Protection S.D.	15.7VDC for 12VDC mode (*2 for 24VDC,)				31.4VDC/62.8VDC									
	Maximum Charge Current	35A	20A	45A	25A	65A	35A	75A	45A	65A	35A	70A	40A	75A	50A
BYPASS & PROTECTION	Input Voltage Waveform	Sine wave (grid or generator)				Sine wave (grid or generator)									
	Nominal Input Frequency	50Hz or 60Hz				50Hz or 60Hz									
	Overload Protection (SMPS Load)	Circuit breaker				Circuit breaker									
	Output Short Circuit Protection	Circuit breaker				Circuit breaker									
	Bypass Breaker Rating	10A	15A	30A	30A	40A									
	Max Bypass Current	30Amp				40Amp									
SOLAR CHARGER	Maximum PV Array Power	600W	1200W	600W	1200W	600W	1200W	600W	1200W	1600W	3200W	1600W	3200W	1600W	3200W
	Maximum PV Charge Current	40A				60A									
	DC Voltage	12V/24V atuo work				24V/48V atuo work									
	MPPT Range @ Operating Voltage	16~100VDC				32~145VDC @ 24V / 64~145VDC @ 48V									
	Maximum PV Array Open Circuit Voltage	100VDC				145VDC									
	Maximum Efficiency	>90%				>98%									
	Standby Power Consumption	<2W				<2W									
MECHANICAL SPECIFICATIONS	Mounting	Wall mount				Wall mount									
	Dimensions (W*H*D)	423*247*197mm				597x247x197mm									
	Net Weight (Solar CHG) kg	18.5	18.4	19.5	19.4	23.5	32.2	28.7	27	41.3	39.4	50.4	48.8	51.8	49.2
	Shipping Dimensions(W*H*D)	570*355*300mm				743*372*312mm									
	Shipping Weight (Solar CHG) kg	21.5	21.4	22.4	22.5	25.8	25.6	31.2	29.6	44.7	42.8	54	52.4	55.7	53.1
OTHER	Operation Temperature Range	0°C to 40°C				0°C to 40°C									
	Storage Temperature	-15°C to 60°C				-15°C to 60°C									
	Audible Noise	60dB MAX				60dB MAX									
	Display	LED+LCD				LED+LCD									
Loading(20GP/40GP/40HQ)	460pcs / 920pcs / 1060pcs				320pcs / 640pcs / 750pcs										

* Product specifications are subject to change without further notice.

Approximate Back-up Time Table

Power Rate(w)	backup time(H) @1*100Ah	backup time(H) @2*100Ah	backup time(H) @4*100Ah	backup time(H) @4*200Ah	backup time(H) @8*200Ah
1000	0.4806	1.602	3.50304	7.6896	
2000	0.2136	0.4806	1.602	3.50304	7.6896
3000	0.1068	0.2848	0.8544	2.136	4.8416
4000		0.2136	0.4806	1.602	3.50304
5000		0.12816	0.34176	1.19616	2.73408
6000		0.1068	0.2848	0.8544	2.136