

EnluxSolar EL-300 micro inverter brings high performance with simplest installation.

It has maximum 300w AC output, higher peak efficiency at 96.5 %, and wider voltage range to accommodate with both 60 and 72 cell PV modules.

EnluxSolar EL-300 integrates with EL-X Communication Gateway and Envision Monitoring Website, offering a complete, user-friendly solution that creates better user experience.



# EL-300 Micro inverter US Data



## DC Input Data

Recommended max. input power	<b>350W</b>
Peak power tracking range	<b>25-50V</b>
Operating range	<b>22-59V</b>
Max. DC short circuit current	<b>15A</b>

## AC Output Data

Max. output power	<b>300W</b>
Nominal output current	<b>1.25A</b>
Nominal/extended voltage range	<b>240V/211 - 264V</b>
Nominal/extended frequency range	<b>60.0/59.3 - 60.5</b>
Power factor	<b>&gt;0.99</b>
Total harmonic distortion	<b>&lt;3%</b>
Max. units per 20A branch circuit	<b>12pcs</b>

## Efficiency

CEC weighted efficiency	<b>96.0%</b>
Peak inverter efficiency	<b>96.5%</b>
Static MPPT efficiency	<b>99.8%</b>
Night time power consumption	<b>30 mW</b>

## Mechanical Data

Ambient temperature range	<b>'-40°C to +85°C</b>
Dimensions (WxHxD)	<b>25.8cm x 21.3cm x 3.4cm (with bracket)</b>
Weight	<b>1.4 kg</b>
Cooling	<b>Natural convection - no fans</b>
DC connector type	<b>MC4</b>
Enclosure environmental rating	<b>IP65</b>

## Features

Communication	<b>Power line</b>
Compliance	<b>UL1741/IEEE1547, FCC Part 15 Class B</b>

# EL-X Communication Gateway US Data

EL-X Communication Gateway is the data collector that designed for EnluxSolar micro inverter system. Plug & play installation. Utilizing existing power line to communicate, avoiding the trouble of extra wirings.

Users can check each micro inverter's power output by the LCD displayor via Envision monitoring website to access more detailed information, including the status of each micro inverter, current and historical performance data, etc.



## Communication Interface Technical Data

Power line	Narrowband PLC 7.5kbps
Ethernet	10/100BEST-T / IEEE 802.3TM
DHCP client service	YES

## Mechanical Data

Outside dimension (WxHxD)	174 mm x 111.8 mm x 36.7mm
Weight	300g
Max. operation altitudes	Sea level 3000 m
Operating temperature	-10°C to +65°C
Cooling	Natural convection - no fans
Enclosure environment rating	Indoor - NEMA 1

## Safety and Standard

Compliance	IEC 60950, FCC Part 15 class B
	EN55022, EN55024, VCCI
	EN61000-3-2, EN61000-3-3

## AC Input Power Requirements Technical Data

Min. input	90 (Vrms)
Max. input	264 (Vrms)
Nominal input	100-240 (Vrms)1.4 kg
Min. input frequency	47 (Hz)
Max. input frequency	62 (Hz)
Nominal input frequency	50-60 (Hz)
Max. input power	6W

## Display

Two columns LCD display with backlight	Yes
--	-----

## Warranty and Capacity

Warranty period	2 year
Number of micro inverters supported	Up to 150pcs

# Accessories for EnluxSolar System

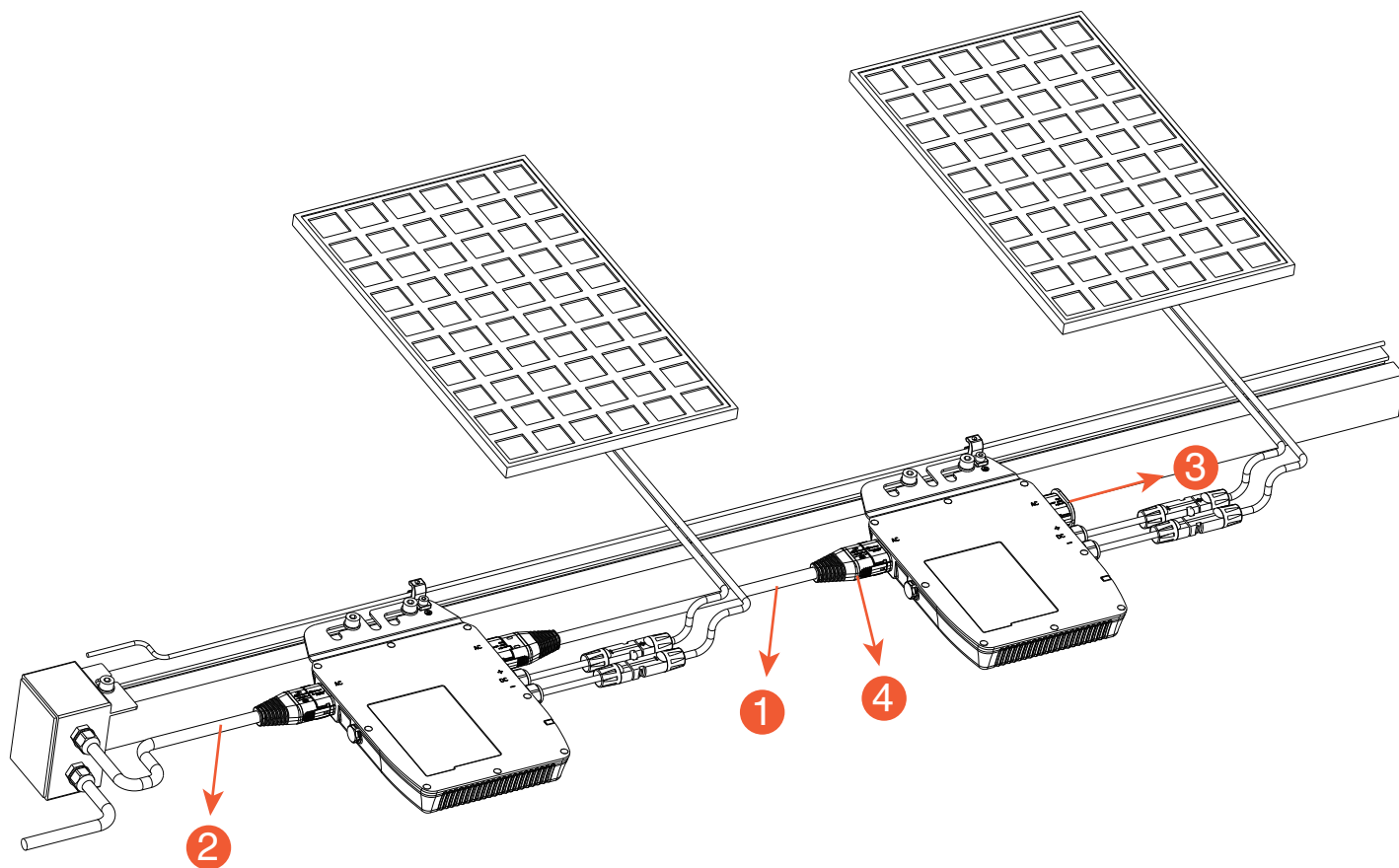

- 1 AC Cable**    Standard    1.2M  
                  Extension    2M  
                  Extension    3M

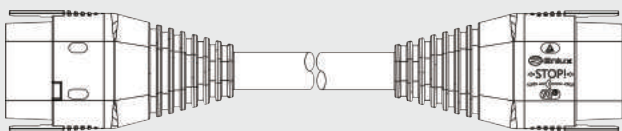

- 2 AC Grid Cable**    Standard 30CM

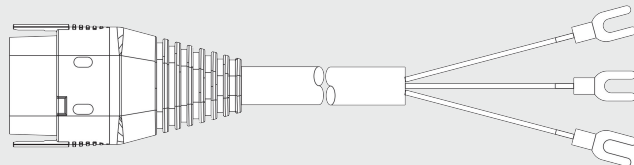

- 3 End Cap**

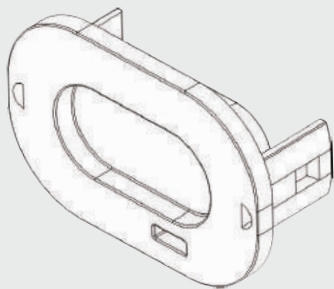

- 4 DC/AC Disconnection Tool**

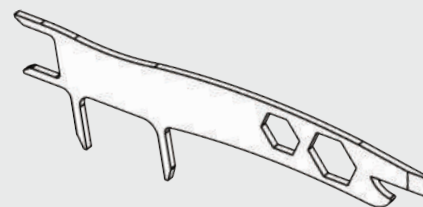

Note: 1. Each micro inverter is equipped with a standard 1.2M AC cable. Other accessories are optional and needed to be purchased additionally.

2. Two AC cables can't directly connect to each other. If the modules are installed in landscape mode, or the distance between micro inverters are longer, it may require 2M or 3M AC cable instead of 1.2M standard AC cable.

3. The AC grid cable is a connector with 30 CM 3-core PV cable. Installers can extend it by adding a longer AC cable.