

# 6 OPzV600

## NON-SPILLABLE RECHARGEABLE SEALED LEAD ACID BATTERY

### ■ DIMENSION

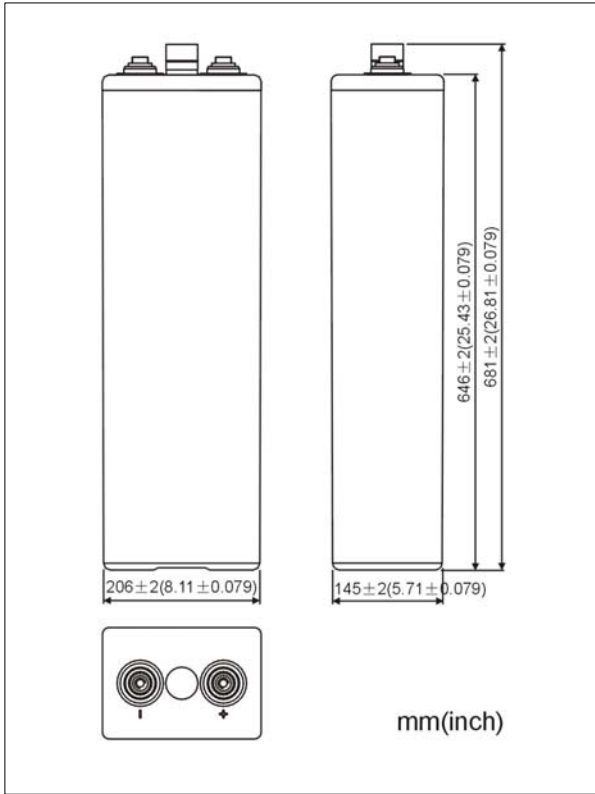

### ■ FEATURES

- Sealed and Non-Spillable construction design;
- Safety valve installation for explosion proof;
- ABS containers and covers (UL94 V0, optional);
- Maintenance free operation;
- Lowest self-discharge characteristic;
- High quality and high reliability;
- Super long service life.

### ■ TERMINAL

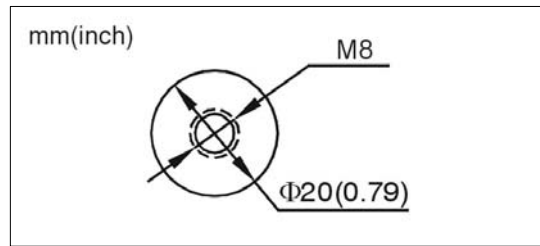

### ■ SPECIFICATIONS

Nominal Voltage	2V	Nominal Capacity (C <sub>10</sub> )	600Ah (1.80V @ 20°C)	
Dimension	Length 145mm	Weight	Approx. 44.2 kg	
	Width 206mm	Max Charging Current	120A	
	Height 646mm	Internal Resistance	Full charged@20°C: 0.00055 Ohm	
	Total Height 681mm	Self Discharge	2% of capacity declined per month@20°C	
Capacity Affected by Temp. (10HR)	40°C	20°C	0°C	-15°C
	109%	100%	85%	65%

### ■ CHARGE

Using Mode	Cycle use	Float use
Charge Voltage (20°C)	2.35~2.40V(-5mV/°C)	2.25~2.29V(-3mV/°C)



# 6 OPzV600

## NON-SPILLABLE RECHARGEABLE SEALED LEAD ACID BATTERY

### ■ CONSTANT CURRENT DISCHARGE CHARACTERISTICS

UNIT: A (20°C)

F.V/Time	15min	30min	1h	2h	3h	5h	8h	10h	20h
1.70V	636	516	351	242	159	107	73.5	62.0	33.5
1.75V	564	468	336	208	156	106	73.2	61.0	32.9
1.80V	492	420	312	199	150	104	72.0	60.0	32.5
1.83V	444	378	288	192	146	102	70.5	58.5	31.6
1.87V	390	330	258	177	137	97.5	67.2	56.0	30.2
1.90V	340	294	234	165	129	92.5	64.5	53.5	28.9

### ■ CONSTANT POWER DISCHARGE CHARACTERISTICS

UNIT: W/CELL (20°C)

F.V/Time	15min	30min	1h	2h	3h	5h	8h	10h	20h
1.70V	1096	894	637	459	322	219	146	122	65.0
1.75V	1009	857	610	396	311	215	143	118	64.5
1.80V	895	805	584	385	302	213	141	115	64.0
1.83V	822	690	537	370	296	202	134	113	63.5
1.87V	800	654	524	360	280	199	130	110	62.0
1.90V	702	599	477	350	265	195	125	104	69.0

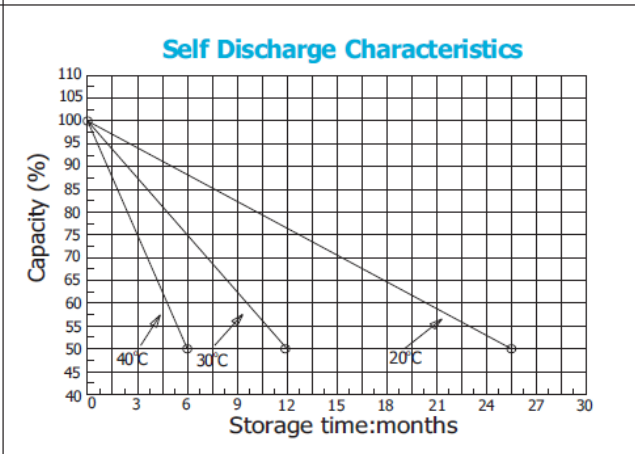
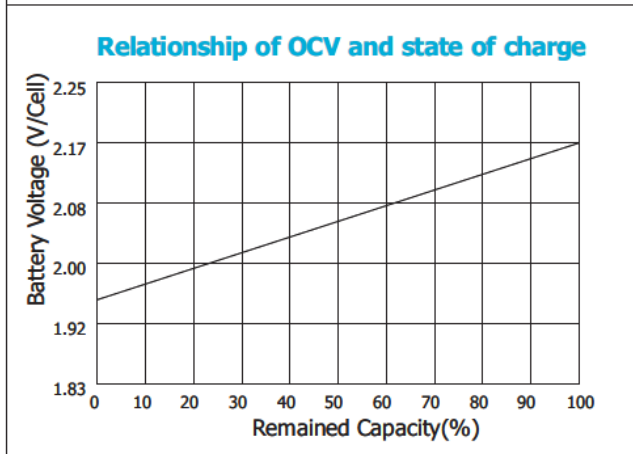
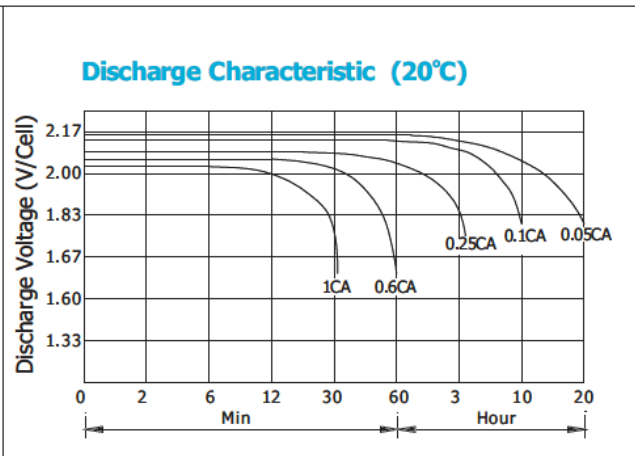
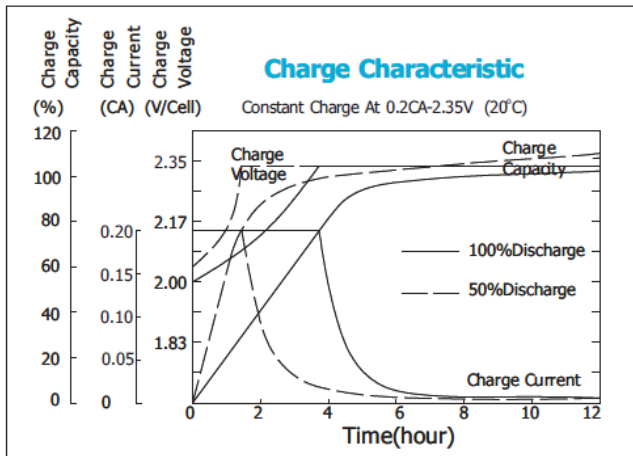

Issue: SC-6 OPzV600-001-CGB-201604. For the improvement of products and technology, and the appearance of the specifications are subject to change without prior notice. The company has the right of final interpretation.

Add: No.172, Checheng Road, Wuhan Economic & Technology Development Zone, Wuhan, China, 430056.  
Tel: (86)27-8489 1318 Fax: (86)27-8489 1924 E-mail: sales@cgbbattery.com