

# 5 OPzV250

## NON-SPILLABLE RECHARGEABLE SEALED LEAD ACID BATTERY

### ■ DIMENSION

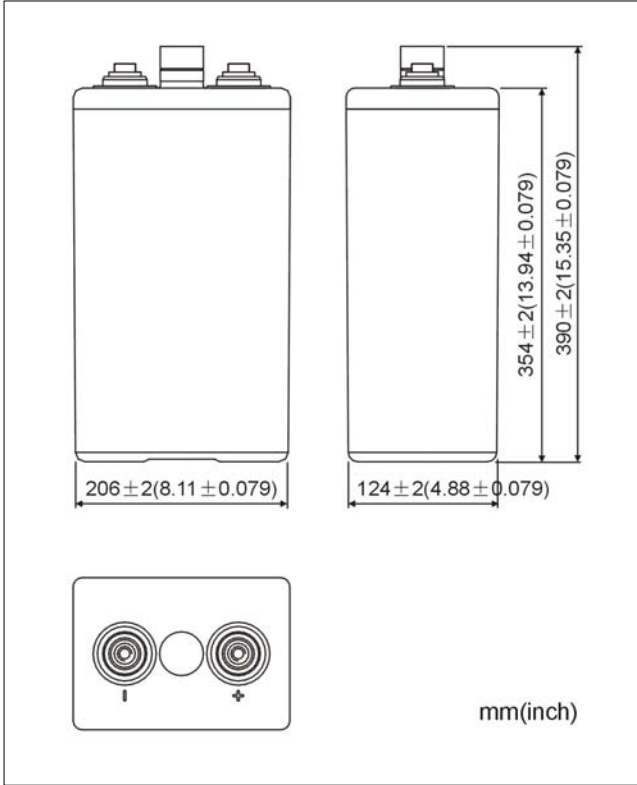

### ■ FEATURES

- Sealed and Non-Spillable construction design;
- Safety valve installation for explosion proof;
- ABS containers and covers (UL94 V0, optional);
- Maintenance free operation;
- Lowest self-discharge characteristic;
- High quality and high reliability;
- Super long service life.

### ■ TERMINAL

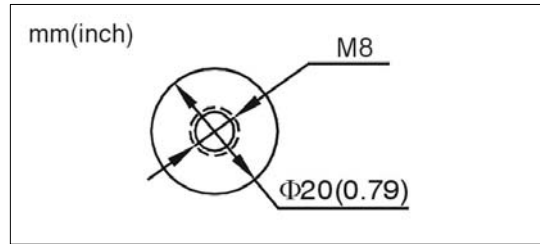

### ■ SPECIFICATIONS

Nominal Voltage	2V	Nominal Capacity (C <sub>10</sub> )	250Ah (1.80V @ 20°C)	
Dimension	Length 124mm	Weight	Approx. 20.3 kg	
	Width 206mm	Max Charging Current	50A	
	Height 354mm	Internal Resistance	Full charged@20°C: 0.00076 Ohm	
	Total Height 390mm	Self Discharge	2% of capacity declined per month@20°C	
Capacity Affected by Temp. (10HR)	40°C	20°C	0°C	-15°C
	109%	100%	85%	65%

### ■ CHARGE

Using Mode	Cycle use	Float use
Charge Voltage (20°C)	2.35~2.40V(-5mV/°C)	2.25~2.29V(-3mV/°C)



# 5 OPzV250

## NON-SPILLABLE RECHARGEABLE SEALED LEAD ACID BATTERY

### ■ CONSTANT CURRENT DISCHARGE CHARACTERISTICS

UNIT: A (20°C)

F.V/Time	15min	30min	1h	2h	3h	5h	8h	10h	20h
1.70V	312	215	138	83.5	62.5	42.5	30.5	26.0	14.0
1.75V	284	206	135	82.0	61.5	42.0	30.0	25.5	13.8
1.80V	253	192	128	79.5	60.0	41.5	29.0	25.0	13.5
1.83V	232	182	123	77.5	58.5	41.0	29.0	24.0	13.0
1.87V	204	165	114	73.0	56.0	39.0	27.0	23.0	12.4
1.90V	184	150	106	69.0	53.0	38.0	26.0	22.0	11.9

### ■ CONSTANT POWER DISCHARGE CHARACTERISTICS

UNIT: W/CELL (20°C)

F.V/Time	15min	30min	1h	2h	3h	5h	8h	10h	20h
1.70V	521	369	290	152	125	93.8	65.1	53.7	29.0
1.75V	457	362	258	147	123	91.0	63.2	51.7	27.9
1.80V	425	355	244	149	118	88.9	60.7	50.0	27.0
1.83V	389	329	232	148	122	87.0	60.3	47.6	25.7
1.87V	363	307	228	146	120	86.3	56.5	46.5	25.1
1.90V	344	276	217	142	118	85.2	56.3	45.7	24.7

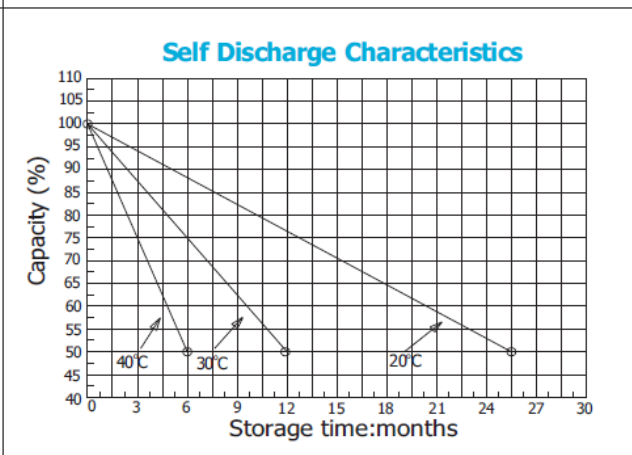
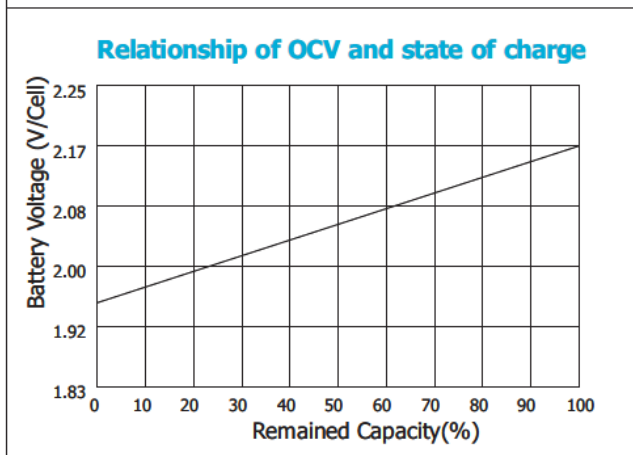
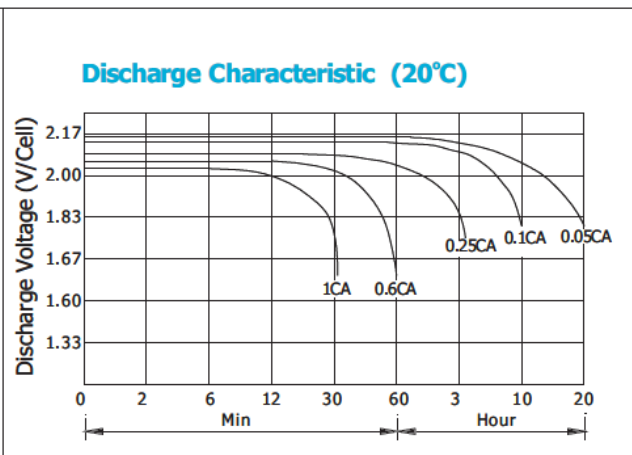
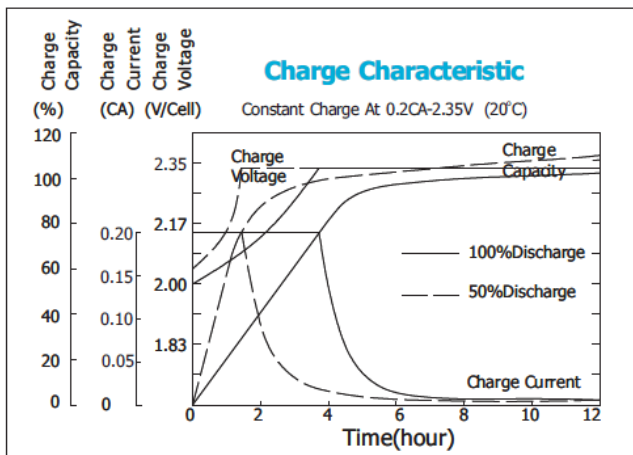

Add: No.172, Checheng Road, Wuhan Economic & Technology Development Zone, Wuhan, China, 430056.  
Tel: (86)27-8489 1318 Fax: (86)27-8489 1924 E-mail: sales@cgbbattery.com