

# 8 OPzS800

## NON-SPILLABLE RECHARGEABLE SEALED LEAD ACID BATTERY

### ■ DIMENSION

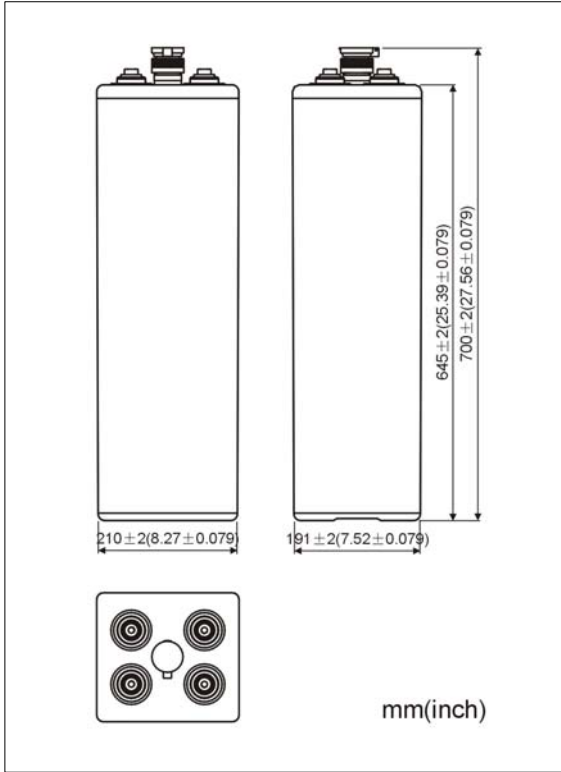

### ■ FEATURES

- Transparent containers;
- Special filter installation for acid fog proof;
- Special pole sealed technology;
- Maintenance convenient;
- High quality and high reliability;
- Super long service life.

### ■ TERMINAL

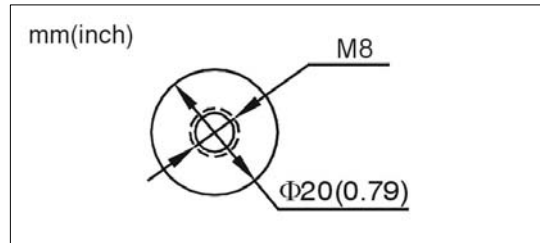

### ■ SPECIFICATIONS

Nominal Voltage	2V	Nominal Capacity (C <sub>10</sub> )	800Ah (1.80V @ 20°C)	
Dimension	Length 191mm	Approx. Weight	Without electrolyte:42kg /with electrolyte:58kg	
	Width 210mm	Max Charging Current	160A	
	Height 645mm	Internal Resistance	Full charged@20°C: 0.0006 Ohm	
	Total Height 700mm	Self Discharge	3% of capacity declined per month@20°C	
Capacity Affected by Temp. (10HR)	40°C	20°C	0°C	-15°C
	109%	100%	85%	65%

### ■ CHARGE

Using Mode	Cycle use	Float use
Charge Voltage (20°C)	2.35~2.40V(-5mV/°C)	2.21~2.25V(-3mV/°C)

# 8 OPzS800

## NON-SPILLABLE RECHARGEABLE SEALED LEAD ACID BATTERY

### ■ CONSTANT CURRENT DISCHARGE CHARACTERISTICS (20°C)

TIME	1h	3h	5h	10h	24h	48h	72h	100h	120h	240h
CUT-OFF VOLTAGE	1.80	1.80	1.80	1.80	1.80	1.80	1.80	1.80	1.80	1.80
CAPACITY(Ah)	416	600	688	800	920	1000	1064	1120	1136	1152

### ■ CONSTANT POWER DISCHARGE CHARACTERISTICS (20°C)

TIME	1h	3h	5h	10h	24h	48h	72h	100h	120h	240h
CUT-OFF VOLTAGE	1.80	1.80	1.80	1.80	1.80	1.80	1.80	1.80	1.80	1.80
CAPACITY(Wh)	770	1110	1273	1480	1702	1850	1968	2072	2102	2131

