

5 OPzS250

NON-SPILLABLE RECHARGEABLE SEALED LEAD ACID BATTERY

■ DIMENSION

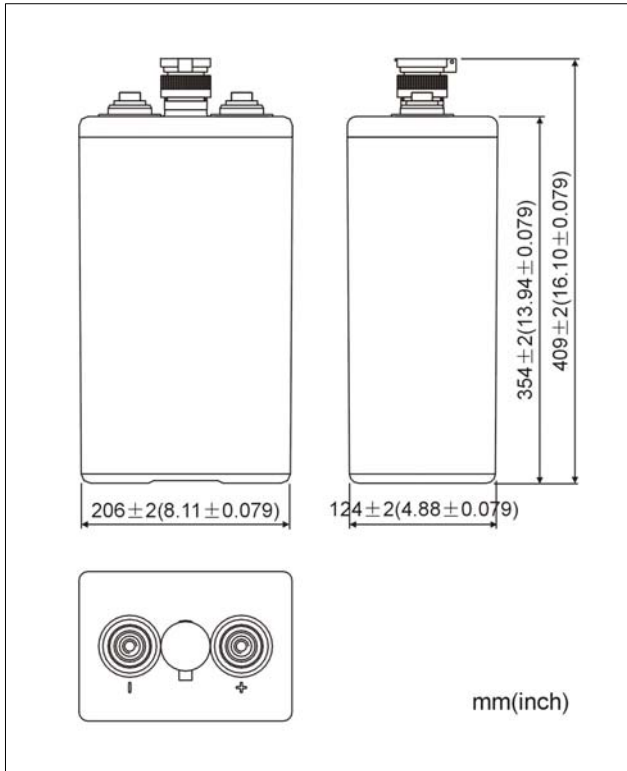

■ FEATURES

- Transparent containers;
- Special filter installation for acid fog proof;
- Special pole sealed technology;
- Maintenance convenient;
- High quality and high reliability;
- Super long service life.

■ TERMINAL

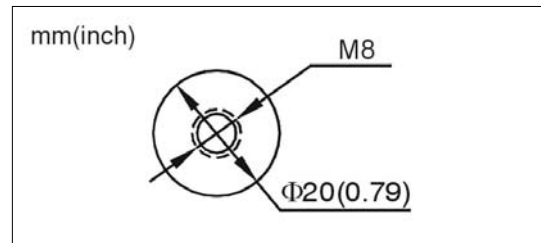

■ SPECIFICATIONS

| | | | | |
|-----------------------------------|--------------------|-------------------------------------|---|-------|
| Nominal Voltage | 2V | Nominal Capacity (C ₁₀) | 250Ah (1.80V @ 20°C) | |
| Dimension | Length 124mm | Approx. Weight | Without electrolyte:15.5kg /with electrolyte:20.2kg | |
| | Width 206mm | Max Charging Current | 50A | |
| | Height 354mm | Internal Resistance | Full charged@20°C: 0.0008 Ohm | |
| | Total Height 409mm | Self Discharge | 3% of capacity declined per month@20°C | |
| Capacity Affected by Temp. (10HR) | 40°C | 20°C | 0°C | -15°C |
| | 109% | 100% | 85% | 65% |

■ CHARGE

| | | |
|-----------------------|---------------------|---------------------|
| Using Mode | Cycle use | Float use |
| Charge Voltage (20°C) | 2.35~2.40V(-5mV/°C) | 2.21~2.25V(-3mV/°C) |

5 OPzS250

NON-SPILLABLE RECHARGEABLE SEALED LEAD ACID BATTERY

■ CONSTANT CURRENT DISCHARGE CHARACTERISTICS (20°C)

| TIME | 1h | 3h | 5h | 10h | 24h | 48h | 72h | 100h | 120h | 240h |
|-----------------|------|------|------|------|------|------|------|------|------|------|
| CUT-OFF VOLTAGE | 1.80 | 1.80 | 1.80 | 1.80 | 1.80 | 1.80 | 1.80 | 1.80 | 1.80 | 1.80 |
| CAPACITY(Ah) | 130 | 188 | 215 | 250 | 288 | 313 | 333 | 350 | 355 | 360 |

■ CONSTANT POWER DISCHARGE CHARACTERISTICS (20°C)

| TIME | 1h | 3h | 5h | 10h | 24h | 48h | 72h | 100h | 120h | 240h |
|-----------------|------|------|------|------|------|------|------|------|------|------|
| CUT-OFF VOLTAGE | 1.80 | 1.80 | 1.80 | 1.80 | 1.80 | 1.80 | 1.80 | 1.80 | 1.80 | 1.80 |
| CAPACITY(Wh) | 241 | 347 | 400 | 463 | 532 | 578 | 615 | 648 | 657 | 666 |

