



# UN75-12D (12V75Ah/10hr)

The rechargeable batteries are lead-lead dioxide systems. The dilute sulfuric acid electrolyte is absorbed by separators and thus immobilized.

Should the battery be accidentally overcharged producing hydrogen and oxygen, Special one-way valves allow the gases to escape thus avoiding excessive pressure build-up. Otherwise, the battery is completely sealed and is, therefore, maintenance-free, leak proof and usable in any position.

## Battery Construction

|              |                |                |           |       |              |          |            |               |
|--------------|----------------|----------------|-----------|-------|--------------|----------|------------|---------------|
| Component    | Positive plate | Negative plate | Container | Cover | Safety valve | Terminal | Separator  | Electrolyte   |
| Raw material | Lead dioxide   | Lead           | ABS       | ABS   | Rubber       | Copper   | Fiberglass | Sulfuric acid |

## General Feature

- Absorbent Glass Mat(AGM) technology for efficient gas recombination of up to 99% and freedom from electrolyte maintenance or water adding.
- Not restricted for air transport-complies with IATA/ICAO Special Provision A67.
- UL-recognized component.
- Can be mounted in any orientation.
- Computer designed lead, calcium tin alloy grid for high power density.
- Long service life, float or cyclic applications.
- Maintenance-free operation.
- Low self discharge.

## Performance Characteristics

|   |   |      |
|---|---|------|
| Capacity<br>77°F(25°C)                          | 20 hour rate (3.85A、10.8V)                          | 77Ah |
|   | 10 hour rate (7.5A、10.8V)                           | 75Ah |
|   | 5 hour rate (12.8A、10.5V)                           | 64Ah |
|   | 1 hour rate (46A、9.6V)                              | 46Ah |
| Internal Resistance                             | Full charged Battery77°F(25°C): 8mΩ                 |      |
| Capacity affected by Temperature (10 hour rate) | 104° F(40°C)  | 102% |
|   | 77° F(25°C)   | 100% |
|   | 32° F(10°C)   | 85%  |
|   | 5° F(-15°C)   | 65%  |
| Self-Discharge<br>68°F(20°C)                    | Capacity after 3 month storage                      | 90%  |
|   | Capacity after 6 month storage                      | 80%  |
|   | Capacity after 12month storage                      | 60%  |
| Max. discharge current77°F(25°C): 700A(5S)      |   |      |
| Charge (Constant Voltage)                       | Float: 13.6~13.8 V/77° F(25°C)                      |      |
|   | Cycle:14.4~14.7 V/77°F(25°C)<br>Max. Current: 18.8A |      |

## SPECIFICATION

- Nominal voltage ..... 12V
- Number of cell ..... 6
- Length(mm/inch) ..... 260/10.2
- Width(mm/inch) ..... 169/6.65
- Height(mm/inch) ..... 208/8.19
- Total Height(mm/inch) ..... 212/8.35
- Approx. Weight(kg/lbs) ..... 21.5/47.4

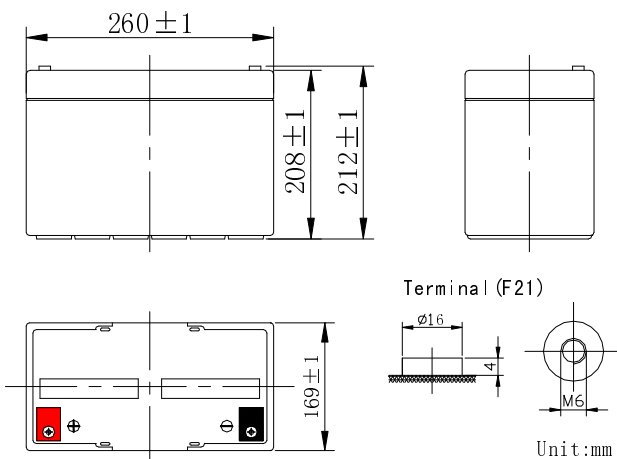

Discharge Constant Current (Amperes at 77° F 25 °C)

| End Point Volts/Cell | 5min | 10min | 15min | 30min | 1h   | 3h   | 5h   | 10h  | 20h  |
|----------------------|------|-------|-------|-------|------|------|------|------|------|
| 1.60V                | 237  | 178   | 137   | 82.3  | 46.0 | 19.5 | 13.4 | 7.70 | 4.03 |
| 1.65V                | 223  | 168   | 132   | 79.8  | 45.4 | 19.2 | 13.2 | 7.67 | 4.01 |
| 1.70V                | 210  | 158   | 126   | 77.2  | 44.7 | 18.9 | 13.0 | 7.63 | 3.98 |
| 1.75V                | 196  | 149   | 121   | 74.5  | 44.1 | 18.6 | 12.8 | 7.60 | 3.95 |
| 1.80V                | 181  | 140   | 114   | 72.0  | 43.6 | 18.2 | 12.6 | 7.50 | 3.85 |

Discharge Constant Power (watts at 77° F 25 °C)

| End Point Volts/Cell | 5min | 10min | 15min | 30min | 45min | 1h   | 2h   | 3h   | 5h   |
|----------------------|------|-------|-------|-------|-------|------|------|------|------|
| 1.60V                | 415  | 325   | 255   | 153   | 120   | 97.7 | 54.9 | 40.0 | 27.4 |
| 1.65V                | 405  | 302   | 250   | 151   | 117   | 95.9 | 53.9 | 37.2 | 26.9 |
| 1.70V                | 377  | 292   | 246   | 148   | 115   | 94.1 | 52.9 | 36.5 | 26.4 |
| 1.75V                | 358  | 276   | 232   | 146   | 112   | 92.3 | 51.9 | 35.8 | 25.8 |
| 1.80V                | 343  | 263   | 220   | 143   | 109   | 90.5 | 51.0 | 35.1 | 25.3 |

(Note)The above characteristics data are average values obtained Within three charge/discharge cycles not the minimum values.

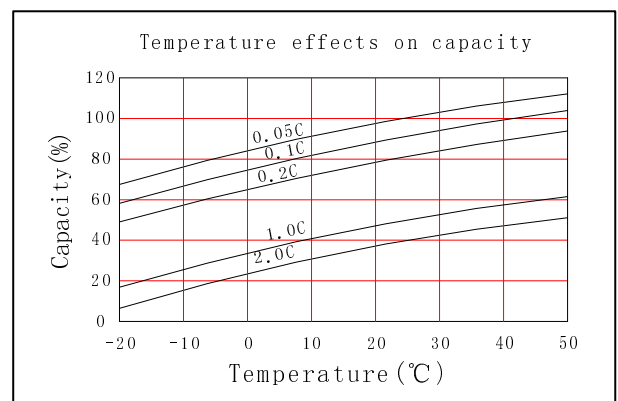
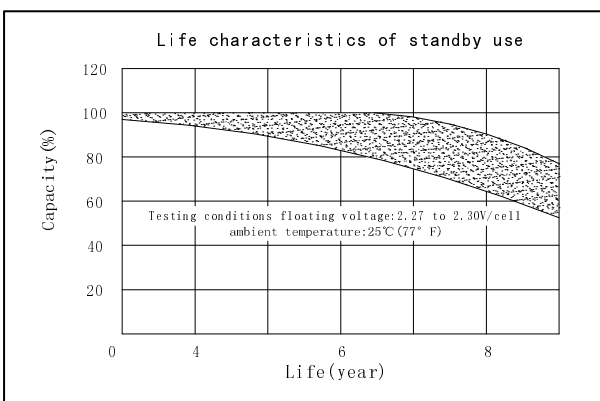
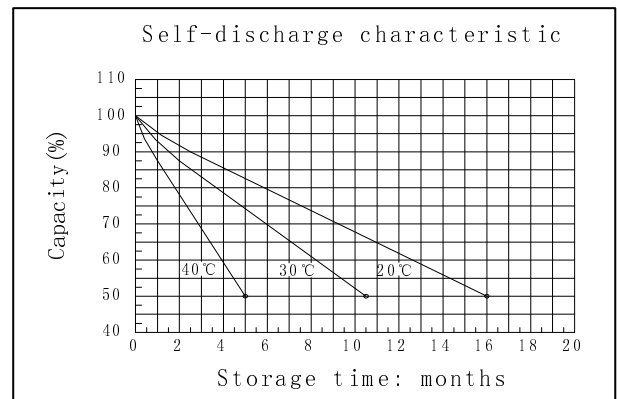
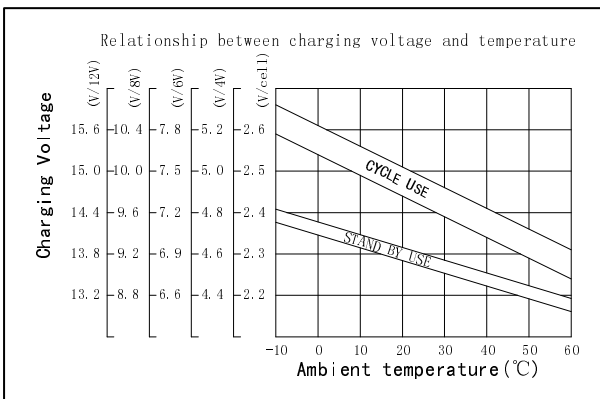
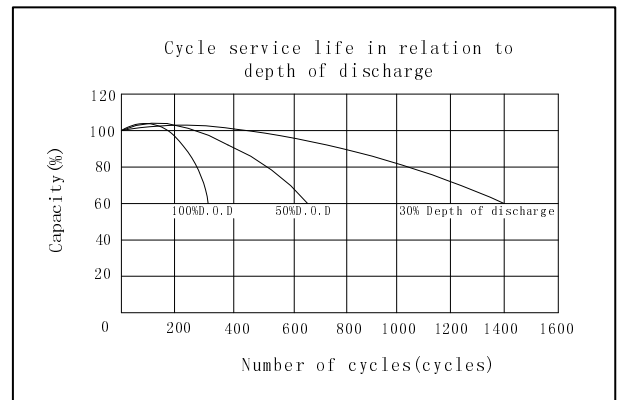
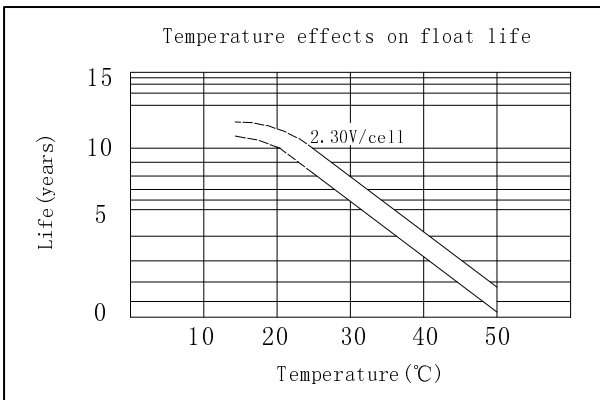
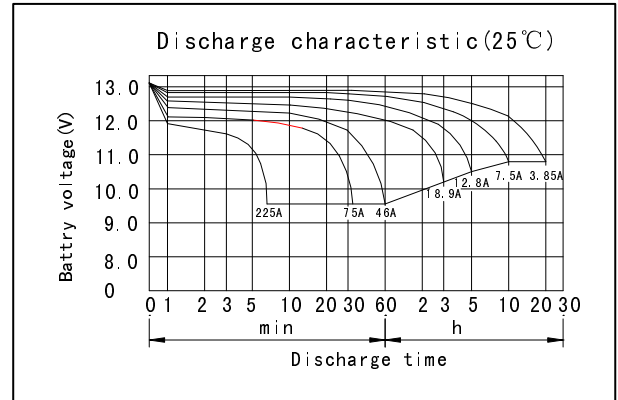
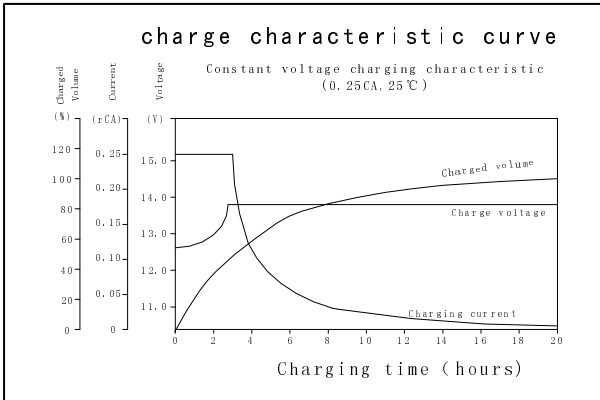

**DONGGUAN OREMA POWER CO., LTD**

Add: #1 Qilinling Road Shahu, Tangxia Town, Dongguan Guangdong China

TEL: +86-769- 3896 1163 +86-769- 3896 1168

FAX: +86-769- 3896 1169



[www.oremabattery.com](http://www.oremabattery.com)