

The battery is manufactured with PVC-SiO₂ separator and colloidal or fumed silica. The tubular positive plate and pasted negative palte is applied. The batteries use silica gel to immobilize the electrolyte inside the battery. The proven silica gel technology improves battery cycle life and performance at various ambient temperatures.

Battery Construction

| Component | Positive plate | Negative plate | Container | Cover | Safety valve | Terminal | Separator | Electrolyte |
|--------------|----------------|----------------|-----------|-------|--------------|----------|----------------------|---------------|
| Raw material | Tubular | Lead | ABS | ABS | Rubber | Copper | PVC-SiO ₂ | Fumed silicon |

General Feature

- The battery has a long service life, under float charging, ambient temperature 25°C, it can operate 15-20 years .
- Excellent Recovery from deep discharge and good deep discharge cycle capability.
- the battery has a low self-discharge, keep over 60% of the rated capacity after 2 years stored under 25°C
- High Reliability and Quality

SPECIFICATION

Nominal voltage 2V
 Number of cell 1
 Length(mm/inch) 206/8.11
 Width(mm/inch) 124/4.88
 Height(mm/inch) 470/18.5
 Total Height(mm/inch) 496/19.5
 Approx. Weight (kg/lbs) 31/68.3

Performance Characteristics

| | | |
|---|--|---------|
| Capacity 77 ℉(25°C) | 240 hour rate (1.94A、 1.85V) | 465Ah |
| | 48 hour rate (9.1A、 1.85V) | 437Ah |
| | 10 hour rate (35A、 1.8V) | 350Ah |
| | 3 hour rate (87.5A、 1.6V) | 262.5Ah |
| Internal Resistance | Full charged Battery 77 ℉(25°C):0.45mΩ | |
| Operating Temperature Range | Discharge: -20~65°C | |
| | Charge: -10~65°C | |
| | Storage: -20~65°C | |
| Self-Discharge 1.5% of capacity declined per month at 20°C (average) | | |
| Max. discharge current 77 ℉(25°C): 1800A(5S) | | |
| Charge (Constant Voltage) | Float: 2.23~2.27 V/77° ℉(25°C) | |
| | Cycle: 2.38~2.42 V/77 ℉(25°C) Max. Current: 52.5A | |

Discharge Constant Current (Amperes at 77° F/25°C)

| End Point Volts/Cell | 15min | 30min | 1h | 3h | 5h | 10h | 24h | 48h | 120h |
|----------------------|-------|-------|-----|------|------|------|------|-----|------|
| 1.65V | 441 | 329 | 207 | 94.0 | 66.2 | --- | --- | --- | --- |
| 1.70V | 399 | 299 | 194 | 91.2 | 62.7 | --- | --- | --- | --- |
| 1.75V | 376 | 284 | 182 | 90.0 | 61.1 | 35.7 | --- | --- | --- |
| 1.80V | 354 | 268 | 179 | 87.5 | 58.6 | 35.0 | --- | --- | --- |
| 1.85V | 331 | 243 | 171 | 85.6 | 57.2 | 33.1 | 16.3 | 9.1 | 3.9 |

Discharge Constant Power (watts at 77° F/25°C)

| End Point Volts/Cell | 15min | 30min | 1h | 3h | 5h | 10h | 24h | 48h | 120h |
|----------------------|-------|-------|-----|-----|-----|------|------|------|------|
| 1.65V | 860 | 642 | 411 | 187 | 132 | --- | --- | --- | --- |
| 1.70V | 778 | 584 | 387 | 181 | 125 | --- | --- | --- | --- |
| 1.75V | 734 | 553 | 362 | 179 | 122 | 71.0 | --- | --- | --- |
| 1.80V | 689 | 522 | 355 | 174 | 117 | 69.7 | --- | --- | --- |
| 1.85V | 645 | 474 | 341 | 170 | 114 | 65.8 | 32.4 | 18.1 | 7.7 |

(Note) The above characteristics data are average values obtained Within three charge/discharge cycles not the minimum values.

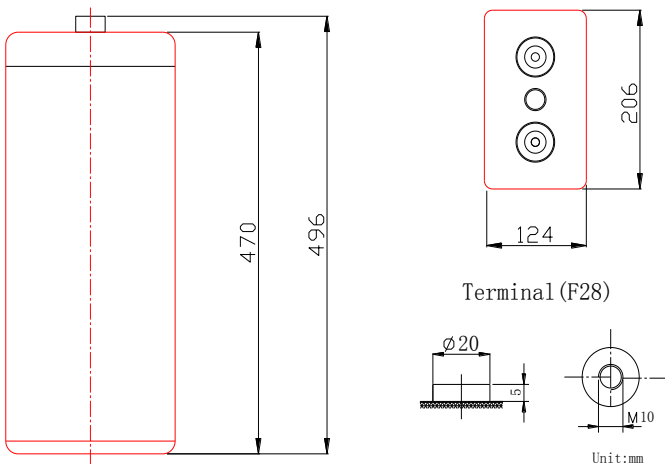

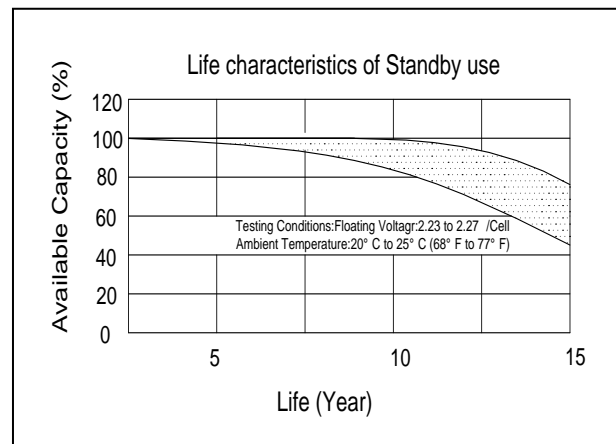
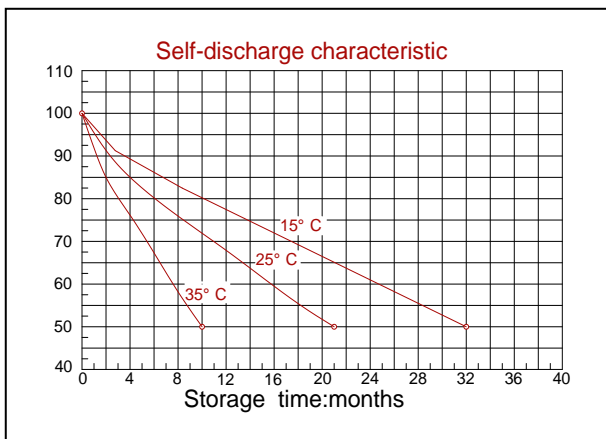
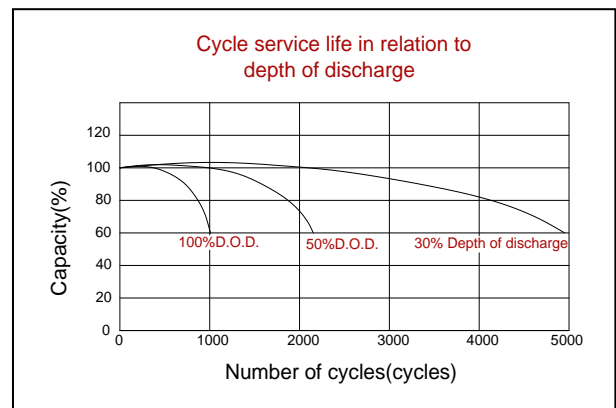
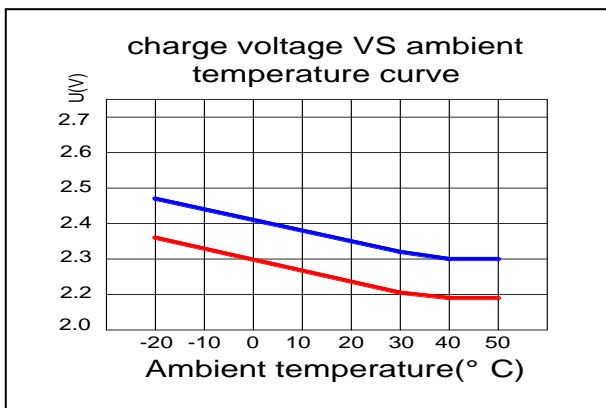
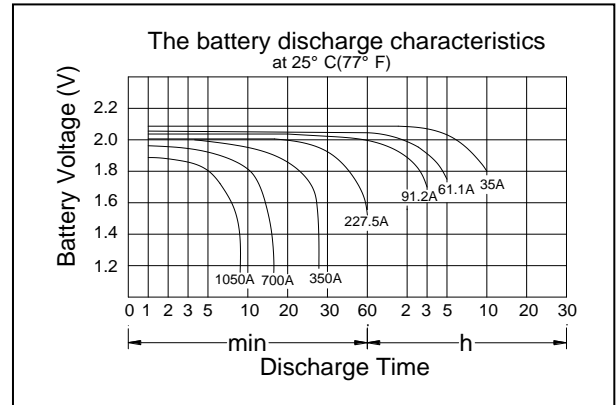
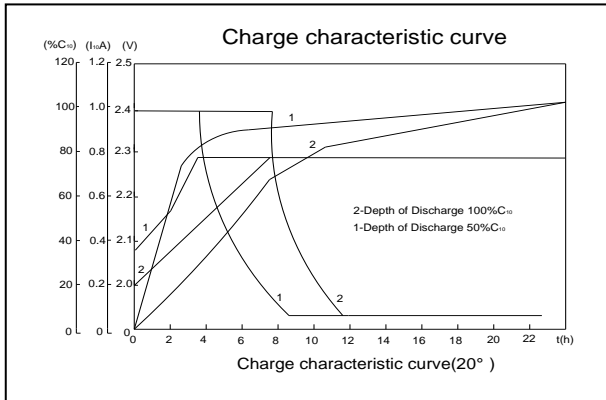

DONGGUAN OREMA POWER CO., LTD

Add: #1 Qilinling Road Shahu, Tangxia Town, Dongguan Guangdong China

TEL: +86-769- 3896 1163 +86-769- 3896 1168

FAX: +86-769- 3896 1169



www.oremabattery.com