

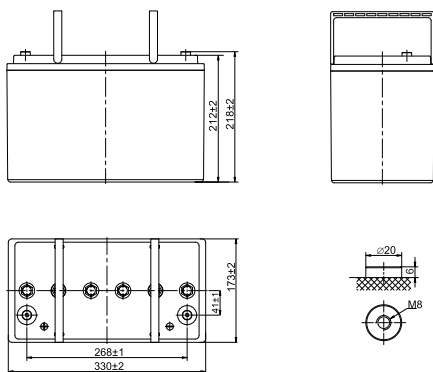

## Layout



## Specification

Nominal Voltage	12V	
Rated Capacity	86.4Ah	(C <sub>10</sub> , 1.80V/cell)
Dimension	Length	330mm(12.99in.)
	Width	173mm(6.81in.)
	Container Height	212mm(8.35 in.)
	Total Height (with Terminal)	218mm(8.58 in.)
Approx Weight	30.8Kg (67.9 lbs)	
Terminal	T11(M8,Torque11~14.7Nm)	
Container Material	ABS	
Capacity	86.4 Ah	(10hr,8.64A,1.80V/cell)
	73.5 Ah	(5hr,14.7A,1.75V/cell)
	63.6 Ah	(3hr,21.2A,1.75V/cell)
	51.2 Ah	(1hr,51.2A,1.67V/cell)
Max. Discharge Current	640A (5s)	
Internal Resistance	Approx 7.8 mΩ	
Operating Temp. Range	Discharge	-20°C~55°C (-4°F~131°F)
	Charge	0°C~40°C (32°F~104°F)
	Storage	-20°C~50°C (-4°F~122°F)
Nominal Operating Temp. Range	25°C±3°C (77°F±5°F)	
Cycle Use(25°C)	Charging Current	≤20.0A
	Charging Voltage	2.34V~2.40V
Standby Use (25°C)	Charging Current	≤20.0A
	Charging Voltage	2.25V
	Temp. Coefficient	-3mV/cell/°C
Self Discharge	≤3% per month at 25°C	

## Constant Current Discharge (Amperes) at 25 °C (77°F)

F. V/Time	10min	15min	30min	1h	2h	3h	5h	8h	10h
1.85V/cell	77.2	68.1	53.4	40.2	25.5	19.4	13.9	9.76	8.25
1.80V/cell	92.8	78.7	57.1	42.8	26.8	20.3	14.2	10.2	8.64
1.75V/cell	106.5	87.9	61.4	45.6	28.1	21.2	14.7	10.5	8.81
1.70V/cell	116.3	95.4	65.8	48.2	29.2	22.1	15.1	10.6	8.90
1.67V/cell	127.2	102.4	72.2	51.2	31.0	23.4	15.9	10.8	9.07
1.60V/cell	135.7	108.3	75.0	52.7	32.1	24.0	16.2	11.0	9.24

## Constant Power Discharge (Watts/cell) at 25 °C (77°F)

F. V/Time	10min	15min	30min	1h	2h	3h	5h	8h	10h
1.85V/cell	127.0	116.8	102.0	78.2	49.8	38.0	27.4	19.3	16.5
1.80V/cell	153.6	139.2	109.0	83.0	52.2	39.5	27.9	20.2	17.2
1.75V/cell	178.6	153.6	116.2	87.9	54.6	41.4	28.9	20.7	17.5
1.70V/cell	196.8	165.4	123.3	92.4	56.3	42.6	29.6	21.1	17.7
1.67V/cell	207.4	172.2	134.1	97.6	59.5	45.3	31.0	21.4	17.9
1.60V/cell	212.8	175.7	137.7	100.0	61.2	46.0	31.6	21.7	18.3

## Applications

- Telecommunications
- Radio and cellular telephone relay stations
- Emergency lighting systems
- Power stations, Conventional power stations, alternative power (solar, wind)
- Large UPS and computer back-up
- Railway signaling
- Maritime standby power on ships and ashore
- Process and control engineering
- Standby power
- Buoy lighting

## General Features

- Better recovery performance
- Wide working temperature range (-20~50)°C
- No electrolyte stratification provides longer service life.
- High recombination efficient.
- Built in copper core based in lead will carry large current
- Separator imported from AMER-SIL high porosity. PVC-SiO<sub>2</sub> and low resistance.
- Pasted negative plate special grid design increase the active material. availability large current discharge and charge ability.
- Tubular type positive plate (polyester tube) prevent the active material from falling. Multi metal alloy pressed positive grid increase the anti corrosion ability and service life.

## Standards

- IEC 60896 Certified
- Classified as "Very Long Life" according to Eurobat
- UL Certified
- Manufactured in Leoch® TS16949, ISO 9001 and ISO 14001 certified production facilities

### Charge voltage vs ambient temperature curve

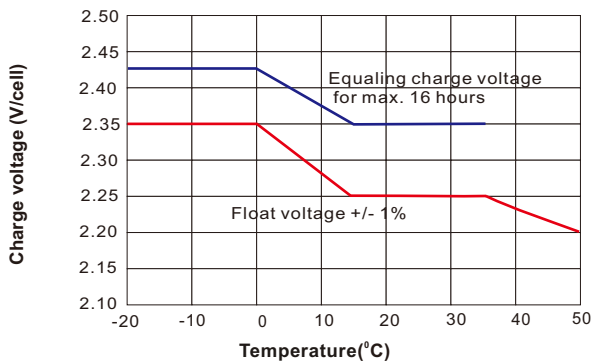

For continuous charging we recommend a voltage of 2.25 V. The charging voltage must be compensated to the curve for a continuously different battery ambient temperature.

### Temperature Effects in Relation to Battery Capacity

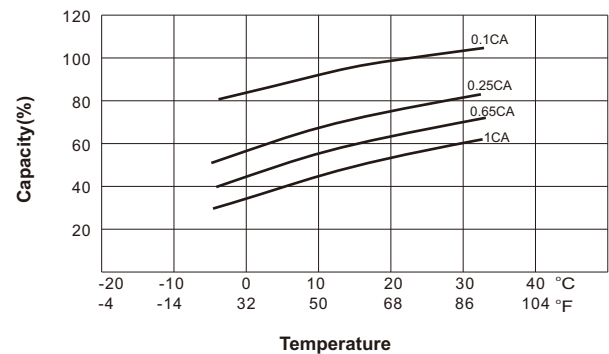

### Cycle Life in Relation to Depth of Discharge

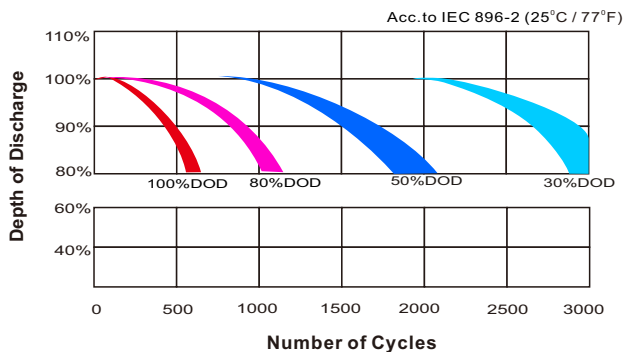

### Float Life

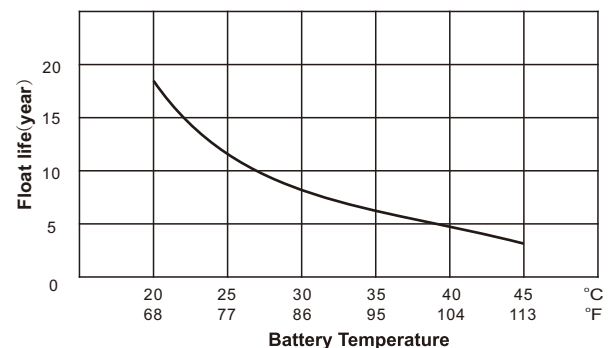

## Sales Offices Worldwide

### China Sales Office

5th Floor, Xinbaohui Bldg., Nanhai Blvd., Nanshan, Shenzhen, China. 518052  
Tel: +86-755-86036060 (100 lines)  
Fax: +86-755-26067269  
E-mail: export@leoch.com

### HongKong Sales Office

Workshop C, 33/F, TML Tower, No. 3 Hoi Shing Road, Tsuen Wan, New Territories, Hong Kong  
Tel: +852 35786666  
Fax: +44 1452 690125  
E-mail: sales.hk@leoch.com

### Singapore Sales Office

No. 1 Tech Park Crescent, Singapore 638131  
Tel: +65 68636078  
Fax: +65 6863 6079  
Email: sales.sg@Leoch.com

### Australia Sales Office

2 /29 Tarlington Place, Smithfield. NSW 2164 Australia  
Tel: 02 9756 0950  
E-mail: sales.au@leoch.com

### North America Sales Office

19751 Descartes Foothill Ranch, CA 92610, USA  
Tel: 949-588-5853  
Fax: 949-588-5966  
E-mail: sales@leoch.us

### UK Sales Office

9B Wheatstone Court. Waterwells, Business Park, Gloucester, GL2-2AQ, UK United Kingdom  
Tel: +44(0) 1452 729428 / 1452 729696  
Fax: +44 1452 690125  
E-mail: Sales.Europe@leoch.com

### Europe/MEA Sales Office

1 Deligiorgi St., 121 31 Athens, Greece  
Tel: +30 210 5760318 (2 lines)  
E-mail: support\_EMEA@leoch.com

### India Sales Office

Shed no. A-53(b), 2nd Stage of Peenya Industrial Area, Bangalore North Taluk, Bangalore-560058, India  
Tel: +91-80-23440018/23440019  
Fax: +91-80-23440017  
E-mail: indiasales@leoch.com



[Http://www.leoch.com](http://www.leoch.com)  
[Http://www.leoch.us](http://www.leoch.us)

© 2017 LEOCH. All rights reserved.

Trademarks and logos are the property of LEOCH and its affiliates unless otherwise noted.  
Subject to revisions without prior notice.

Publication No.:LB-12V40PzV80-PD-EN-V1.0-201710