

PLH+C 90FT(12V90Ah)

PLH+C SERIES-LONG PSoC LIFE

Applications

- UPS system
- Backup Power
- Demand charge reduction
- Time-of-Use bill management
- Increased PV self consumption
- Grid-Tied Energy Storage System
- Grid-Zero Energy Storage System

Key Features

- High energy density
- High-rate performance
- Low internal resistance
- Low self-discharging rate
- Supper high PSoC cycle life
- Excellent Fast charging acceptance:
1.5 hour to 90% SoC
- Excellent high rate discharge performance
in low temperature
- Advanced lead acid batteries: Pure Lead
Thin Plate Carbon Technology

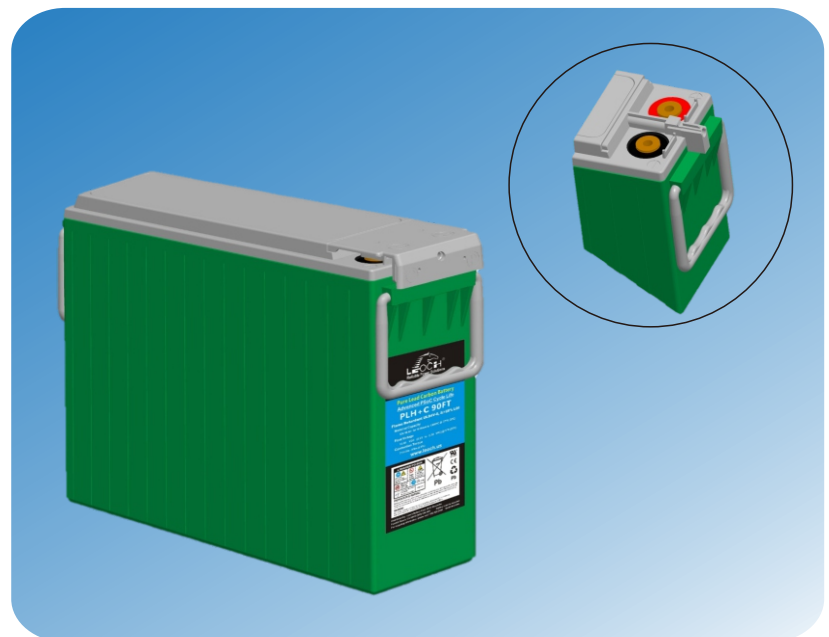

Layout

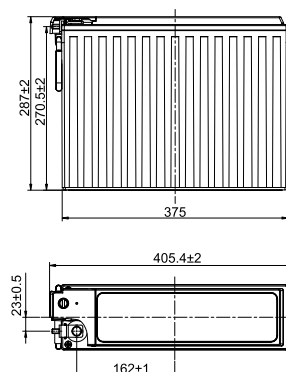

Terminal

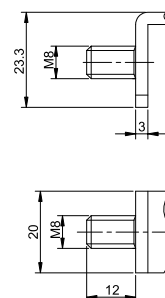

LEOCH INTERNATIONAL TECHNOLOGY LIMITED.

www.leoch.com

Pure Lead Carbon Technology - PSoC Cycle



PLH+C 90FT(12V90Ah) PLH+C SERIES-LONG PSoC LIFE

Specification

Nominal Voltage	12V		
Rated Capacity (Ah)	10hr	90Ah @25 °C to 1.80V/cell	
	8hr	90Ah @25 °C to 1.75V/cell	
Dimension	Length	405.4 ± 2mm (15.96 inches)	
	Width	108 ± 2mm (4.25 inches)	
	Container Height	287 ± 2mm (11.30 inches)	
	Total Height (with Terminal)	287 ± 2mm (11.30 inches)	
Weight	Approx 28.6Kg (63.1 lbs)		
Terminal	T11		
Container Material	PC-ABS flame retardant jar and cover to UL94V-0		
Max. Discharge Current	1080A (5s)		
Internal Resistance	Approx 4.8mΩ		
Operating Temp. Range	Discharge	-40~65°C (-40~149°F)	
	Charge	0~40°C (32~104°F)	
	Storage	-20~40°C (-4~104°F)	
Capacity affected by Temperature	40°C (104°F)	103%	
	25°C (77°F)	100%	
	0°C (32°F)	86%	
Self Discharge	PLH+C series batteries can be stored up to 24 months at 25°C(77°F) and then a freshening charge is required. For higher temperatures the time interval will be shorter.		



Constant Current Discharge (Amperes) at 25 °C (77°F)

F. V/Time	10min	15min	20min	30min	45min	1h	2h	3h	4h	5h	8h	10h	20h
1.85V/cell	177.1	145.8	124.7	97.7	74.5	60.7	35.6	25.5	20.0	16.4	10.9	8.91	4.78
1.80V/cell	196.6	159.7	135.3	104.5	78.8	63.7	36.7	26.1	20.3	16.7	11.1	9.04	4.89
1.75V/cell	214.9	172.2	144.6	110.4	82.4	66.1	37.7	26.7	20.7	17.0	11.3	9.22	4.99
1.70V/cell	231.2	183.0	152.3	115.2	85.3	68.0	38.4	27.0	21.0	17.3	11.4	9.31	5.06
1.67V/cell	239.9	188.4	156.1	117.5	86.6	68.9	38.7	27.2	21.1	17.3	11.5	9.31	5.09
1.60V/cell	255.8	197.4	162.1	120.7	88.3	70.1	39.2	27.6	21.4	17.5	11.7	9.49	5.13

Constant Power Discharge (Watts) at 25 °C (77°F)

F. V/Time	10min	15min	20min	30min	45min	1h	2h	3h	4h	5h	8h	10h	20h
1.85V/cell	335.4	278.8	239.8	185.8	145.6	119.2	70.6	50.8	39.8	33.0	21.9	17.9	9.58
1.80V/cell	366.8	301.3	257.1	199.2	152.8	124.2	72.5	51.9	40.6	33.4	22.1	18.2	9.85
1.75V/cell	395.5	321.2	272.2	209.0	158.8	128.3	74.1	52.8	41.2	33.9	22.4	18.4	10.0
1.70V/cell	420.4	338.0	284.5	215.7	163.4	131.6	75.4	53.5	41.7	34.3	22.7	18.6	10.1
1.67V/cell	433.2	346.3	290.3	219.8	165.5	132.9	75.9	53.8	41.9	34.5	22.8	18.7	10.2
1.60V/cell	455.4	359.3	299.1	224.8	168.3	134.7	76.6	54.3	42.3	34.8	23.0	18.9	10.2

China Sales Office

5th Floor, Xinbaohui Bldg., Nanshai Blvd, Nanshan, Shenzhen, China. 518054
Tel: +86-755-86036060(100 lines) Fax: +86-755-26067269
E-mail: export@leoch.com

© 2018 LEOCH. All rights reserved.

Trademarks and logos are the property of LEOCH and its affiliates unless otherwise noted.
Subject to revisions without prior notice.