

PLH+C 100(12V100Ah)

PLH+C SERIES-LONG PSoC LIFE

Applications

- UPS system
- Backup Power
- Demand charge reduction
- Time-of-Use bill management
- Increased PV self consumption
- Grid-Tied Energy Storage System
- Grid-Zero Energy Storage System



Key Features

- High energy density
- High-rate performance
- Low internal resistance
- Low self-discharging rate
- Supper high PSoC cycle life
- Excellent Fast charging acceptance:
1.5 hour to 90% SoC
- Excellent high rate discharge performance
in low temperature
- Advanced lead acid batteries: Pure Lead
Thin Plate Carbon Technology

Layout

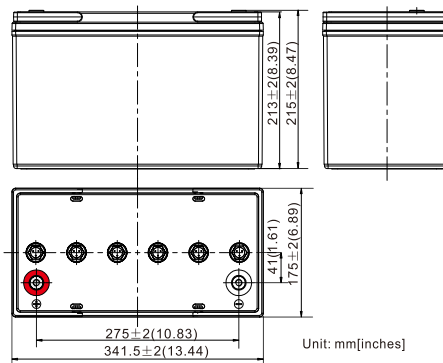

Terminal

Terminal Model: T11

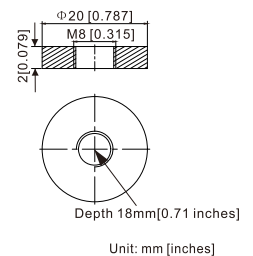

Pure Lead Carbon Technology - PSoC Cycle



PLH+C 100(12V100Ah) PLH+C SERIES-LONG PSoC LIFE

Specification

Nominal Voltage	12V
Rated Capacity (Ah)	10hr 100Ah @25 °C to 1.80V/cell
	8hr 100Ah @25 °C to 1.75V/cell
Dimension	Length 341.5±2mm (13.44 inches)
	Width 175±2mm (6.89 inches)
	Container Height 213±2mm (8.39 inches)
	Total Height (with Terminal) 215±2mm (8.46 inches)
Weight	Approx 31.2Kg (68.8 lbs)
Terminal	T11
Container Material	PC-ABS flame retardant jar and cover to UL94V-0
Max. Discharge Current	1250A (5s)
Internal Resistance	Approx 3.5mΩ
Operating Temp. Range	Discharge : -40~65°C (-40~149°F)
	Charge : 0~40°C (32~104°F)
	Storage : -20~40°C (-4~104°F)
Capacity affected by Temperature	40°C (104°F) 103%
	25°C (77°F) 100%
	0°C (32°F) 86%
Self Discharge	PLH+C series batteries can be stored up to 24 months at 25°C(77°F) and then a freshening charge is required. For higher temperatures the time interval will be shorter.



Constant Current Discharge (Amperes) at 25 °C (77°F)

F. V/Time	10min	15min	20min	30min	45min	1h	2h	3h	4h	5h	8h	10h	20h
1.85V/cell	198.4	163.3	139.7	109.4	83.5	68.0	39.9	28.5	22.4	18.4	12.2	9.93	5.35
1.80V/cell	220.2	178.8	151.5	117.1	88.2	71.3	41.1	29.2	22.8	18.7	12.4	10.0	5.48
1.75V/cell	240.7	192.9	161.9	123.7	92.3	74.1	42.2	29.9	23.2	19.0	12.5	10.3	5.59
1.70V/cell	259.0	204.9	170.6	129.0	95.5	76.2	43.0	30.3	23.5	19.3	12.8	10.4	5.67
1.67V/cell	268.7	211.0	174.9	131.6	97.0	77.2	43.3	30.5	23.7	19.4	12.9	10.4	5.70
1.60V/cell	284.2	219.4	180.1	134.1	98.1	77.9	43.6	30.6	23.8	19.5	13.0	10.5	5.70

Constant Power Discharge (Watts) at 25 °C (77°F)

F. V/Time	10min	15min	20min	30min	45min	1h	2h	3h	4h	5h	8h	10h	20h
1.85V/cell	375.7	312.2	268.6	208.1	163.0	133.5	79.0	56.9	44.6	36.9	24.5	20.0	10.7
1.80V/cell	410.8	337.4	287.9	223.1	171.1	139.1	81.2	58.1	45.4	37.4	24.8	20.3	11.0
1.75V/cell	443.0	359.8	304.8	234.1	177.8	143.7	83.0	59.1	46.1	38.0	25.1	20.6	11.2
1.70V/cell	470.9	378.6	318.6	241.6	183.0	147.4	84.4	59.9	46.7	38.5	25.4	20.8	11.3
1.67V/cell	485.2	387.8	325.2	246.2	185.4	148.9	85.0	60.2	47.0	38.7	25.5	20.9	11.4
1.60V/cell	510.1	402.4	335.0	251.8	188.4	150.9	85.8	60.8	47.4	39.0	25.7	21.2	11.5

China Sales Office

5th Floor, Xinbaohui Bldg., Nanshai Blvd, Nanshan, Shenzhen, China. 518054
Tel: +86-755-86036060(100 lines) Fax: +86-755-26067269
E-mail: export@leoch.com

© 2018 LEOCH. All rights reserved.

Trademarks and logos are the property of LEOCH and its affiliates unless otherwise noted.
Subject to revisions without prior notice.