

Specification

Nominal Voltage	2V	
Nominal Capacity(10HR)	1500.0AH (1.8V/cell,20°C)	
Dimension	Length	275±3mm (10.8 inches)
	Width	210±3mm (8.27 inches)
	Container Height	796±3mm (31.3 inches)
	Total Height (with Terminal)	851±3mm (33.5 inches)
	Without Electrolyte	83.8 kg (184.36lbs)
Approx Weight	With Electrolyte	113.8 kg (250.36lbs)
	Container Material	SAN transparent container
Rated Capacity	1500.0 AH/150.0A	(10hr, 1.80V/cell, 25°C/77°F)
	1332.0 AH/266.4A	(5hr, 1.75V/cell, 25°C/77°F)
	1156.5 AH/385.5A	(3hr, 1.75V/cell, 25°C/77°F)
	856.5 AH/856.5A	(1hr, 1.60V/cell, 25°C/77°F)
Max. Discharge Current	12000A (5s)	
Internal Resistance	Approx 0.21mΩ	
Operating Temp.Range	Discharge	-15~50°C (5~122°F)
	Charge	0~40°C (32~104°F)
	Storage	-15~40°C (5~104°F)
Type and number of poles	M8/4	
Charging	Floating voltage: 2.23V~2.25V at 20°C(68°F)Temp.	
	Boost charge: 2.30V~2.40V at 20°C(68°F)Temp.	
	Charging current(max.): 0.1CA	
	Temp.Coefficient -3mV/°C	
Capacity affected by Temperature	40°C (104°F)	103%
	25°C (77°F)	100%
	0°C (32°F)	86%
Self Discharge	Leoch OPzS batteries may be stored for up to 6 months at 20°C(68°F) and then a freshening charge is required. For higher temperatures the time interval will be shorter.	



Applications

- ◆ Telecommunications.
- ◆ Radio and cellular telephone relay stations.
- ◆ Emergency lighting systems.
- ◆ Power stations, Conventional power stations,
- ◆ alternative power (solar, wind).
- ◆ Large UPS and computer back-up.
- ◆ Railway signalling.
- ◆ Maritime standby power on ships and ashore.
- ◆ Standby power.
- ◆ Buoy lighting.
- ◆ Long service life, designed life 15-20 years.

Constant Current Discharge (Amperes) at 20 °C (68°F)

F.V/Time	30min	45min	1h	1.5h	2h	3h	4h	5h	6h	8h	10h	20h
1.60V/cell	1137.0	988.0	856.5	675.0	558.0	417.0	335.3	283.5	245.4	194.2	160.4	87.0
1.65V/cell	1068.0	950.0	828.0	658.0	545.3	410.0	330.4	279.7	242.0	191.8	158.5	86.2
1.70V/cell	1014.0	896.0	796.5	637.0	532.5	398.0	322.9	273.7	237.5	188.5	155.9	85.0
1.75V/cell	951.0	854.0	756.0	607.0	510.0	385.5	313.1	266.4	231.8	185.3	153.3	83.6
1.80V/cell	846.0	770.0	696.0	569.0	479.3	366.0	299.8	255.4	223.3	180.3	150.0	82.0
1.85V/cell	675.0	638.0	595.5	506.0	435.0	335.0	277.4	239.4	210.3	171.3	143.6	78.8

Constant Power Discharge (Watts) at 20 °C (68°F)

F.V/Time	30min	45min	1h	1.5h	2h	3h	4h	5h	6h	8h	10h	20h
1.60V/cell	1940.9	1729.0	1520.7	1213.4	1014.7	763.7	619.4	527.4	459.5	365.2	302.9	164.9
1.65V/cell	1862.7	1682.2	1482.3	1188.8	996.5	754.7	613.5	523.0	455.5	362.5	300.8	164.2
1.70V/cell	1792.8	1603.2	1436.6	1158.5	977.4	736.1	601.5	513.7	448.3	357.6	296.9	162.5
1.75V/cell	1709.7	1544.4	1376.5	1111.9	942.9	717.5	586.4	502.5	439.0	352.8	293.3	160.5
1.80V/cell	1541.6	1413.6	1283.5	1054.4	894.0	686.4	564.7	484.0	425.5	345.0	288.5	158.3
1.85V/cell	1250.8	1188.3	1114.3	950.4	820.5	635.0	527.8	457.6	403.9	330.5	278.4	153.5

Dimensions

Terminal

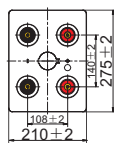
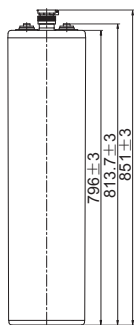
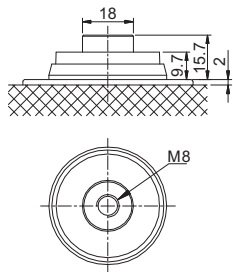

Discharge Characteristics

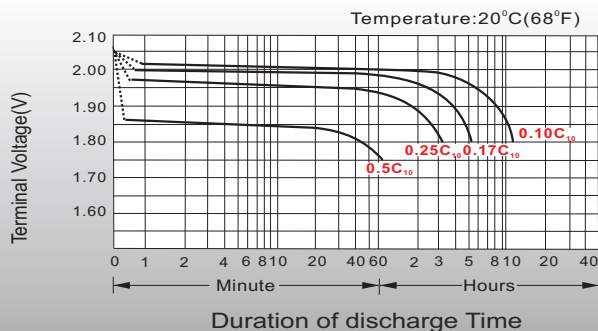

Charge voltage Vs ambient temperature curve

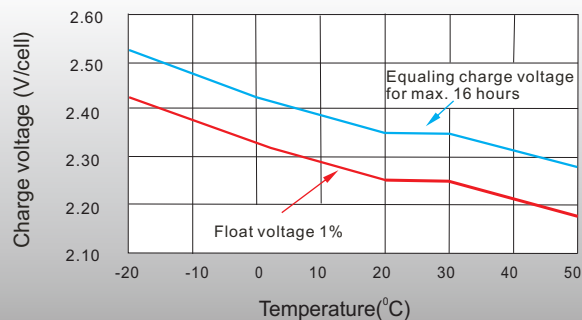

Discharge capacity Vs Ambient temperature curve (I10A)

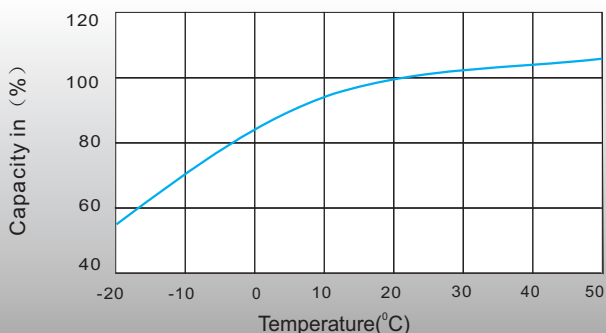

Relation curves of service life and ambient temperature

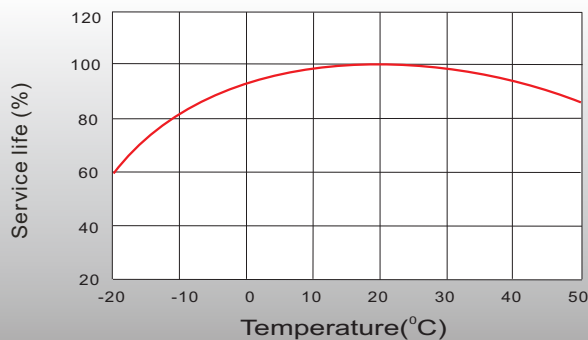

Self Discharge Characteristics

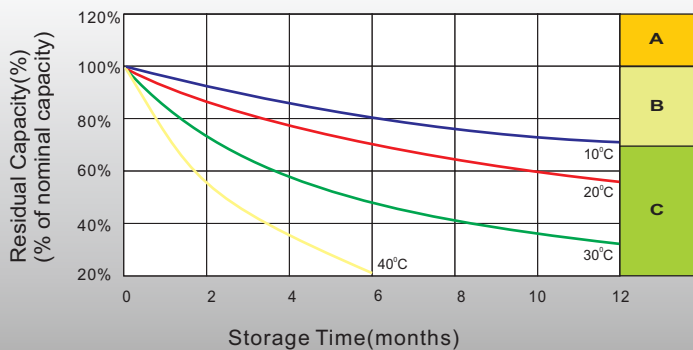

- A** No supplementary charge required (Carry out supplementary charge before use if 100% capacity is required.)
- B** Supplementary charge required before use. Optional charging way as below:
 1. Charged for above 3 days at limited current 0.1CA and constant voltage 2.25V/cell.
 2. Charged for above 20 hours at limited current 01CA and constant voltage 2.45V/cell.
 3. Charged for 8~10 hours at limited current 0.05CA .
- C** Supplementary charge may often fail to recover the capacity. The battery should never be left standing till this is reached.

Sales Office

China sales office:

Add: 5th Floor, Xinbaohui Bldg., Nanhai Blvd, Nanshan, Shenzhen, China. 518052
 Tel: +86-755-86036060 (100 lines)
 Fax: +86-755-26067269
 E-mail: export@leoch.com
 Http://www.leoch.com

HongKong sales office:

Add: Workshop C, 33/F, TML Tower, No. 3 Hoi Shing Road, Tsuen Wan, New Territories, Hong Kong
 Tel: +852 35786666
 Fax: +852 21170016
 E-mail: sales.hk@leoch.com

Singapore sales office:

Add: NO.1 Tech Park Crescent, Singapore 638131
 Tel: +65 68416629
 Fax: +65 68443210
 Email sales.sg@leoch.com

North America sales office:

Add: 19751 Descartes, Unit A, Foothill Ranch, CA 92610, USA
 Tel: 949-588-5853
 Fax: 949-588-5966
 E-mail: sales@leoch.us
 Http://www.leoch.com

Europe sales office:

Add: 9B Wheatstone Park, Waterwells Business Park, Gloucester, GL2 2AQ, UK United Kingdom
 Tel: +44(0) 1452 729428/1452 729696
 Fax: +44 (0)1452-690125
 E-mail: Sales.Europe@leoch.com