

Motive Battery  Energy Storage Battery

Reserve Battery  Motorcycle Battery



## Energy Storage Battery-Tubular GEL Technology-OPzV Series

# 4OPzV150

(2V 150Ah)

### GENERAL FEATURES

- ◆ 20 years design life at floating condition
- ◆ Wide operating temperature range from -40°C to +60°C
- ◆ Tubular positive plate with prolonged cycle life
- ◆ Fumed silica gel electrolyte
- ◆ Lead calcium die case grid with improved corrosion resistance ability
- ◆ Low self-discharge rate and long shelf life
- ◆ Excellent deep discharge recovery capability



### Application

- ◆ Renewable energy system
- ◆ Hybrid solar power system
- ◆ Uninterrupted Power Supply ( UPS )
- ◆ Communications and electric equipment
- ◆ Emergency lighting equipment
- ◆ Fire alarm and security systems
- ◆ Control equipment, and other factory automation equipment
- ◆ Emergency power supply ( EPS )
- ◆ Lighting equipment

### Dimension

Unit:mm

Length	103±2mm	/	4.88inch
Width	206±2mm	/	8.11inch
Container Height	355±3mm	/	13.98inch
Total Height	390±3mm	/	15.35inch

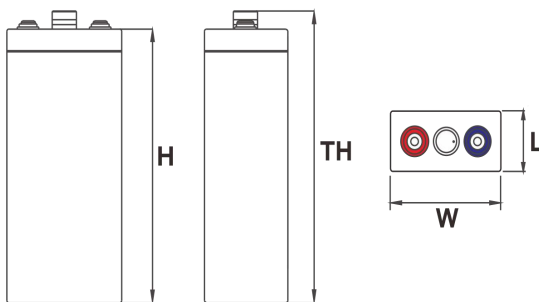

### Terminal

Unit:mm

Terminal Type I7

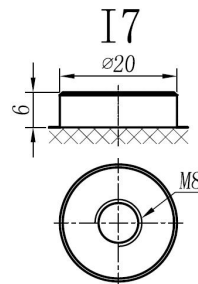

### Weight

14.7kg 32.41lbs



This document is subject to change without prior notification

Motive Battery  Energy Storage Battery

Reserve Battery  Motorcycle Battery



## 40PzV150

### Specificaion

<b>Nominal Voltage</b>	2V	
<b>Rated Capacity(25°C)</b>	159Ah	20hr Rate(1.80V/cell)
	150Ah	10hr Rate(1.80V/cell)
	132Ah	5hr Rate(1.75V/cell)
	119Ah	3hr Rate(1.70V/cell)
	86Ah	1hr Rate(1.60V/cell)
<b>Container Material</b>	ABS ( Fire-proofing ABS container available )	
<b>Operating Temperature Range</b>	<b>Discharge</b>	-20 ~ +50°C
	<b>Charge</b>	0 ~ +40°C
	<b>Storage</b>	-15 ~ +40°C
<b>Capacity Effected by Temperature</b>	<b>40°C / 104°F</b>	106%
	<b>25°C / 77°F</b>	100%
	<b>0°C / 32°F</b>	86%
	<b>-10°C / 14°F</b>	65%
<b>Charge Voltage</b>	<b>Float Voltage</b>	2.25 -2.30V/cell@25°C, Compensation Factor : -3mV/cell/°C
	<b>Equalize Voltage</b>	2.35 -2.40V/cell@25°C, Compensation Factor : -3mV/cell/°C
	<b>Cycle Voltage</b>	2.40 -2.50V/cell@25°C, Compensation Factor : -5mV/cell/°C
<b>Max Charging Current</b>	45A (0.3C)	
<b>Max. Discharge Current (5S)</b>	1200A	
<b>Internal Resistance</b>	1.3mΩ	
<b>Self Discharge</b>	<3%, TN series stored at 25 ° C require a supplementary charge every six months, the charging interval would shrink when the ambient temperature went higher	

### Discharge Performance

Constant Current Discharge Table (25°C/77°F) Unit: A										
F.V/Time	10min	15min	30min	1h	2h	3h	5h	8h	10h	20h
1.85V/cell	128.4	116.4	91.6	67.3	45.6	35.1	23.9	16.66	14.03	7.43
1.80V/cell	157.6	141.1	106.6	75.8	50.1	38.1	25.8	17.87	15.00	7.95
1.75V/cell	186.2	157.6	114.1	78.8	51.5	39.0	26.3	18.17	15.23	8.07
1.70V/cell	209.4	172.7	120.9	81.8	52.8	39.8	26.7	18.39	15.38	8.15
1.65V/cell	224.5	181.7	125.4	84.1	54.0	40.5	27.2	18.62	15.60	8.27
1.60V/cell	235.0	188.4	128.4	85.6	54.6	41.0	27.4	18.77	15.68	8.31

Constant Power Discharge Table (25°C/77°F) Unit: W										
F.V/Time	10min	15min	30min	1h	2h	3h	5h	8h	10h	20h
1.85V/cell	238.7	219.2	174.9	130.6	88.6	68.5	47.1	33.10	28.00	14.91
1.80V/cell	288.3	261.2	201.9	145.6	96.8	74.2	50.6	35.36	29.80	15.87
1.75V/cell	334.8	288.3	213.2	150.9	99.1	75.8	51.4	35.88	30.25	16.11
1.70V/cell	369.3	310.0	223.7	155.4	101.3	76.6	52.0	36.26	30.55	16.27
1.65V/cell	389.6	322.8	230.5	159.1	102.8	78.1	52.6	36.56	30.78	16.39
1.60V/cell	399.4	329.5	233.5	160.6	103.6	78.1	53.0	36.78	30.78	16.39

□ 动力电池

■ 储能电池

□ 备用电池

□ 摩托车电池



### 储能电池-管式胶体技术-OPzV系列

# 4OPzV150

## (2V 150Ah)

### 产品特点

- ◆ 20年设计浮充寿命
- ◆ 使用温度区间宽广,在-40°C至+60°C之间均可正常使用
- ◆ 管式正极板设计,大大延长使用寿命
- ◆ 气象二氧化硅凝胶电解质
- ◆ 铅钙板栅显著提升抗腐蚀能力
- ◆ 自放电率低,能够长时间放置保存
- ◆ 出色的深放电恢复能力



### 产品应用

- ◆ 不间断电源(UPS)
- ◆ 通信及电力设备
- ◆ 应急照明系统
- ◆ 安防及火灾报警系统
- ◆ 控制设备及其他工厂自动化设备
- ◆ 应急电源 (EPS)
- ◆ 照明设备

### 尺寸

单个尺寸

长	103±2mm
宽	206±2mm
高	355±3mm
总高	390±3mm

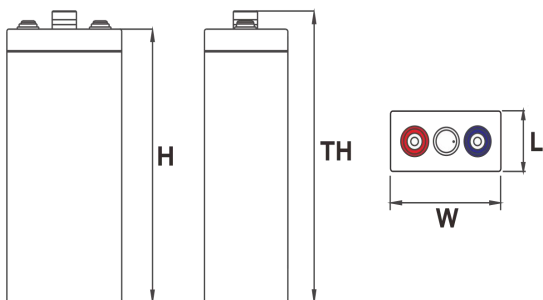

### 端子类型

单位:mm

端子类型 I7

### 重量

14.7kg 32.41lbs

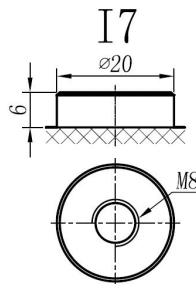

内容如有改动, 恕不另行通知

动力电池 储能电池 备用电池 摩托车电池

## 40PzV150

### 规格书

额定电压	2V	
容量(25°C)	159Ah	20hr Rate(1.80V/cell)
	150Ah	10hr Rate(1.80V/cell)
	132Ah	5hr Rate(1.75V/cell)
	119Ah	3hr Rate(1.70V/cell)
	86Ah	1hr Rate(1.60V/cell)
壳体材料	ABS (阻燃ABS壳体可选)	
使用温度范围	放电	-20 ~ +50°C
	充电	0 ~ +40°C
	储存	-15 ~ +40°C
不同温度下 电池容量系数	40°C / 104°F	106%
	25°C / 77°F	100%
	0°C / 32°F	86%
	-10°C / 14°F	65%
充电电压	浮充	2.25 - 2.30V/单格@25°C, 补偿系数: -3mV/单格/°C
	均充	2.35 - 2.40V/单格@25°C, 补偿系数: -3mV/单格/°C
	循环使用	2.40 - 2.50V/单格@25°C, 补偿系数: -5mV/单格/°C
最大充电电流	45A (0.3C)	
最大放电电流 (5S)	1200A	
电阻	1.3mΩ	
自放电	<3%, TN系列储存在25°C时需每6个月进行一次补充充电, 环境温度更高时则充电间隔时间越短	

### 放电性能

恒电流放电表 (25°C/77°F) 单位: A

F.V/Time	10min	15min	30min	1h	2h	3h	5h	8h	10h	20h
1.85V/cell	128.4	116.4	91.6	67.3	45.6	35.1	23.9	16.7	14.0	7.4
1.80V/cell	157.6	141.1	106.6	75.8	50.1	38.1	25.8	17.9	15.0	7.9
1.75V/cell	186.2	157.6	114.1	78.8	51.5	39.0	26.3	18.2	15.2	8.1
1.70V/cell	209.4	172.7	120.9	81.8	52.8	39.8	26.7	18.4	15.4	8.1
1.65V/cell	224.5	181.7	125.4	84.1	54.0	40.5	27.2	18.6	15.6	8.3
1.60V/cell	235.0	188.4	128.4	85.6	54.6	41.0	27.4	18.8	15.7	8.3

恒功率放电表 (25°C/77°F) 单位: W

F.V/Time	10min	15min	30min	1h	2h	3h	5h	8h	10h	20h
1.85V/cell	238.7	219.2	174.9	130.6	88.6	68.5	47.1	33.1	28.0	14.9
1.80V/cell	288.3	261.2	201.9	145.6	96.8	74.2	50.6	35.4	29.8	15.9
1.75V/cell	334.8	288.3	213.2	150.9	99.1	75.8	51.4	35.9	30.3	16.1
1.70V/cell	369.3	310.0	223.7	155.4	101.3	76.6	52.0	36.3	30.6	16.3
1.65V/cell	389.6	322.8	230.5	159.1	102.8	78.1	52.6	36.6	30.8	16.4
1.60V/cell	399.4	329.5	233.5	160.6	103.6	78.1	53.0	36.8	30.8	16.4