

Motive Battery  Energy Storage Battery

Reserve Battery  Motorcycle Battery



## Energy Storage Battery-Tubular GEL Technology-OPzV Series

# 16OPzV2000

## (2V 2000Ah)

### GENERAL FEATURES

- ◆ 20 years design life at floating condition
- ◆ Wide operating temperature range from -40°C to +60°C
- ◆ Tubular positive plate with prolonged cycle life
- ◆ Fumed silica gel electrolyte
- ◆ Lead calcium die case grid with improved corrosion resistance ability
- ◆ Low self-discharge rate and long shelf life
- ◆ Excellent deep discharge recovery capability



### Application

- ◆ Renewable energy system
- ◆ Hybrid solar power system
- ◆ Uninterrupted Power Supply ( UPS )
- ◆ Communications and electric equipment
- ◆ Emergency lighting equipment
- ◆ Fire alarm and security systems
- ◆ Control equipment, and other factory automation equipment
- ◆ Emergency power supply ( EPS )
- ◆ Lighting equipment

### Dimension

Unit:mm

Length 399±2mm / 15.71inch

Width 214±2mm / 8.43inch

Container Height 772±3mm / 30.39inch

Total Height 807±3mm / 31.77inch

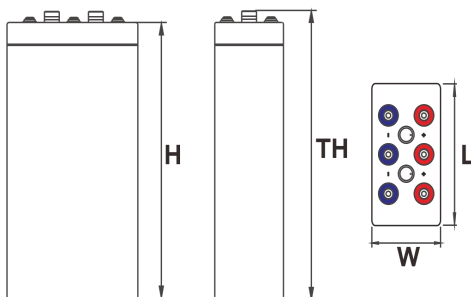

### Terminal

Unit:mm

Terminal Type I7

### Weight

155kg 341.71lbs

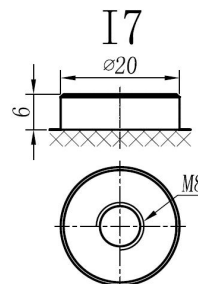

This document is subject to change without prior notification

Motive Battery  Energy Storage Battery

Reserve Battery  Motorcycle Battery



## 160PzV2000

### Specification

<b>Nominal Voltage</b>	2V	
<b>Rated Capacity(25°C)</b>	2120Ah	20hr Rate(1.80V/cell)
	2000Ah	10hr Rate(1.80V/cell)
	1712Ah	5hr Rate(1.75V/cell)
	1541Ah	3hr Rate(1.70V/cell)
	1132Ah	1hr Rate(1.60V/cell)
<b>Container Material</b>	ABS ( Fire-proofing ABS container available )	
<b>Operating Temperature Range</b>	<b>Discharge</b>	-20 ~ +50°C
	<b>Charge</b>	0 ~ +40°C
	<b>Storage</b>	-15 ~ +40°C
<b>Capacity Effected by Temperature</b>	40°C / 104°F	106%
	25°C / 77°F	100%
	0°C / 32°F	86%
	-10°C / 14°F	65%
<b>Charge Voltage</b>	<b>Float Voltage</b>	2.25 -2.30V/cell@25°C, Compensation Factor : -3mV/cell/°C
	<b>Equalize Voltage</b>	2.35 -2.40V/cell@25°C, Compensation Factor : -3mV/cell/°C
	<b>Cycle Voltage</b>	2.40 -2.50V/cell@25°C, Compensation Factor : -5mV/cell/°C
<b>Max Charging Current</b>	600A (0.3C)	
<b>Max. Discharge Current (5S)</b>	16000A	
<b>Internal Resistance</b>	0.25mΩ	
<b>Self Discharge</b>	<3%, TN series stored at 25 ° C require a supplementary charge every six months, the charging interval would shrink when the ambient temperature went higher	

### Discharge Performance

Constant Current Discharge Table (25°C/77°F) Unit: A

F.V/Time	10min	15min	30min	1h	2h	3h	5h	8h	10h	20h
1.85V/cell	1168.2	1140.1	1042.0	888.9	581.6	452.5	311.3	218.22	187.02	99.11
1.80V/cell	1437.4	1380.4	1215.2	1001.0	638.6	491.5	336.3	234.23	200.02	106.00
1.75V/cell	1699.7	1544.5	1294.3	1042.0	656.7	502.5	342.3	237.24	203.02	107.59
1.70V/cell	1907.9	1685.7	1370.4	1082.1	673.7	513.5	348.3	240.24	205.02	108.65
1.65V/cell	2049.0	1779.8	1425.4	1113.1	687.7	522.5	353.4	243.24	208.02	110.24
1.60V/cell	2144.1	1842.8	1461.5	1132.1	696.7	528.5	356.4	245.25	209.02	110.77

Constant Power Discharge Table (25°C/77°F) Unit: W

F.V/Time	10min	15min	30min	1h	2h	3h	5h	8h	10h	20h
1.85V/cell	2173.2	2142.1	1992.0	1719.7	1130.1	882.9	612.6	432.4	373.37	198.86
1.80V/cell	2626.6	2556.6	2298.3	1923.9	1235.2	956.0	658.7	462.5	397.40	211.66
1.75V/cell	3054.1	2821.8	2424.4	1989.0	1263.3	974.0	668.7	469.5	403.40	214.86
1.70V/cell	3366.4	3035.0	2540.5	2053.1	1289.3	990.0	676.7	474.5	407.41	216.99
1.65V/cell	3550.5	3157.2	2615.6	2097.1	1310.3	1003.0	684.7	478.5	410.41	218.60
1.60V/cell	3643.6	3221.2	2655.7	2120.1	1320.3	1011.0	689.7	481.5	413.41	220.19

□ 动力电池

■ 储能电池

□ 备用电池

□ 摩托车电池



### 储能电池-管式胶体技术-OPzV系列

# 16OPzV2000

## (2V 2000Ah)

### 产品特点

- ◆ 20年设计浮充寿命
- ◆ 使用温度区间宽广, 在-40°C至+60°C之间均可正常使用
- ◆ 管式正极板设计, 大大延长使用寿命
- ◆ 气象二氧化硅凝胶电解质
- ◆ 铅钙板栅显著提升抗腐蚀能力
- ◆ 自放电率低, 能够长时间放置保存
- ◆ 出色的深放电恢复能力



### 产品应用

- ◆ 不间断电源(UPS)
- ◆ 通信及电力设备
- ◆ 应急照明系统
- ◆ 安防及火灾报警系统
- ◆ 控制设备及其他工厂自动化设备
- ◆ 应急电源 (EPS)
- ◆ 照明设备

### 尺寸

单个尺寸

长	399±2mm
宽	214±2mm
高	772±3mm
总高	807±3mm

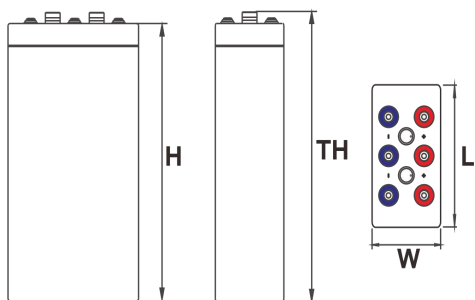

### 端子类型

单位:mm

端子类型 I7

### 重量

155kg 341.71lbs

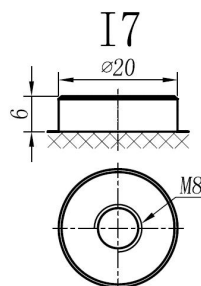

内容如有改动, 恕不另行通知

- 动力电池
- 储能电池
- 备用电池
- 摩托车电池



# 160PzV2000

## 规格书

<b>额定电压</b>	2V	
<b>容量(25°C)</b>	2120Ah	20hr Rate(1.80V/cell)
	2000Ah	10hr Rate(1.80V/cell)
	1712Ah	5hr Rate(1.75V/cell)
	1541Ah	3hr Rate(1.70V/cell)
	1132Ah	1hr Rate(1.60V/cell)
<b>壳体材料</b>	ABS (阻燃ABS壳体可选)	
<b>使用温度范围</b>	<b>放电</b>	-20 ~ +50°C
	<b>充电</b>	0 ~ +40°C
	<b>储存</b>	-15 ~ +40°C
<b>不同温度下 电池容量系数</b>	<b>40°C / 104°F</b>	106%
	<b>25°C / 77°F</b>	100%
	<b>0°C / 32°F</b>	86%
	<b>-10°C / 14°F</b>	65%
<b>充电电压</b>	<b>浮充</b>	2.25 -2.30V/单格@25°C, 补偿系数: -3mV/单格/°C
	<b>均充</b>	2.35 -2.40V/单格@25°C, 补偿系数: -3mV/单格/°C
	<b>循环使用</b>	2.40 -2.50V/单格@25°C, 补偿系数: -5mV/单格/°C
<b>最大充电电流</b>	600A (0.3C)	
<b>最大放电电流 (5S)</b>	16000A	
<b>电阻</b>	0.25mΩ	
<b>自放电</b>	<3%, TN系列储存在25°C时需每6个月进行一次补充充电, 环境温度更高时则充电间隔时间越短	

## 放电性能

恒电流放电表 (25°C/77°F) 单位: A										
F.V/Time	10min	15min	30min	1h	2h	3h	5h	8h	10h	20h
1.85V/cell	1168.2	1140.1	1042.0	888.9	581.6	452.5	311.3	218.2	187.0	99.1
1.80V/cell	1437.4	1380.4	1215.2	1001.0	638.6	491.5	336.3	234.2	200.0	106.0
1.75V/cell	1699.7	1544.5	1294.3	1042.0	656.7	502.5	342.3	237.2	203.0	107.6
1.70V/cell	1907.9	1685.7	1370.4	1082.1	673.7	513.5	348.3	240.2	205.0	108.7
1.65V/cell	2049.0	1779.8	1425.4	1113.1	687.7	522.5	353.4	243.2	208.0	110.2
1.60V/cell	2144.1	1842.8	1461.5	1132.1	696.7	528.5	356.4	245.2	209.0	110.8

恒功率放电表 (25°C/77°F) 单位: W										
F.V/Time	10min	15min	30min	1h	2h	3h	5h	8h	10h	20h
1.85V/cell	2173.2	2142.1	1992.0	1719.7	1130.1	882.9	612.6	432.4	373.4	198.9
1.80V/cell	2626.6	2556.6	2298.3	1923.9	1235.2	956.0	658.7	462.5	397.4	211.7
1.75V/cell	3054.1	2821.8	2424.4	1989.0	1263.3	974.0	668.7	469.5	403.4	214.9
1.70V/cell	3366.4	3035.0	2540.5	2053.1	1289.3	990.0	676.7	474.5	407.4	217.0
1.65V/cell	3550.5	3157.2	2615.6	2097.1	1310.3	1003.0	684.7	478.5	410.4	218.6
1.60V/cell	3643.6	3221.2	2655.7	2120.1	1320.3	1011.0	689.7	481.5	413.4	220.2