

# NPD2-3000Ah 2V3000Ah



### Specifications

Nominal Voltage	2V	
Rated capacity (10 hour rate)	3000Ah	
Dimensions	Length	710±3mm(27.95inch)
	Width	350±2mm(13.78inch)
	Height	345±2mm(13.58inch)
	Total Height	382±2mm(15.04inch)
Approx. Weight	191kg(421lbs)±3%	

### Outer dimensions (mm)

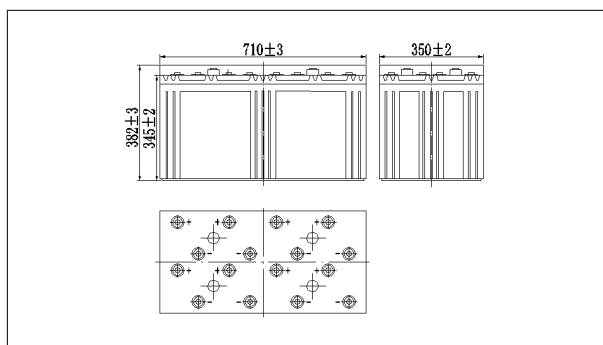

### Terminal Type (mm)

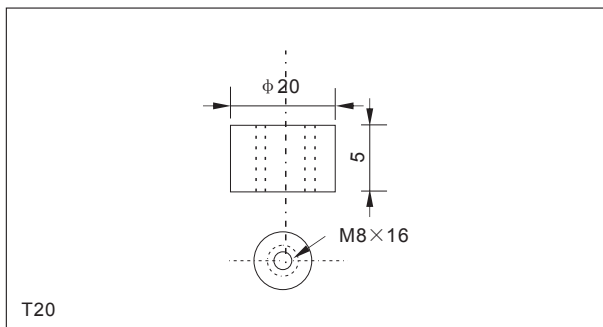

### Characteristics

Capacity (25°C)	10HR(1.8V)	3000Ah
	3HR(1.80V)	2340Ah
	1HR(1.75V)	1740Ah
Terminal type		T20
Internal resistance (Fully charged, 25°C)		Approx.0.11m Ω
Capacity affected by temperature (10HR)	40°C	102%
	25°C	100%
	0°C	85%
	-15°C	65%
Self-discharge (25°C)	3 months	Remaining Capacity:91%
	6 months	Remaining Capacity:82%
	12 months	Remaining Capacity:65%
Nominal operating temperature		25°C ±3°C(77°F ±5°F)
Operating temperature range	Discharge	-15°C~50°C(5°F~122°F)
	Charge	-10°C~50°C(14°F~122°F)
	Storage	-20°C~50°C(-4°F~122°F)
Float charging voltage(25°C)		2.25 to 2.30V Temperature compensation: -3mV/°C
Cyclic charging voltage(25°C)		2.40 to 2.50V Temperature compensation: -5mV/°C
Maximum charging current		600A
Maximum discharge current		15000A(5 sec.)
Designed floating life(20°C)		15 years

### Construction

Component	Positive plate	Negative plate	Container	Cover	Separator	Electrolyte	Safety valve	Terminal
Raw material	lead dioxide	Lead	ABS	ABS	AGM	Sulfuric acid	Rubber	Copper

### Constant Current Discharge Characteristics Unit:A(25°C,77°F)

F.V/Time	30min	60min	2h	3h	4h	5h	6h	8h	10h	20h	24h
1.60V	2839	1966	1150	827	662	570	490	387	319	168	144
1.65V	2782	1907	1143	823	658	566	487	384	319	168	144
1.70V	2697	1848	1133	817	654	562	484	382	318	168	143
1.75V	2632	1789	1116	811	649	558	480	379	316	167	143
1.80V	2535	1730	1087	787	629	542	466	368	314	165	142

### Constant Power Discharge Characteristics Unit:W(25°C,77°F)

F.V/Time	30min	60min	2h	3h	4h	5h	6h	8h	10h	20h	24h
1.60V	5309	3735	2219	1622	1297	1122	965	769	635	337	290
1.65V	5203	3623	2206	1612	1290	1116	960	765	634	336	289
1.70V	5044	3511	2186	1601	1281	1108	953	760	632	335	288
1.75V	4922	3399	2153	1590	1272	1100	947	754	628	333	287
1.80V	4741	3286	2098	1542	1234	1067	918	732	624	331	285

Note: The above characteristics data can be obtained within three charge or discharge cycles.

**NPD2-3000Ah 2V3000Ah**

● **Discharge characteristics(25°C)**

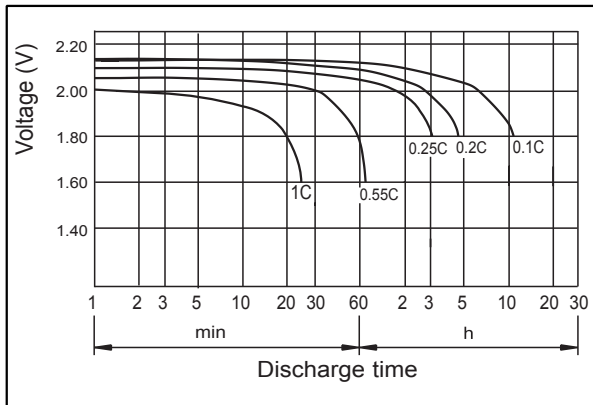

● **Charging characteristics**

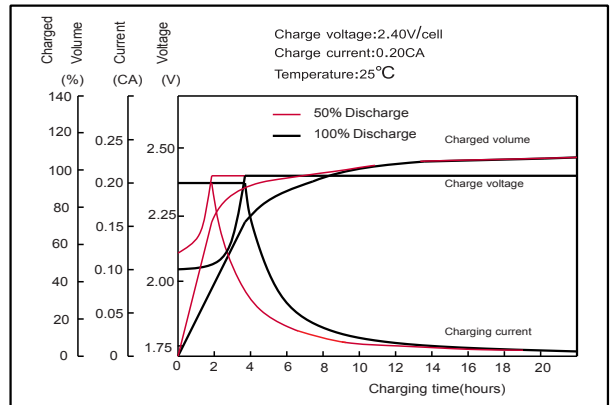

● **Effect of Temperature on Capacity**

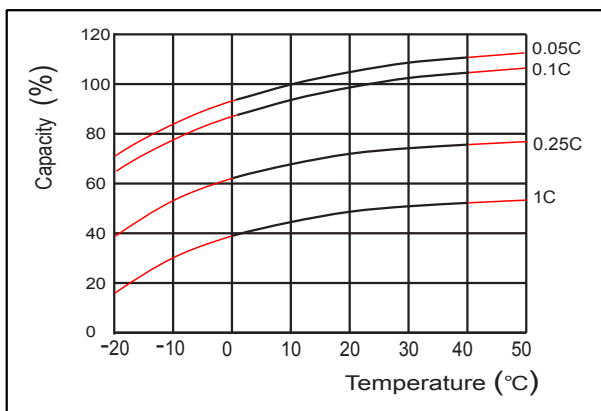

● **Self-discharge characteristics**

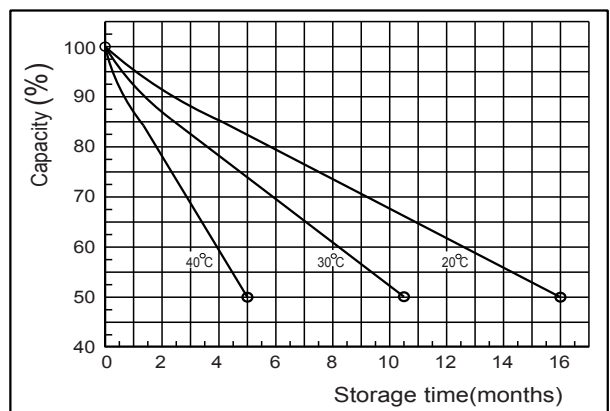

● **Temperature effects on float life**

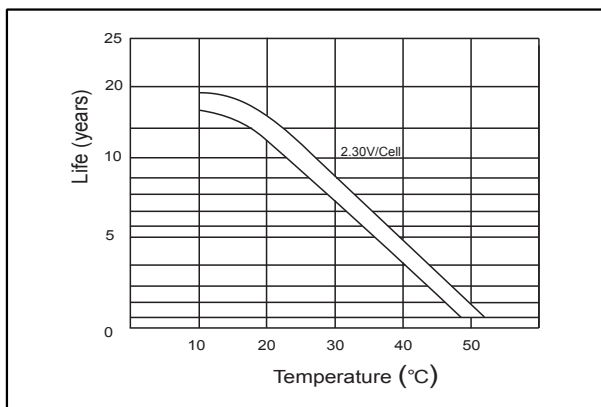

● **Cycle service life in relation to depth of discharge**

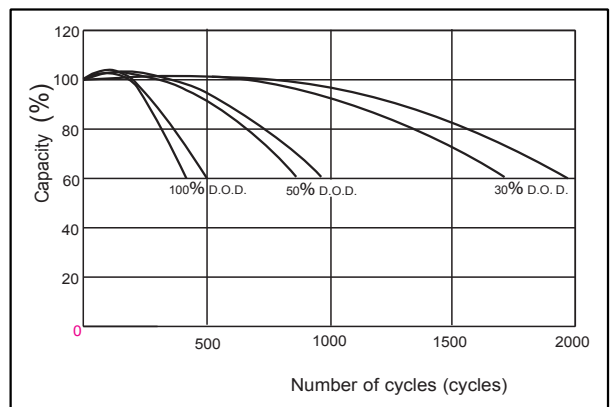

● **The relationship for OCV and Capacity (25°C)**

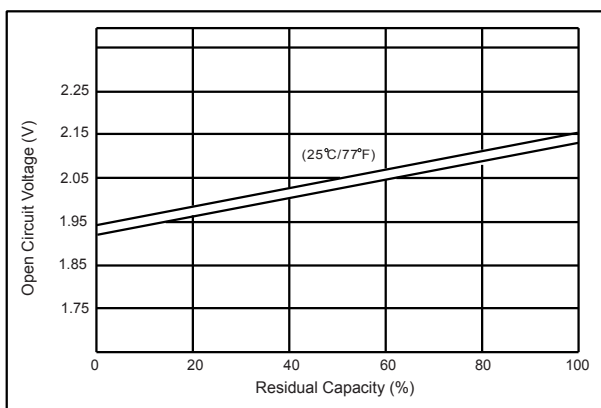

● **The relationship for Charging voltage and Temperature**

