

AJP-M636 Series 145W-160W Multi-Crystalline Photovoltaic Modules

Electrical Performance @ STC^{*1}

Maximum Power	Pmax[Wp]	145	150	155	160
Power Tolerance ^{*2}		+/-3%	+/-3%	+/-3%	+/-3%
Solar Cell Type		Multi-crystalline 6" (156 x 156 mm)			
Number of Solar Cells		36 (6 x 6)			
Maximum Power Voltage	Vmp[V]	18.06	18.31	18.66	18.91
Maximum Power Current	Imp[A]	8.03	8.19	8.31	8.46
Open Circuit Voltage	Voc[V]	22.53	22.71	23.01	23.19
Short Circuit Current Isc	Isc[A]	8.58	8.81	8.98	9.2
Module Efficiency	[%]	14.9%	15.4%	15.9%	16.5%

*1 STC: Irradiance level 1000 W/m²; Spectral AM1.5; Temperature 25°C

*2 Power tolerance can be adjusted upon requests

*3 NOCT: 46±2°C

IV Curve

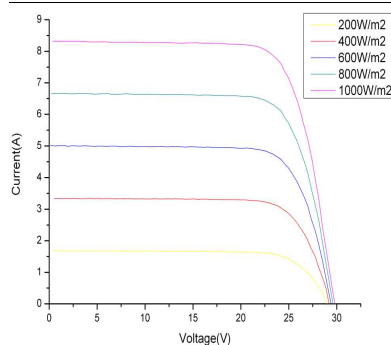

Mechanical Characteristics

Dimensions of the Module (W×H×D)(mm)	1474X660X35
Weight of the Module(kg)	12
Junction box	IP 65 / IP 67 with 2 bypass diodes ; cables 1M/φ 4mm ²
Series fuse rating Inside Junction Box	15A

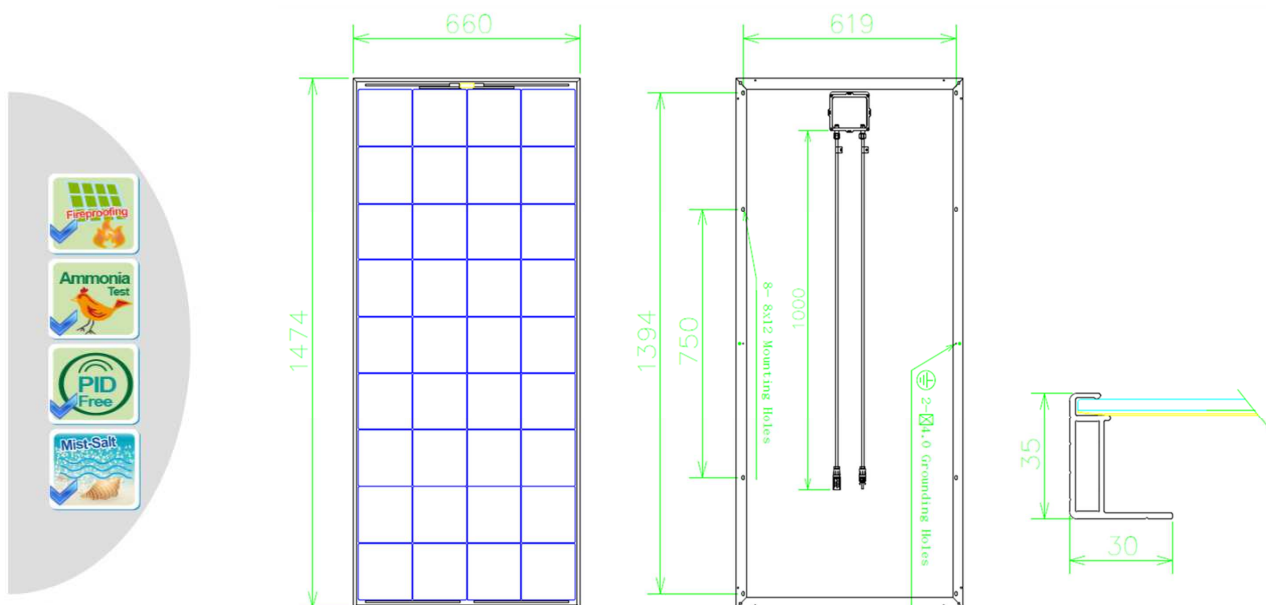

Warranty

Product Warranty:

5 years for material and workmanship

Performance Guarantee:

90% for 10 years Guaranteed output

80% for 25 years Guaranteed output

Working Condition

Maximum System Voltage: 600V, 1000V

Operating Temperature: -40 ~ 85°C

Maximum Static Load: Snow load 5400pa

Wind load 2400pa

Temperature Coefficient

Isc Temperature Coefficient: α(%/°C) +0.08

Voc Temperature Coefficient: β(%/°C) -0.34

Pmax Temperature Coefficient(γ(%/°C) -0.43

Certificate



Anji Technology Co., LTD

No.21 Keji 5th Road, Annan District, Tainan 709, Taiwan

Tel: +886 6 5105988

Fax: +886 6 510 5989

E-mail: service@anjitek.com

* Specification are subject to change without notice

web-link: www.anjitek.com

