

# Single Phase Units

- Maximum PV voltage up to 600Vdc
- DC / AC ration up to 1.35
- Type II DC Surge Protection Device
- Type III AC Surge Protection Device
- IP 65 Protection
- can be operated as part of a large PV on grid system
- WiFi / 4G Plug
- High Efficiency (>98.3%)
- Compact and light

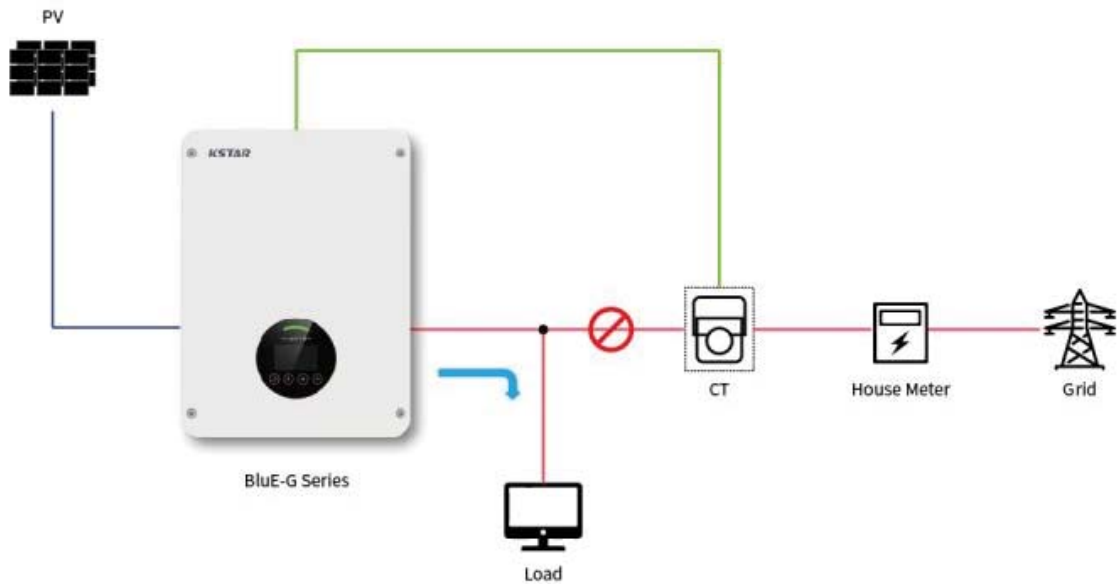

Fig.1: Recommended Installation Topology for both single and three phase units

# Specifications

Specifications for single phase units from 3KWac to 6KWac:

MODEL	PVIE3-3KI	PVIE3-3K6I	PVIE3-4KI	PVIE3-5KI	PVIE3-6KI	PVIE3-8KI	PVIE3-10KI	PVIE-12KI
<b>Input(DC)</b>								
Max. recommended PV power	6000W	7200W	8000W	10000W	10000W	12000W	15000W	18000W
Max. DC voltage	1100V	1100V	1100V	1100V	1100V	1100V	1100V	1100V
Nominal voltage	600V	600V	600V	600V	600V	600V	600V	600V
Start voltage	180V	180V	180V	180V	180V	180V	180V	180V
MPPT voltage range	140 V~1,000 V	140 V~1,000 V	140 V~1,000 V	140 V~1,000 V	140 V~1,000 V	140 V~1,000 V	140 V~1,000 V	140 V~1,000 V
Number of MPP tracker	2	2	2	2	2	2	2	2
Strings per MPP tracker	1	1	1	1	1	1	1	1
Max. input current per MPPT	15A	15A	15A	15A	15A	15A	15A	15A
Max. short-circuit current per MPPT	25A	25A	25A	25A	25A	25A	25A	25A
<b>Output(AC)</b>								
Nominal AC output power	3000W	3600W	4000W	5000W	6000W	8000W	10000W	12000W
Maximum AC output power	3300VA	4000VA	4400VA	5500VA	6600VA	8800VA	11000VA	13200VA
Nominal AC voltage	400V 3L+N							
AC grid frequency range	50 / 60Hz(±5Hz)							
Maximum output current	4.8A	6.1A	6.8A	8.5A	10.1A	13.5A	16.9A	20A
Power factor(Φ)	0.8leading-0.8lagging							
THDi	3%							
<b>Efficiency</b>								
Max. efficiency	98.4%	98.4%	98.4%	98.4%	98.4%	98.6%	98.6%	98.6%
Euro efficiency	97.5%	97.5%	97.5%	97.5%	97.5%	98%	98.1%	98.1%
<b>Protection devices</b>								
DC switch	Yes							
Output over current	Yes							
Anti-islanding protection	Yes							
DC reverse polarity protection	Yes							
String fault Detection	Yes							
AC/DC surge protection	Type II							
Insulation detection	Yes							
AC short circuit protection	Yes							
<b>General Specifications</b>								
Dimensions W x H x D (mm)	380x483x161							
Weight(kg)	<18							
Operating temperature range	-25°C~+60°C							
Cooling type	Natural cooling							
Max. operation altitude	4000m							
Max. operation humidity	0-100%(No condensation)							
AC Output terminal type	Connector							
IP class	IP65							
Topology	Transformer-less							
Communication	RS485/Wifi/4G							
Display	LCD							
Certification & Standard	EN/IEC62109-1/2 ; IEC/EN61000-6-2;IEC/EN61000-6-4;IEC61683;IEC60068;IEC60529;IEC62116;IEC61727; ...							