



## HPBC MONOCRYSTALLINE SOLAR PANEL PVS-590W/600W-M10HDT



### Introduction:

Redefined the high-efficiency module series by integrating 182mm silicon wafers with HPBC cell technologies. Our panel combined creative technology effectively and extremely improved the module efficiency and power output.

### Key Features:

- Less mismatch to get more power
- Less power loss by minimizing the shading impact
- Competitive low light performance
- 3 times EL test to ensure best quality
- Anti-PID
- Ideal choice for utility and commercial scale projects by reduced BoS and improved ROI
- Outstanding reliability proven by PVEL for stringent Environment condition: Sand, acid, salt and hail stones, 2400Pa wind load and 5400Pa snow load

**Electrical Characteristics:** STC: Irradiance 1000 W/m<sup>2</sup> module temperature 25 C AM=1.5

| Module Type                 | PVS-590W-M10HDT | PVS-600W-M10HDT |
|-----------------------------|-----------------|-----------------|
| Maximum Power (Pmp)         | 585W            | 600W            |
| Open Circuit Voltage (Voc)  | 52.49V          | 52.79V          |
| Short Circuit Current (Isc) | 14.34A          | 14.47A          |
| Maximum Power Voltage (Vmp) | 44.38V          | 44.68V          |
| Maximum Power Current (Imp) | 13.30A          | 13.43A          |
| Module Efficiency at STC(%) | 22.8%           | 23.2%           |
| Maximum System Voltage      | 1500VDC         |                 |
| Maximum Series Fuse Rating  | 25A             |                 |
| Power Tolerance             | 0~+3%           |                 |

### Current-Voltage Characteristic (I-V Curve)

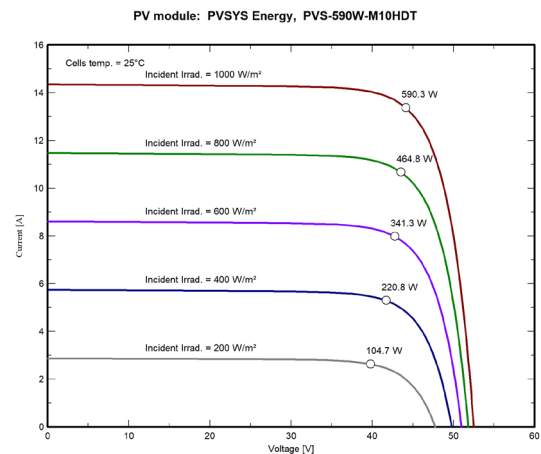

### Mechanical Specifications:

|                     |                                       |
|---------------------|---------------------------------------|
| External Dimensions | 2278x1134x35 mm                       |
| Solar Cells         | Mono 144cells(6*24)                   |
| Front Glass         | 3.2mm tempered glass                  |
| Frame               | Anodized aluminum alloy               |
| Junction Box        | IP68, 3 diodes                        |
| Output Cables       | 4.0mm <sup>2</sup>                    |
| Weight              | 27.5kg                                |
| Mechanical Load     | Front side 5400Pa<br>Rear side 2400Pa |
| Packing             | 31pcs/pallet, 620pcs/40HQ             |

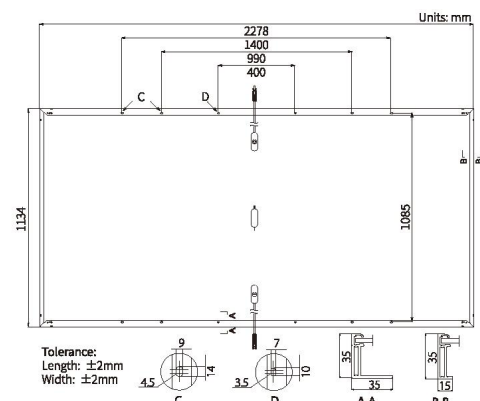

### Temperature ratings (STC):

|                                 |            |
|---------------------------------|------------|
| Temperature Coefficient of Isc  | +0.050%/°C |
| Temperature Coefficient of Voc  | -0.230%/°C |
| Temperature Coefficient of Pmax | -0.290%/°C |

### Product warranty:

15 years guarantee on product material and workmanship  
 25 years guarantee on Liner power output

**Quality Standard:** IEC61215-1-1:2021, IEC61730-1 :2018, IEC61730-2:2018, Fire safety Class C