



FROM STRENGTH TO STRENGTH IN NATURE

# NESE 550-72MH-M10

## MONO PERC HALF-CELL SOLAR MODULE

FROM CAMBODIA

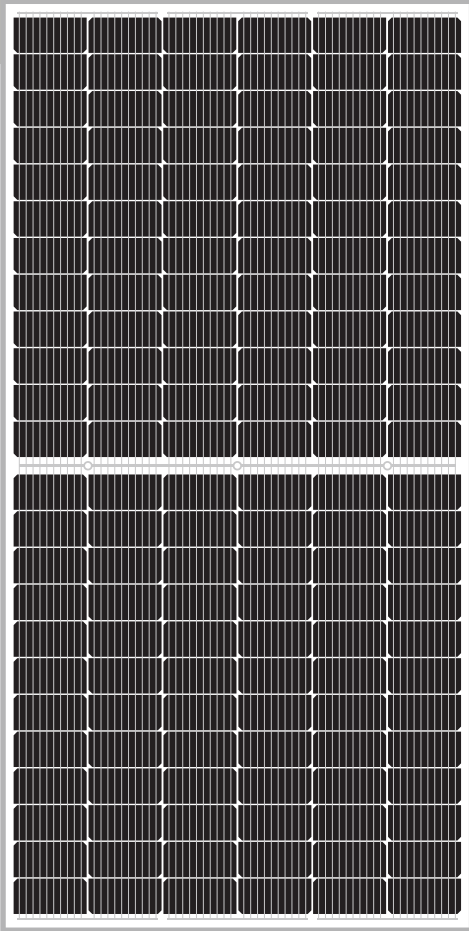

### KEY FEATURES



#### High efficiency PERC

A high efficiency 182 (M10) PERC solar cell with 10 busbars technology to ensure the efficiency of the solar module up to 21.29% and stable operation.



#### 0-5W tolerance

0- 5W positive power tolerance.



#### Excellent performance with weak light

More power output with a weak light condition-through advanced glass and solar cells.



#### Wind/Snow load

Wind load 2400 pa, snow load 5400 pa.



#### Pid Free

Excellent Anti-PID performance, minimized the degradation of power.



#### Resistance of extreme environment conditions

High Salt Mist and Ammonia resistance certified by TUV.

### INSURED BY

CHUBB® Munich RE 

### LINEAR PERFORMANCE WARRANTY

12 years product warranty. 25 years linear power warranty.

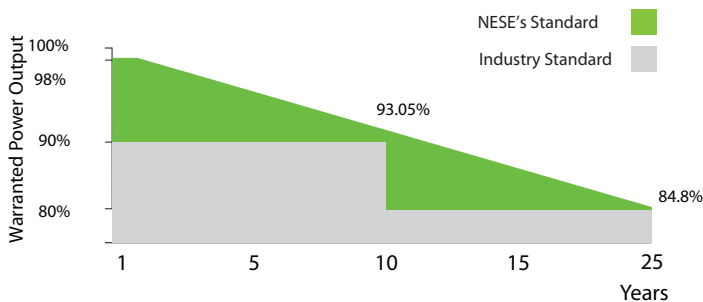

### MANAGEMENT SYSTEM CERTIFICATES

ISO 9001:2015/QUALITY MANAGEMENT SYSTEM  
ISO 14001:2015/STANDARDS FOR ENVIRONMENTAL MANAGEMENT SYSTEM

### PRODUCT CERTIFICATES

IEC 61215/IEC 61730:VDE/CE/CEC AU  
UL 61730: CSA



PHUM TANOUN, SANGKAT KOMBOUL, KHAN POSENCHAY, PHNOM PENH, KINGDOM OF CAMBODIA

WWW.NESOLAR.COM.KH

# SPECIFICATIONS

Module type	NESE 530-72MH-M10		NESE 535-72MHM10		NESE 540-72MHM10		NESE 545-72MHM10		NESE 550-72MHM10	
	STC	(NOCT)	STC	(NOCT)	STC	(NOCT)	STC	(NOCT)	STC	(NOCT)
Maximum power(Pmax)	530Wp	396Wp	535Wp	400Wp	540Wp	404Wp	545Wp	407Wp	550Wp	411Wp
Maximum power voltage(Vmp)	41.0V	38.2V	41.2V	38.3V	41.4V	38.5V	41.6V	38.7V	41.8V	38.9V
Maximum power current (Imp)	12.94A	10.39A	13.00A	10.43A	13.05A	10.48A	13.11A	10.52A	13.16A	10.57A
Open-circuit voltage( Voc)	49.3V	46.1V	49.5V	46.2V	49.7V	46.4V	49.9V	46.6V	50.1V	46.8V
Short-circuit current(Isc)	13.66A	11.03A	13.72A	11.08A	13.78A	11.13A	13.84A	11.18A	13.90A	11.22A
Module efficiency STC (%)	20.52%		20.71%		20.90%		21.10%		21.29%	
Operating temperature(°C)	-40°C ~ 85°C									
Maximum system voltage	1500 (IEC&UL)									
Maximum series fuse rating	25A									
Sorting power tolerance	0 ~ +3%									
Temperature coefficients of Pmax	-0.35%/°C									
Temperature coefficients of Voc	-0.29%/°C									
Temperature coefficients of Isc	+0.05%/°C									
Nominal operating cell temperature(NOCT)	44 ± 2°C									

## ENGINEERING DRAWING

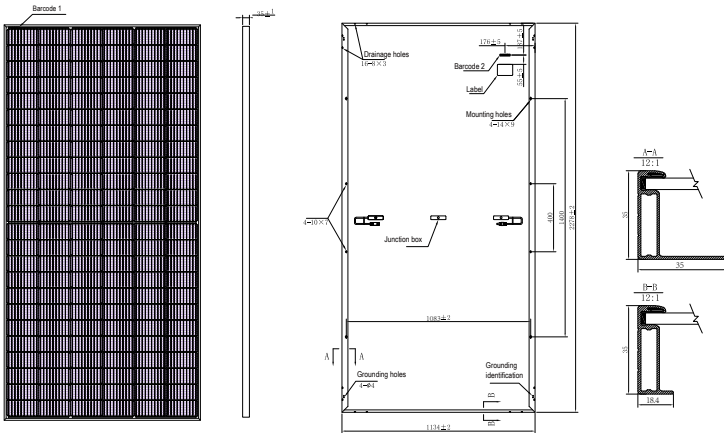

## MATERIAL CHARACTERISTICS

Number of cell	144 (6 * 24)
Dimensions	2278*1134*35
Weight	28+/-1kg
Front glass	3.2mm, anti-reflection Coating, high transmission, low iron, tempered glass
Frame	Anodized aluminium alloy

## IV CURVES OF THE PV MODULES

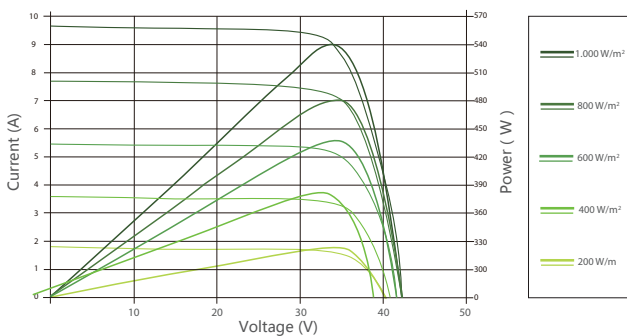

Junction box	IP68 rated 3 Diodes
Output cables	12 awg, length: 350-1200 mm (13.78-47.24 inch) or Customized length
Connectors	MC4-Compatible or Customized

## PACKAGING CONFIGURATION

40HQ	620PCS
------	--------

Electrical performance vs Incident Irradiance  
Current-voltage & power-voltage curves (540W)