

JS-N-TOPCon SERIES

Excellent
performance

420-435W

● QUALITY SYSTEM

ISO9001 / ISO14001 / ISO45001

● PRODUCT CERTIFICATION



MCS

CGC

● WARRANTY

JS Solar's performance Warranty

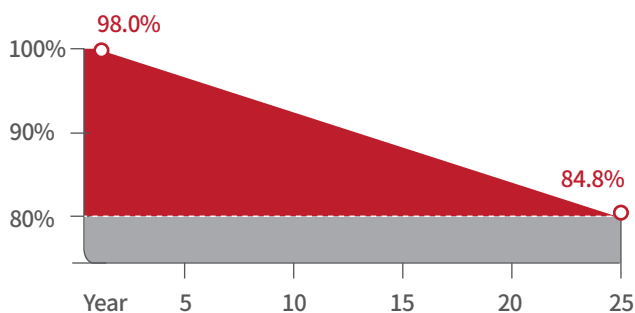

● N-TOPCON MODULE ADVANTAGE



Reduce heat spot effect



Multi-main gate technology



Excellent low-light performance



Higher bifacially



High module conversion
Efficiency



25-year power warranty

Electrical Characteristics

Module Type	JS420N108FB		JS425N108FB		JS430N108FB		JS435N108FB	
	STC	NOCT	STC	NOCT	STC	NOCT	STC	NOCT
Maximum Power at STC (Pmp)	420	316	425	320	430	324	435	328
Open Circuit Voltage (Voc)	38.50	36.58	38.70	36.77	38.90	36.96	39.10	37.15
Short Circuit Current (Isc)	13.83	11.06	13.91	11.13	13.99	11.19	14.07	11.26
Maximum Power Voltage (Vmp)	31.90	29.99	32.10	30.21	32.30	30.41	32.50	30.62
Maximum Power Current (Imp)	13.17	10.54	13.24	10.59	13.32	10.66	13.39	10.71
Module Efficiency at STC(%)	21.51		21.76		22.02		22.28	
Power Tolerance	(0, +4.99W)							
Maximum System Voltage	1500V DC							
Maximum Series Fuse Rating	25 A							

STC: Irradiance 1000 W/m² module temperature 25°C AM=1.5
Power measurement tolerance: +/-3%

Temperature Characteristics

Pmax Temperature Coefficient	-0.30 %/°C
Voc Temperature Coefficient	-0.25 %/°C
Isc Temperature Coefficient	+0.046 %/°C
Operating Temperature	-40~+85 °C
Nominal Operating Cell Temperature(NOCT)	45±2 °C

Mechanical Specifications

External Dimensions	1722 x 1134 x 30mm
Weight	19.0kg
Solar Cells	N-TOPCon 182 x 91mm (108 pcs)
Front Glass	3.2mm AR coating tempered glass, low iron
Frame	Anodized aluminium alloy
Junction Box	IP68, 3 diodes
Output Cables	4.0mm ² , 250mm(+)/350mm(-) or Customized Length
Mechanical Load	Front side 5400Pa/ Rear side 2400Pa

Packing Configuration

1722 x 1134 x 30mm		
Container	20'GP	40'HQ
Pieces per Pallet	36	36
Pallets per Container	6	26
Pieces per Container	216	936

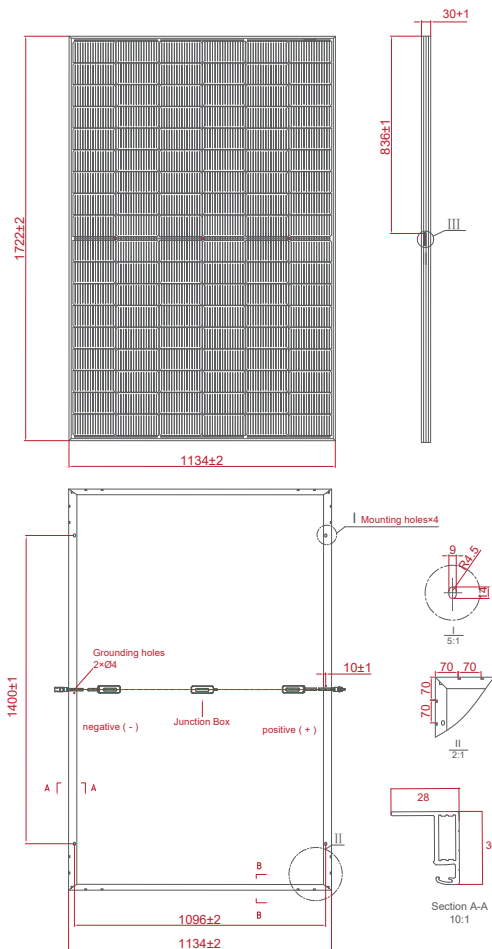

I-V Curve

