



/ SC 4000 UP / SC 4200 UP / SC 4400 UP / SC 4600 UP



# Sunny Central UP

The new Sunny Central: more power per cubic meter

## Efficient

- Up to 4 inverters can be transported in one standard shipping container
- Overdimensioning up to 200% is possible
- Full power at ambient temperatures of up to 35°C

## Robust

- Intelligent air cooling system OptiCool for efficient cooling
- Suitable for outdoor use in all climatic ambient conditions worldwide

## Flexible

- One device for all applications
- PV application with DC-coupled battery-storage system and charging from the AC utility as an option

## Easy to Use

- Improved DC connection area
- Connection area for customer equipment
- Integrated voltage support for internal and external loads

**With an output of up to 4600 kVA and system voltages of 1500 V DC, the SMA central inverter allows for more efficient system design and a reduction in specific costs for PV and battery power plants.**

A separate voltage supply and additional space are available for the installation of customer equipment. True 1500 V technology and the intelligent cooling system OptiCool ensure smooth operation even in extreme ambient temperature as well as a long service life of 25 years.

# SUNNY CENTRAL UP

Technical Data	SC 4000 UP	SC 4200 UP
<b>DC side</b>		
MPP voltage range $V_{DC}$ (at 25 °C / at 50 °C)	880 to 1325 V / 1050 V	921 to 1325 V / 1050 V
Min. DC voltage $V_{DC, min}$ / Start voltage $V_{DC, Start}$	849 V / 1030 V	891 V / 1071 V
Max. DC voltage $V_{DC, max}$	1500 V	1500 V
Max. DC current $I_{DC, max}$	4750 A	4750 A
Max. short-circuit current $I_{DC, SC}$	8400 A	8400 A
Number of DC inputs	Busbar with 26 connections per terminal, 24 double pole fused (32 single pole fused)	
Number of DC inputs with optional DC coupled storage	18 double pole fused (36 single pole fused) for PV and 6 double pole fused for batteries	
Max. number of DC cables per DC input (for each polarity)	2 x 800 kcmil, 2 x 400 mm <sup>2</sup>	
Integrated zone monitoring	○	
Available PV fuse sizes (per input)	200 A, 250 A, 315 A, 350 A, 400 A, 450 A, 500 A	
Available battery fuse size (per input)	750 A	
<b>AC side</b>		
Nominal AC power at $\cos \varphi = 1$ (at 35 °C / at 50 °C)	4000 kVA <sup>1)2)</sup> / 3600 kVA	4200 kVA <sup>1)2)</sup> / 3780 kVA
Nominal AC active power at $\cos \varphi = 0.8$ (at 35 °C / at 50 °C)	3200 kW <sup>1)2)</sup> / 2880 kW	3360 kW <sup>1)2)</sup> / 3024 kW
Nominal AC current $I_{AC, nom}$ (at 35 °C / at 50 °C)	3850 A / 3465 A	3850 A / 3465 A
Max. total harmonic distortion	< 3% at nominal power	< 3% at nominal power
Nominal AC voltage / AC voltage range <sup>1) 8)</sup>	600 V / 480 V to 720 V	630 V / 504 V to 756 V
AC power frequency / range	50 Hz / 47 Hz to 53 Hz 60 Hz / 57 Hz to 63 Hz > 2	
Min. short-circuit ratio at the AC terminals <sup>9)</sup>	1 / 0.8 overexcited to 0.8 underexcited	
Power factor at rated power / displacement power factor adjustable <sup>8) 10)</sup>	1 / 0.8 overexcited to 0.8 underexcited	
<b>Efficiency</b>		
Max. efficiency <sup>2)</sup> / European efficiency <sup>2)</sup> / CEC efficiency <sup>3)</sup>	98.8% / 98.6% / 98.5%	98.8% / 98.7% / 98.5%
<b>Protective Devices</b>		
Input-side disconnection point	DC load break switch	
Output-side disconnection point	AC circuit breaker	
DC overvoltage protection	Surge arrester, type I & II	
AC overvoltage protection (optional)	Surge arrester, class I & II	
Lightning protection (according to IEC 62305-1)	Lightning Protection Level III	
Ground-fault monitoring / remote ground-fault monitoring	○ / ○	
Insulation monitoring	○	
Degree of protection: electronics / air duct / connection area (as per IEC 60529)	IP54 / IP34 / IP34	
<b>General Data</b>		
Dimensions (W / H / D)	2815 / 2318 / 1588 mm (110.8 / 91.3 / 62.5 inch)	
Weight	< 3700 kg / < 8158 lb	
Self-consumption (max. <sup>4)</sup> / partial load <sup>5)</sup> / average <sup>6)</sup>	< 8100 W / < 1800 W / < 2000 W	
Self-consumption (standby)	< 370 W	
Internal auxiliary power supply	○ Integrated 8.4 kVA transformer	
Operating temperature range (optional) <sup>8)</sup>	(-40 °C) -25 °C to 60 °C / (-40 °F) -13 °F to 140 °F	
Noise emission <sup>7)</sup>	65.0 dB(A)	
Temperature range (standby)	-40 °C to 60 °C / -40 °F to 140 °F	
Temperature range (storage)	-40 °C to 70 °C / -40 °F to 158 °F	
Max. permissible value for relative humidity (condensing / non-condensing)	95% to 100% (2 month/year) / 0% to 95%	
Maximum operating altitude above MSL <sup>8)</sup> 1000 m / 2000 m <sup>11)</sup> / 3000 m <sup>11)</sup>	● / ○ / ○      ● / ○ / -	
Fresh air consumption	6500 m <sup>3</sup> /h	
<b>Features</b>		
DC connection	Terminal lug on each input (without fuse)	
AC connection	With busbar system (three busbars, one per line conductor)	
Communication	Ethernet, Modbus Master, Modbus Slave	
Enclosure / roof color	RAL 9016 / RAL 7004	
Supply for external loads	○ (2.5 kVA)	
Standards and directives complied with	AR-N 4110, AR-N 4120 <sup>13)</sup> , Arrêté du 23/04/08, CE, IEC / EN 62109-1, IEC / EN 62109-2, IEEE1547, UL 840 Cat. IV	
EMC standards	IEC 55011, IEC 61000-6-2, FCC Part 15 Class A	
Quality standards and directives complied with	VDI/VDE 2862 page 2, DIN EN ISO 9001	
● Standard features   ○ Optional   - not available		
Type designation	SC 4000 UP	SC 4200 UP

Technical Data	SC 4400 UP	SC 4600 UP
<b>DC side</b>		
MPP voltage range $V_{DC}$ (at 25 °C / at 50 °C)	962 to 1325 V / 1050 V	1003 to 1325 V / 1050 V
Min. DC voltage $V_{DC, min}$ / Start voltage $V_{DC, Start}$	934 V / 1112 V	976 V / 1153 V
Max. DC voltage $V_{DC, max}$	1500 V	1500 V
Max. DC current $I_{DC, max}$	4750 A	4750 A
Max. short-circuit current $I_{DC, SC}$	8400 A	8400 A
Number of DC inputs	Busbar with 26 connections per terminal, 24 double pole fused (32 single pole fused)	
Number of DC inputs with optional DC coupled storage	18 double pole fused (36 single pole fused) for PV and 6 double pole fused for batteries	
Max. number of DC cables per DC input (for each polarity)	2 x 800 kcmil, 2 x 400 mm <sup>2</sup>	
Integrated zone monitoring	○	
Available PV fuse sizes (per input)	200 A, 250 A, 315 A, 350 A, 400 A, 450 A, 500 A	
Available battery fuse size (per input)	750 A	
<b>AC side</b>		
Nominal AC power at $\cos \varphi = 1$ (at 35 °C / at 50 °C)	4400 kVA <sup>12)</sup> / 3960 kVA	4600 kVA <sup>12)</sup> / 4140 kVA
Nominal AC active power at $\cos \varphi = 0.8$ (at 35 °C / at 50 °C)	3520 kW <sup>12)</sup> / 3168 kW	3680 kW <sup>12)</sup> / 3312 kW
Nominal AC current $I_{AC, nom}$ (at 35 °C / at 50 °C)	3850 A / 3465 A	3850 A / 3465 A
Max. total harmonic distortion	< 3% at nominal power	
Nominal AC voltage / AC voltage range <sup>1) 8)</sup>	660 V / 528 V to 759 V	690 V / 552 V to 759 V
AC power frequency / range	50 Hz / 47 Hz to 53 Hz 60 Hz / 57 Hz to 63 Hz > 2	
Min. short-circuit ratio at the AC terminals <sup>9)</sup>	> 2	
Power factor at rated power / displacement power factor adjustable <sup>8) 10)</sup>	● 1 / 0.8 overexcited to 0.8 underexcited	
<b>Efficiency</b>		
Max. efficiency <sup>2)</sup> / European efficiency <sup>2)</sup> / CEC efficiency <sup>3)</sup>	98.8% / 98.7% / 98.5%	98.9% / 98.7% / 98.5%
<b>Protective Devices</b>		
Input-side disconnection point	DC load break switch	
Output-side disconnection point	AC circuit breaker	
DC overvoltage protection	Surge arrester, type I & II	
AC overvoltage protection (optional)	Surge arrester, class I & II	
Lightning protection (according to IEC 62305-1)	Lightning Protection Level III	
Ground-fault monitoring / remote ground-fault monitoring	○ / ○	
Insulation monitoring	○	
Degree of protection: electronics / air duct / connection area (as per IEC 60529)	IP54 / IP34 / IP34	
<b>General Data</b>		
Dimensions (W / H / D)	2815 / 2318 / 1588 mm (110.8 / 91.3 / 62.5 inch)	
Weight	< 3700 kg / < 8158 lb	
Self-consumption (max. <sup>4)</sup> / partial load <sup>5)</sup> / average <sup>6)</sup>	< 8100 W / < 1800 W / < 2000 W	
Self-consumption (standby)	< 370 W	
Internal auxiliary power supply	○ Integrated 8.4 kVA transformer	
Operating temperature range (optional) <sup>8)</sup>	(-40 °C) -25 °C to 60 °C / (-40 °F) -13 °F to 140 °F	
Noise emission <sup>7)</sup>	65.0 dB(A)	
Temperature range (standby)	-40 °C to 60 °C / -40 °F to 140 °F	
Temperature range (storage)	-40 °C to 70 °C / -40 °F to 158 °F	
Max. permissible value for relative humidity (condensing / non-condensing)	95% to 100% (2 month/year) / 0% to 95%	
Maximum operating altitude above MSL <sup>8)</sup> 1000 m / 2000 m <sup>11)</sup> / 3000 m <sup>11)</sup>	● / ○ / -	
Fresh air consumption	6500 m <sup>3</sup> /h	
<b>Features</b>		
DC connection	Terminal lug on each input (without fuse)	
AC connection	With busbar system (three busbars, one per line conductor)	
Communication	Ethernet, Modbus Master, Modbus Slave	
Enclosure / roof color	RAL 9016 / RAL 7004	
Supply for external loads	○ (2.5 kVA)	
Standards and directives complied with	AR-N 4110, AR-N 4120 <sup>13)</sup> , Arrêté du 23/04/08, CE, IEC / EN 62109-1, IEC / EN 62109-2, IEEE1547, UL 840 Cat. IV	
EMC standards	IEC 55011, IEC 61000-6-2, FCC Part 15 Class A	
Quality standards and directives complied with	VDI/VDE 2862 page 2, DIN EN ISO 9001	
● Standard features ○ Optional – not available		
Type designation	SC 4400 UP	SC 4600 UP

1) At grid voltage lower than nominal AC voltage, the nominal AC power decreases in the same proportion

2) Efficiency measured without internal power supply

3) Efficiency measured with internal power supply

4) Self-consumption at rated operation

5) Self-consumption at < 75% P<sub>n</sub> at 25 °C

6) Self-consumption averaged out from 5% to 100% P<sub>n</sub> at 25 °C

7) Sound pressure level at a distance of 10 m

8) Values apply only to inverters. Permissible values for SMA MV solutions from SMA can be found in the corresponding data sheets.

9) A short-circuit ratio of < 2 requires a special approval from SMA

10) Depending on the DC voltage

11) Earlier temperature-dependent de-rating and reduction of DC open-circuit voltage

12) Nominal AC power at 35 °C achievable up to a maximum of 1050 V<sub>DC</sub>

13) except SC 4600 UP

# SYSTEM DIAGRAM

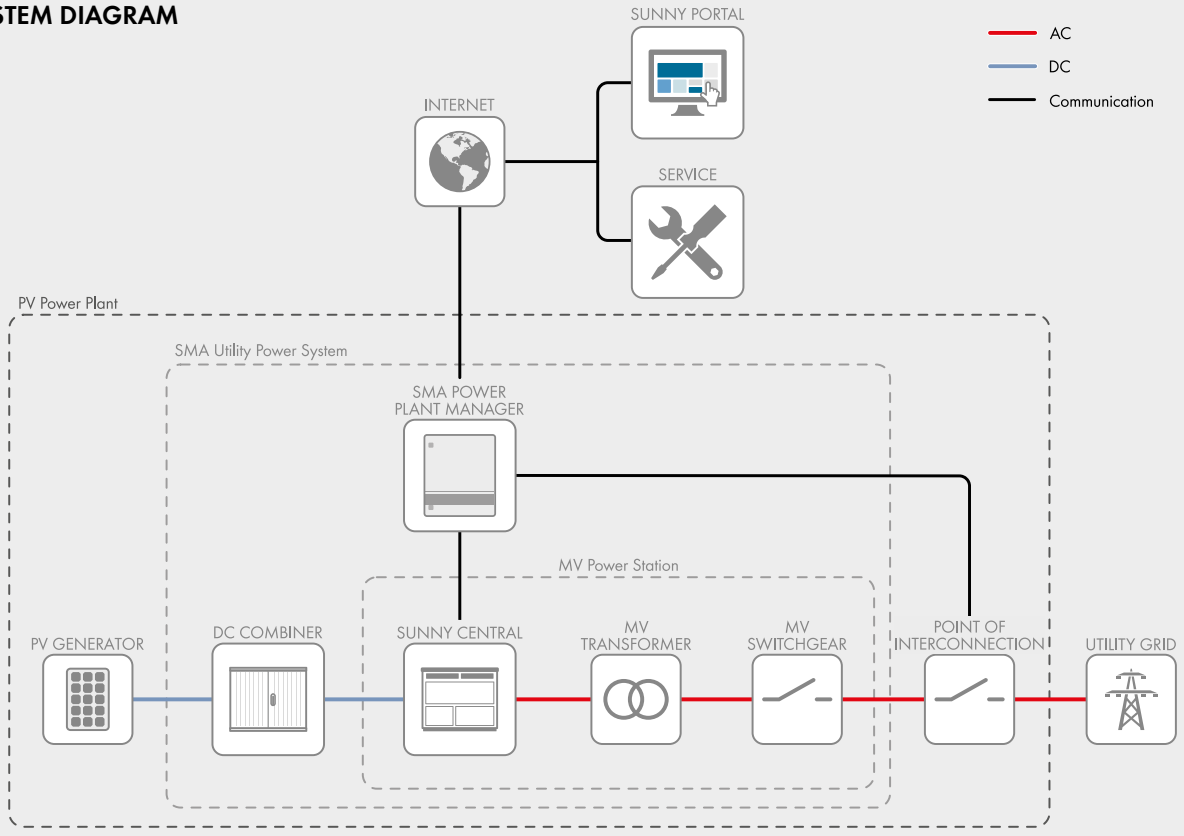

# TEMPERATURE BEHAVIOR (at 1000 m)

