

Up to 415 watt

WST-MGX-E3 GEMINI Series

Top performance for commercial applications



PERFORMANCE WARRANTY

ECO



www.winaico.com

DIMENSIONS

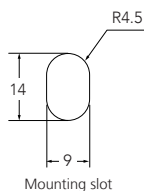
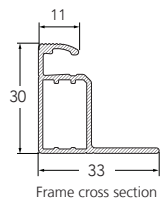
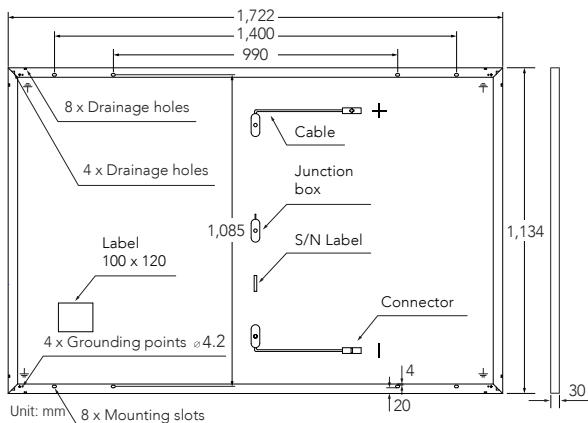

PACKAGING

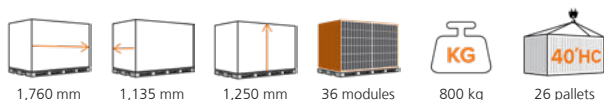

MECHANICAL DATA WINAICO WST-MGX-E3 GEMINI SERIES

Cell	Monocrystalline silicon cells
Quantity of cells	6 strings x 18 cells
Dimensions	1,722 x 1,134 x 30 mm (67.80 x 44.65 x 1.18 in)
Weight	21.6 kg (47.6 lbs)
Glass thickness	3.2 mm (0.13 in)
Frame	Black anodised aluminium
Junction box	IP68
Connector type	QC4.10 IP68
Cable length (IEC/UL)	1200 mm
Fire safety class	C

WINAICO PERFORMANCE GUARANTEE

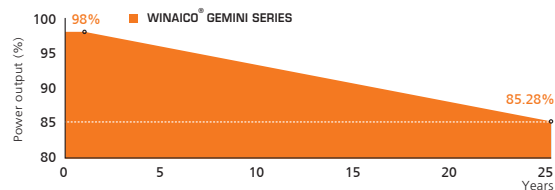

15 year product guarantee.
Linear performance guarantee for 25 years.
No more than 0.53% degradation per year from 2nd year to 25th year.

Operating conditions WINAICO WST-MGX-E3

Operating temperature	-40°C to +85°C / -40°F to +185°F
Maximum system voltage IEC/UL	1,500V/1,500V
Maximum series fuse	25 A
Maximum design load (push/pull)	3600 Pa/1600 Pa
Maximum test load (push/pull)	5400 Pa/2400 Pa
Nominal module operating temperature NMOT	43 ± 2°C
Temperature coefficient of P _{MAX}	-0.34%/°C
Temperature coefficient of V _{OC}	-0.26%/°C
Temperature coefficient of I _{SC}	0.048%/°C
Certifications	IEC 61215-1:2016, IEC 61215-2:2016, IEC 61730-1:2016, IEC 61730-2:2016

Electrical data (STC)		WST-410MGX-E3		WST-415MGX-E3	
		Value	Value	Value	Value
Nominal performance	P _{MAX}	410	415	Wp	
Voltage at maximum performance	V _{MP}	31.52	31.68	V	
Current at maximum performance	I _{MP}	13.01	13.10	A	
Open circuit voltage	V _{OC}	37.55	37.71	V	
Short circuit current	I _{SC}	13.85	13.94	A	
Module efficiency		21.00	21.30	%	
Power tolerance		-0/+5		W	

Electrical data applies under standard test conditions (STC): solar radiation 1,000 W/m² with light spectrum AM 1.5, with cell temperature 25°C. Measurement tolerance of P_{MAX} at STC: ±3%. Accuracy of other electrical data: ±10%.

Electrical data (NMOT)		WST-410MGX-E3		WST-415MGX-E3	
		Value	Value	Value	Value
Nominal performance	P _{MAX}	301	305	Wp	
Voltage at maximum performance	V _{MP}	28.95	29.10	V	
Current at maximum performance	I _{MP}	10.41	10.48	A	
Open circuit voltage	V _{OC}	34.73	34.88	V	
Short circuit current	I _{SC}	11.16	11.24	A	

Electrical data applies under Nominal Module Operating Temperature (NMOT), irradiance of 800 W/m², spectrum AM 1.5, ambient temperature 20°C, wind speed 1 m/s.



WINAICO Deutschland GmbH
Tel. + 49 7933 700 300
Fax + 49 7933 700 3010
germany@winaico.com · www.winaico.com
Industriestrasse 68, 97993 Creglingen, GERMANY

