

Up to 415 watt

# WST-MGX-E1 GEMINI Series

Top performance for commercial applications



PERFORMANCE  
WARRANTY

ECO



[www.winaico.com](http://www.winaico.com)

## DIMENSIONS

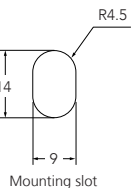
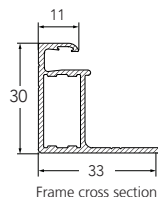
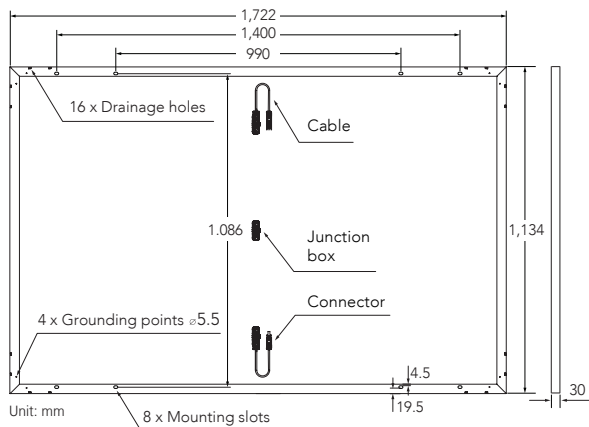

## PACKAGING

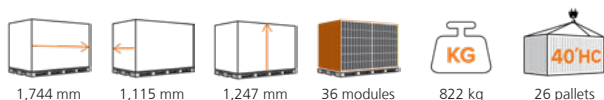

## MECHANICAL DATA WINAICO WST-MGX-E1 GEMINI SERIES

Cell	Monocrystalline silicon cells
Quantity of cells	6 strings x 18 cells
Dimensions	1,722 x 1,134 x 30 mm (67.80 x 44.65 x 1.18 in)
Weight	21.6 kg (47.6 lbs)
Glass thickness	3.2 mm (0.13 in)
Frame	Black anodised aluminium
Junction box	IP68, 3 bypass diodes
Connector type	PV-HCB40 IP68
Fire safety class	C
Cable length (IEC/UL)	1200 mm

## WINAICO PERFORMANCE GUARANTEE

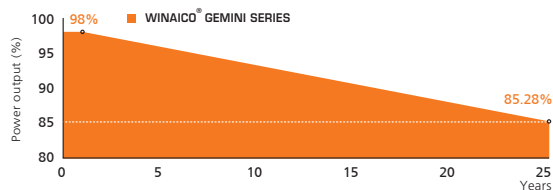

15-year product warranty.  
Linear performance guarantee for 25 years.  
No more than 0.53% degradation per year from 2nd year to 25th year.

## Operating conditions

Operating conditions		WINAICO WST-MGX-E1	
Operating temperature		-40°C to +85°C / -40°F to +185°F	
Maximum system voltage IEC/UL		1,500V/1,500V	
Maximum series fuse		25A	
Maximum design load (push/pull)		3,600 Pa/1,600 Pa	
Maximum test load (push/pull)		5,400 Pa/2,400 Pa	
Nominal module operating temperature NMOT		41 ± 2°C	
Temperature coefficient of P <sub>MAX</sub>		-0.35 %/°C	
Temperature coefficient of V <sub>OC</sub>		-0.27 %/°C	
Temperature coefficient of I <sub>SC</sub>		0.045 %/°C	
Certifications		IEC 61215-1:2016, IEC 61215-2:2016, IEC 61730-1:2016, IEC 61730-2:2016	

## Electrical data (STC)

Electrical data (STC)		WST-410MGX-E1	WST-415MGX-E1	
Nominal performance	P <sub>MAX</sub>	410	415	Wp
Voltage at maximum performance	V <sub>MP</sub>	31.43	31.60	V
Current at maximum performance	I <sub>MP</sub>	13.05	13.13	A
Open circuit voltage	V <sub>OC</sub>	37.40	37.60	V
Short circuit current	I <sub>SC</sub>	13.88	13.99	A
Module efficiency		21.0	21.3	%
Power tolerance		-0/+5		W

Electrical data applies under standard test conditions (STC): solar radiation 1,000 W/m<sup>2</sup> with light spectrum AM 1.5, with cell temperature 25°C. Measurement tolerance of P<sub>MAX</sub> at STC: ±3%. Accuracy of other electrical data: ±10%.

## Electrical data (NMOT)

Electrical data (NMOT)		WST-410MGX-E1	WST-415MGX-E1	
Nominal performance	P <sub>MAX</sub>	306	310	Wp
Voltage at maximum performance	V <sub>MP</sub>	29.29	29.45	V
Current at maximum performance	I <sub>MP</sub>	10.46	10.53	A
Open circuit voltage	V <sub>OC</sub>	35.34	35.53	V
Short circuit current	I <sub>SC</sub>	11.26	11.35	A

Electrical data applies under Nominal Module Operating Temperature (NMOT), irradiance of 800 W/m<sup>2</sup>, spectrum AM 1.5, ambient temperature 20°C, wind speed 1 m/s.



WINAICO Deutschland GmbH  
Tel. + 49 7933 700 300  
Fax + 49 7933 700 3010  
germany@winaico.com · www.winaico.com  
Industriestrasse 68, 97993 Creglingen, GERMANY

**WINAICO**<sup>®</sup>  
*Power to Perform*