



All Of These Models Listed

Can Be **Connected** to The

SMART LIFE Monitoring System



GTMI-800 SERIES 2 in 1

Solar Smart Micro Inverter

MODEL: GTMI-600 / GTMI-700 / GTMI-800

2 PV version

A better choice of Solar Smart Micro Inverter

ALL NEW GENERATION MICRO INVERTER GTMI SERIES LAUNCHED IN 2025.

APP remote monitoring real-time data display, cloud data storage.

Widest output voltage range 85-265Vdc, automatic voltage recognition everywhere.

Reverse transmission technology, up to 93% efficiency or more.

Excellent low-light lockout(APL) works even in atrocious weather.

Hand in hand multiple parallel staking mode, expansion is not restricted by conditions.

Waterproof rate IP67, effectively prevent rain erosion.

FEATURES

- ⊙ Built-in WIFI communication "Smart Life" app control.
- ⊙ Wide operation voltage input 22-60Vdc.
- ⊙ Adapted to 1-2-3 phase according to application.
- ⊙ Reverse transmission technology, load priority function.
- ⊙ Output power is adjustable according to application.
- ⊙ Automatic voltage conversion function.
- ⊙ Automatic detection of AC 0-angle phase.
- ⊙ Output pure sine wave.
- ⊙ Automatic sunlight sensing function.
- ⊙ Automatic Power Lock(APL).

- ⊙ Automatically adapt to different load power factors.
- ⊙ Constant current and power output.
- ⊙ Grid fault limits output(Anti-Islanding effect).
- ⊙ Current limit protection function.
- ⊙ Mixed stack of multiple devices.
- ⊙ Built-in highly integrated NA protection switch.
- ⊙ Over temperature load reduction function.
- ⊙ Automatic power factor compensation.
- ⊙ Solar PV leakage detection/alarm function.
- ⊙ Built-in power statistics.

STRUCTURE

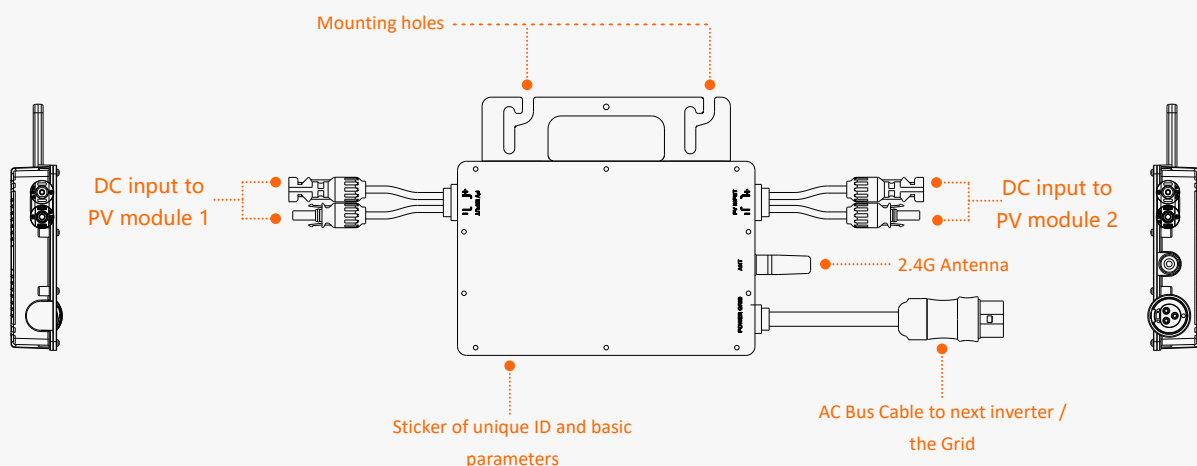

GTMI-600/GTMI-700/GTMI-800 MICRO INVERTER

INPUT DATA	GTMI-600	GTMI-700	GTMI-800
Max. input PV module	2 × 375Watt	2 × 435Watt	2 × 500Watt
MPPT voltage range	30 - 54VDC	30 - 54VDC	30 - 54VDC
Operation voltage range	22 - 60VDC	22 - 60VDC	22 - 60VDC
Maximum input current	2 × 14A	2 × 16A	2 × 18A

OUTPUT DATA	GTMI-600		GTMI-700		GTMI-800	
	⊙ 120VAC	⊙ 230VAC	⊙ 120VAC	⊙ 230VAC	⊙ 120VAC	⊙ 230VAC
Peak output power	600Watt	600Watt	700Watt	700Watt	800Watt	800Watt
Rated output power	550Watt	550Watt	650Watt	650Watt	750Watt	750Watt
Rated output current	5.00A	2.60A	5.90A	3.10A	6.60A	3.50A
Rated voltage range*	80 - 160VAC	180 - 260VAC	80 - 160VAC	180 - 260VAC	80 - 160VAC	180 - 260VAC
Rated frequency range*	50 - 60Hz	50 - 60Hz	50 - 60Hz	50 - 60Hz	50 - 60Hz	50 - 60Hz
Power factor (cos φ)	> 99%	> 99%	> 99%	> 99%	> 99%	> 99%
Maximum units per subcircuit	6pcs (Single-phase)	12pcs (Single-phase)	6pcs (Single-phase)	12pcs (Single-phase)	6pcs (Single-phase)	12pcs (Single-phase)

OUTPUT EFFICIENCY	GTMI-600 / GTMI-700 / GTMI-800
Static MPPT efficiency	99.5%
Maximum output efficiency	95%
Consumption at night	<50mW Max
THD	< 3%

OPERATING CONDITIONS / DIMENSIONS / APPLICATIONS	GTMI-600 / GTMI-700 / GTMI-800
Environment temperature	-40°C ~ +65°C
Operating temperature (Inside inverter)	-40°C ~ +85°C
Electrical isolation	Transformer, Galvanically isolated
Cooling concept	Self - cooling
Degree of protection (Waterproof)	IP67
Communication mode	WIFI / 2.4G
Power transmission mode	Reverse transfer, load priority
Integrated ground	Equipment ground is provided by PE in AC cable, no additional ground is required
Protection functions	Isolated island protection, voltage protection, frequency protection, temperature protection, current protection, etc.
Maximum current of AC bus cable	40A
AC cable length	20cm
Dimensions (W×H×D mm)	230mm × 150mm × 38mm
Net weight (Kg)	1.87Kg
Design Compliance	EN50549-1, EN61000-3-2, EN62109, DIN VDE V 0126, VDE-AR-N 4105, UL1741, etc.
Warranty	12 years materials and workmanship, 25 years extended warranty

* AC rated voltage range and frequency range depend on local standards.