

Hi-MO X10 Scientist

LR7-72HVH

640~670M



Advanced:

TOP Efficiency,+5% Power,More Yield.



Value-Added:

A+ Anti-Shading¹,Less Loss.



Aesthetic:

No Gridlines,Scenario Integration.



Safe:

Prevent Overheating,Lower temperature under shade 60°C⁺² compare with conventional modules



Monofacial
Power Generation

15Y Product
Warranty

30Y Performance
Warranty

Complete System and Product Certifications

IEC 61215,IEC 61730

IEC62941:Guideline for module design qualification and type approval

ISO9001:Quality Management System

ISO14001:Environment Management System

ISO45001:Occupational Health and Safety



24.80%

MAX MODULE
EFFICIENCY

1%

FIRST YEAR
POWER DEGRADATION

0.35%

YEAR 2-30
POWER DEGRADATION

-0.26%/°C

BETTER TEMPERATUR
COEFFICIENT

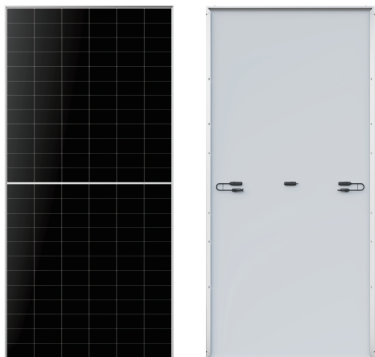

Tolerance:
Length: ±2mm
Width: ±2mm

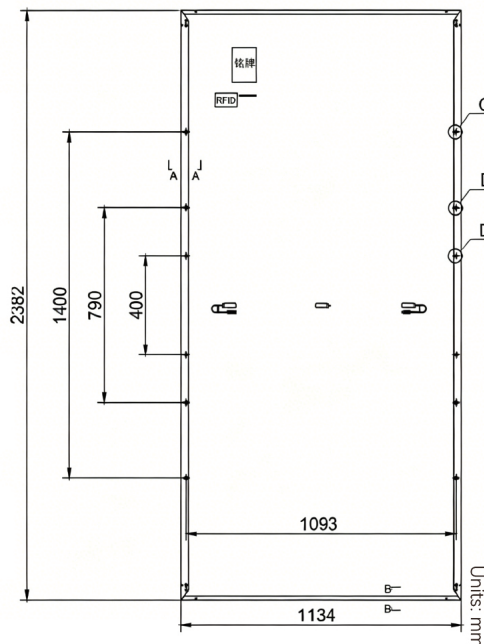
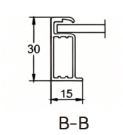
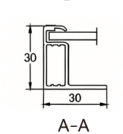
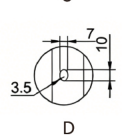
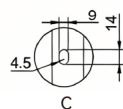

Mechanical Parameters

Cell Orientation	144 (6×24)
Junction Box	IP68, three diodes
Output Cable	4mm ² ;+400/-200mm/±1400mm length can be customized
Glass	Single glass, 3.2mm coated tempered glass
Frame	Anodized aluminum alloy frame
Weight	28.5 kg
Dimension	2382×1134×30mm
Packaging	36pcs per pallet / 144pcs per 20'GP / 720pcs per 40'HC

Remark: 17.5m trucks are rated at 30t load. Actual loading quantity is subject to vehicle specs.

Electrical Characteristics

-STC: Irradiance1000W/m², Cell Temperature 25°C, AM1.5 (Test uncertainty for Pmax: ±3%)

Module Type	LR7-72HVH-640M	LR7-72HVH-645M	LR7-72HVH-650M	LR7-72HVH-655M	LR7-72HVH-660M	LR7-72HVH-665M	LR7-72HVH-670M
Testing Condition	STC	STC	STC	STC	STC	STC	STC
Maximum Power (Pmax/W)	640	645	650	655	660	665	670
Open Circuit Voltage (Voc/V)	53.70	53.80	53.90	54.00	54.10	54.20	54.30
Short Circuit Current (Isc/A)	15.13	15.21	15.29	15.37	15.45	15.52	15.60
Voltage at Maximum Power (Vmp/V)	44.36	44.46	44.56	44.66	44.76	44.86	44.96
Current at Maximum Power (Imp/A)	14.43	14.51	14.59	14.67	14.75	14.83	14.91
Module Efficiency (%)	23.69	23.88	24.06	24.25	24.43	24.62	24.80

Operating Parameters

Module [T98] Max	70°C
Operational Temperature	-40°C ~ +85°C
Power Output Tolerance	0~3%
Maximum System Voltage	DC1500V (IEC)
Maximum Series Fuse Rating	25A
Nominal Operating Cell Temperature	45±2°C
Protection Class	Class II
Fire Rating	IEC Class C

Mechanical Loading

Min Designed Mechanical Load	1600Pa/1600Pa
Front Side Maximum Static Loading	5400Pa
Rear Side Maximum Static Loading	2400Pa
Hailstone Test	25mm Hailstone at the speed of 23m/s

Temperature Ratings (STC)

Temperature Coefficient of Isc	+0.050%/°C
Temperature Coefficient of Voc	-0.200%/°C
Temperature Coefficient of Pmax	-0.260%/°C