

132 CELL

M6 MBB MONO PERC

0 ~ +5W

POSITIVE POWER TOLERANCE

21.3%

MAXIMUM EFFICIENCY

410W-425W

- M6 HALF MONO PERC
- MONOFACIAL / BIFACIAL

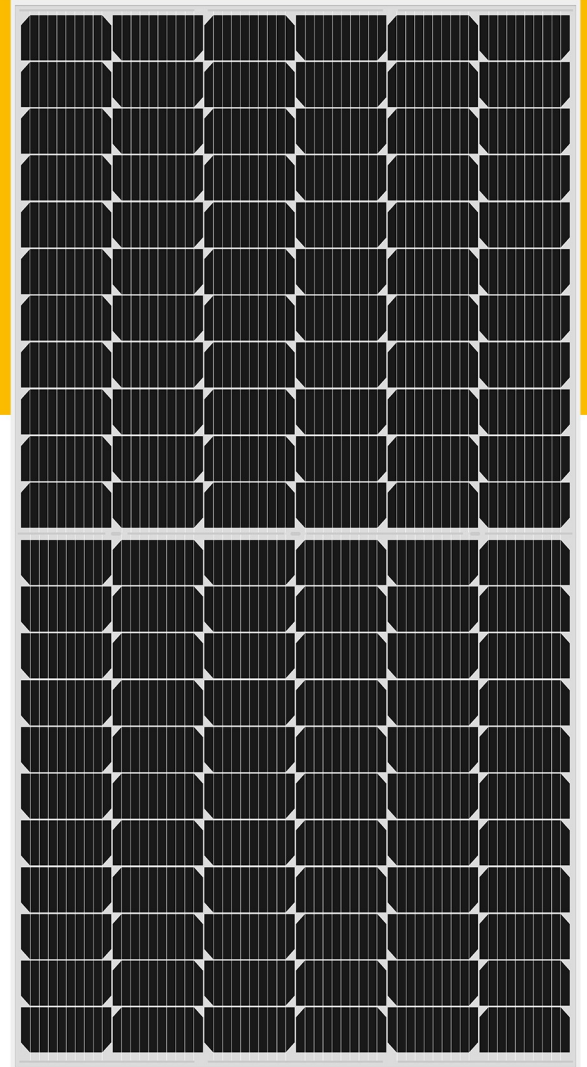

LINEAR PERFORMANCE WARRANTY

12 Years Product Warranty · 30 Years Linear Power Warranty

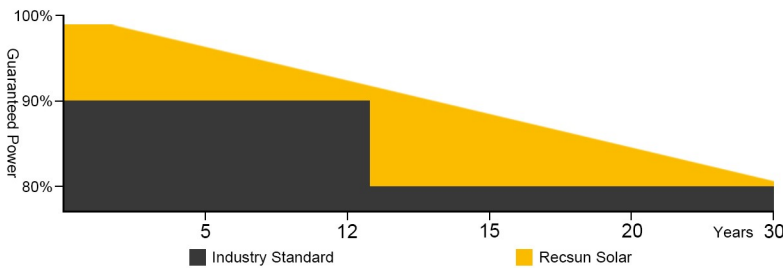

KEY FEATURE

SMBB Technology

Better light trapping and current collection to improve module power output and reliability

PID Resistance

Anti-PID performance guarantee via optimized mass-production process and materials control

Enhanced Mechanical Load

Certified to withstand: wind load (2400 Pascal) and snow load (5400 Pascal)

Improve Physical Property

Improve the property of power generating and reliability of the solar system

MODULE PARAMETERS		RS-M410H132M6		RS-M415H132M6		RS-M420H132M6		RS-M425H132M6	
Testing Condition		STC	NOCT	STC	NOCT	STC	NOCT	STC	NOCT
Maximum Power	$P_{MAX}(W)$	410	306.2	415	309.9	420	313.7	425	317.4
Maximum Power Voltage	$V_{MPP}(V)$	38.00	35.38	38.20	35.57	38.40	35.76	38.60	35.94
Maximum Power Current	$I_{MPP}(A)$	10.79	8.65	10.87	8.71	10.94	8.77	11.02	8.83
Open Circuit Voltage	$V_{OC}(V)$	45.20	42.37	45.40	42.56	45.60	42.75	45.80	42.94
Short Circuit Current	$I_{SC}(A)$	11.57	9.36	11.65	9.42	11.73	9.49	11.81	9.55
Power Output Tolerance	(W)	0 ~ +5		0 ~ +5		0 ~ +5		0 ~ +5	
Module Efficiency	(%)	20.5		20.8		21.0		21.3	

STC: Irradiance 1000 W/m², Cell Temperature 25°C, Air Mass AM1.5, Average efficiency reduction of 4.5% at 200W/m².

NOCT: Irradiance at 800 W/m², Ambient Temperature 20°C, Wind Speed 1m/s.

DIMENSIONS OF PV MODULE

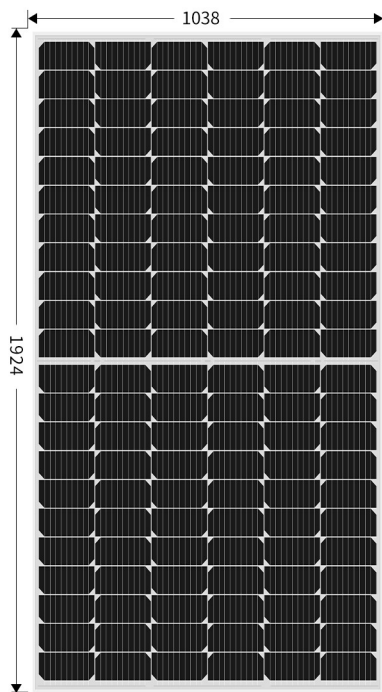

FRONT VIEW

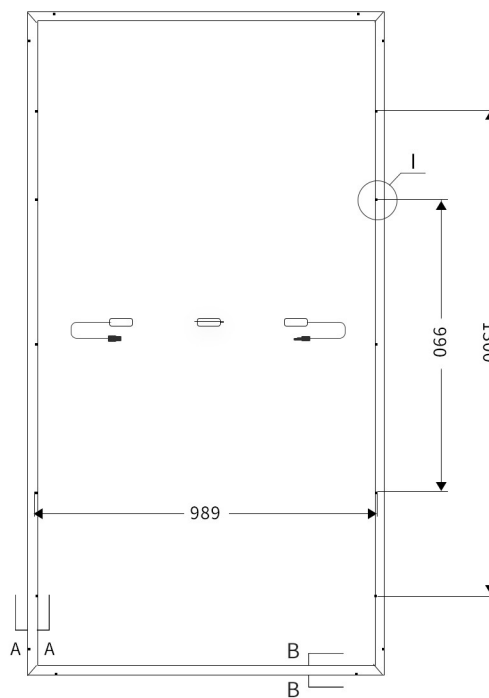

BACK VIEW

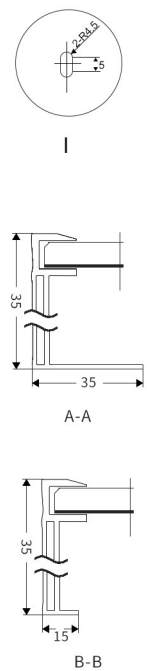

MECHANICAL PARAMETERS

Solar Cells	MBB MONO PERC 166x83mm
Cell Orientation	132 Cells (6 x 22)
Module Dimensions	1924 x 1038 x 35mm
Weight	22Kg
Glass	High Transparency, Anti-Reflective, AR Coated and Heat Tempered Solar Glass -3.2mm
Backsheet	White / Black
Frame	Silver Anodized Aluminium Alloy (Black Available)
Junction Box	IP 68 Rated
Cables	Photovoltaic Technology Cable 4.0mm ² , 350mm
Connector	MC4 Compatible

TEMPERATURE RATINGS

Nominal Operating Cell Temperature (NOCT)	45±2°C
Temperature Coefficient of P_{MAX}	-0.35%/°C
Temperature Coefficient of V_{OC}	-0.27%/°C
Temperature Coefficient of I_{SC}	+0.048%/°C

OPERATING PARAMETERS

Operational Temperature	-40 ~ +85°C
Maximum System Voltage	1500V DC
Max Series Fuse Rating	20A
Mechanical Load	5400Pa
Wind Load	2400Pa

PACKAGING CONFIGURATION

Per Pallet :31 Pieces

Per 40' Container: 792 Pieces

© Recsun Solar Energy Co., Ltd All rights reserved. Specifications included in this datasheet are subject to change without notice.