

JYHY210000G(2V1000AH) is GEL battery which is manufactured with colloidal Silicon and sulfuric acid .It's featured with low self-discharge ,strong ability to recover from deep discharging, good low temperature properties

JYHY210000G(2V1000AH)胶体电池采用纳米级的二氧化硅硫酸胶体技术制造,具有自放电量小,过放电恢复能力强,低温性能好的特点

Performance Characteristics 基本特性

Nominal Voltage标准电压		2V
Number of cell 单格数		1
Capacity (25°C) 容量	100HR (12A、1.85V)	1200Ah
	20HR (53A、1.8V)	1060Ah
	10HR (100A、1.8V)	1000Ah
	1HR (588A、1.6V)	588Ah
Approx. Weight 重量		63kg (138.89lbs) ±3%
Internal resistance 内阻 (Fully charged, 25°C)		Approx. 0.11mΩ
Capacity affected by temperature (10HR) 不同温度下的 10小时率容量	40°C	102%
	25°C	100%
	0°C	85%
	-15°C	65%
The self-discharge rate is less than 3% monthly at average 25°C. For higher temperature, the time interval will be shorter. 在常温25°C度的情况下,自放电率小于3%(每月), 储存温度越高,则存放时间会相应缩短		
Nominal operating temperature 标准使用温度		25°C ± 3°C (77°F ± 5°F)
Operating temperature range 使用温度范围	Discharge 放电温度: -15°C ~ 50°C (5°F ~ 122°F)	
	Charge 充电温度: -10°C ~ 50°C (14°F ~ 122°F)	
	Storage 储存温度: -20°C ~ 50°C (-4°F ~ 122°F)	
Charge (Constant Voltage) 充电电流/电压	Float 浮充使用: 2.23~2.28V/77° F / (25°C)	
	Cycle 循环使用: 2.38~2.42V/77° F / (25°C) Max Current 最大电流: 200A	
Discharging current 77° F / (25°C): 4000A (5S) 放电电流(25°C): 4000A (5秒)		
Designed floating life (20°C) 设计浮充使用寿命		15~18 years

Certificate 认证



Outer dimension(mm) 电池尺寸

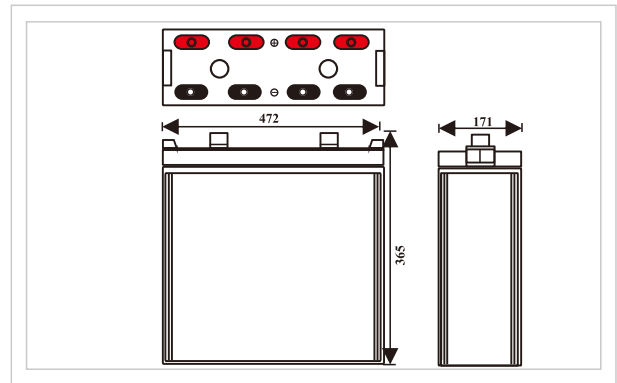

Terminal dimension(mm) 端子尺寸

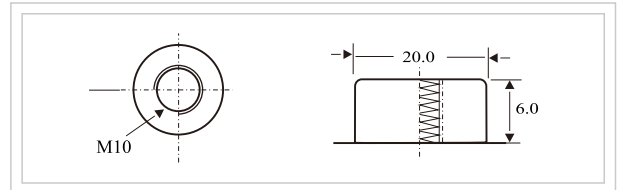

Battery Construction 电池结构

Terminal material 端子	Copper 铜
Positive plate 正极板	Lead dioxide 二氧化铅
Negative plate 负极板	Lead 铅
Container 胶壳	ABS
Cover 胶盖	
Safety valve 安全阀	Rubber 橡胶
Separator 隔板	Fiberglass/PE 玻璃纤维/PE
Electrolyte 电解质	Colloidal silicon 硅溶胶

Constant Current (Amp) and Constant Power (Watt) Discharge Table at 25°C (77° F) 恒流放电与恒功率放电表

F.V 终止电压	Time 时间	30min	60min	2h	3h	4h	5h	6h	8h	10h	20h	24h
		1.60V	恒流(A)	900	600	365	260	209	182	156	122	102
	恒功率(W)	1683	1140	705	510	410	358	307	244	203	107	93
1.65V	恒流(A)	882	591	363	259	208	180	155	122	102	53	46
	恒功率(W)	1649	1123	701	507	407	356	306	242	202	107	93
1.70V	恒流(A)	855	576	360	257	206	179	154	121	101	53	46
	恒功率(W)	1599	1094	695	503	405	353	304	240	202	106	93
1.75V	恒流(A)	834	565	355	255	205	178	153	120	101	53	46
	恒功率(W)	1560	1073	684	500	402	351	301	239	200	106	92
1.80V	恒流(A)	804	547	346	247	199	173	148	116	100	53	46
	恒功率(W)	1503	1040	667	485	390	340	292	232	199	105	92

