

# OPzV Tubular-Gel Battery

## 2V800AH

### FEATURES

- Low self-discharge and long shelf life
- Non-Spillable construction
- Safety valve installation for explosion proof
- Exceptional deep discharge recovery performance
- 99.7% pure lead calcium grids and A recognized Component of U.L

### APPLICATION

- Photovoltaic system
- Telecommunications
- Emergency Power System
- Power plant and power transformer system
- Control Equipment



### SPECIFICATIONS

Nominal Voltage	2V
Nominal Capacity	800Ah@10 hour rate F.V.(1.80V/cell)
Approx. Weight	62Kg(136.68 lbs)
Terminals	M8 Female Large Size Copper Post
Internal Resistance	≤0.33mΩ (Fully Charged)
Max. Discharge Current	8000A (3 sec)
Max. Charge Current	200A
Operating Temperature Range	Charge: -20°C~50°C (-4°F~122°F) Discharge: -40°C~55°C (-40°F~131°F) Storage: -20°C~40°C (-4°F~104°F)
Self Discharge	About 2.0% of capacity declined per month at (25°C)

ISO 9001 IAF

通信产品认证

- IEC 60896-21/22
- DIN 40742
- YD/T 1360-2005

### DIMENSION(mm/inch)

### OUTER DIMENSIONS

### TERMINAL TYPE

#### Length

211±2.0mm (8.31±0.08inch)

#### Width

192±2.0mm (7.56±0.08inch)

#### Container Height

647±2.0mm (25.47±0.08inch)

#### Total Height

676±2.0mm (26.61±0.08inch)

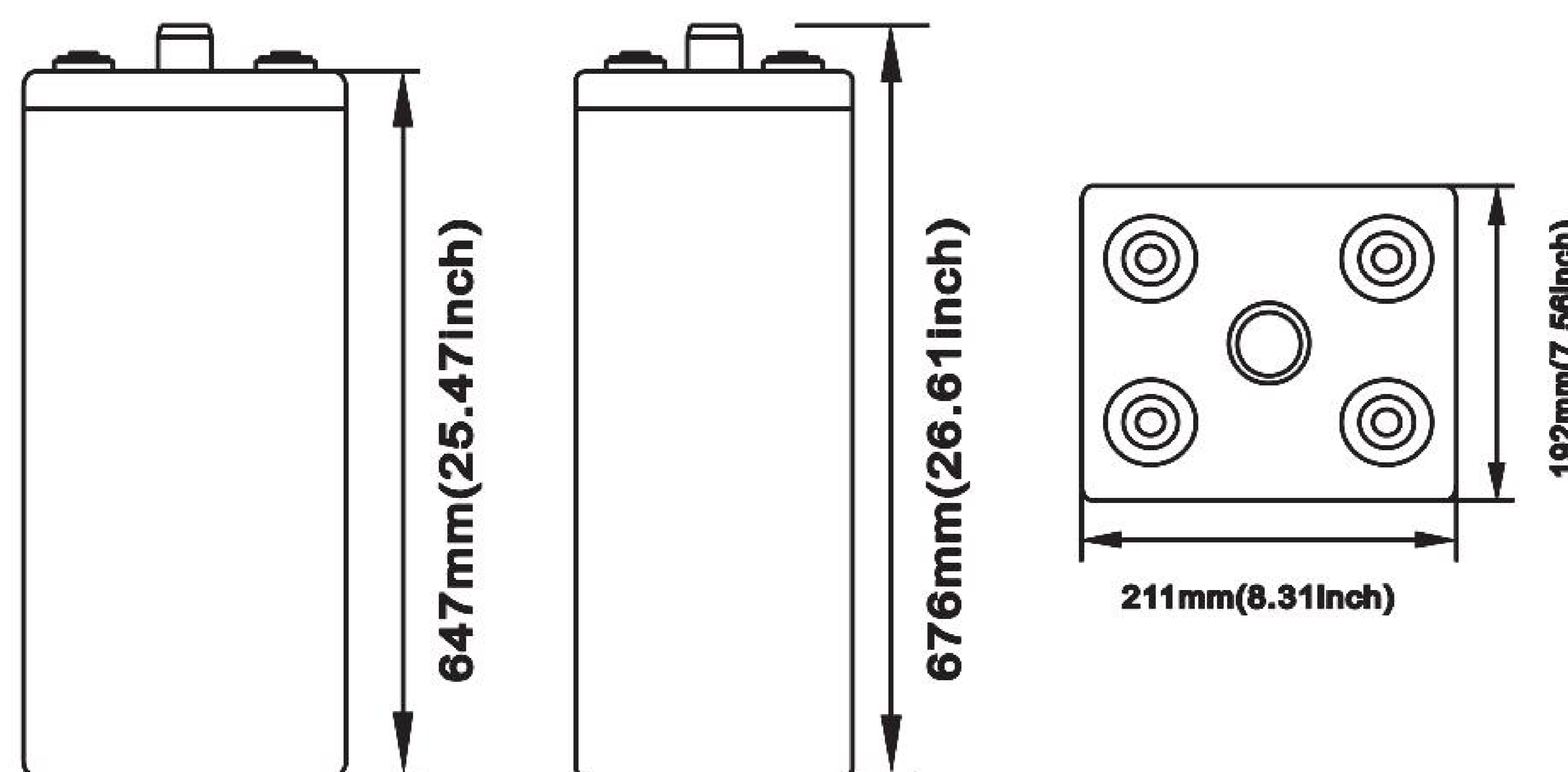

#### Terminal

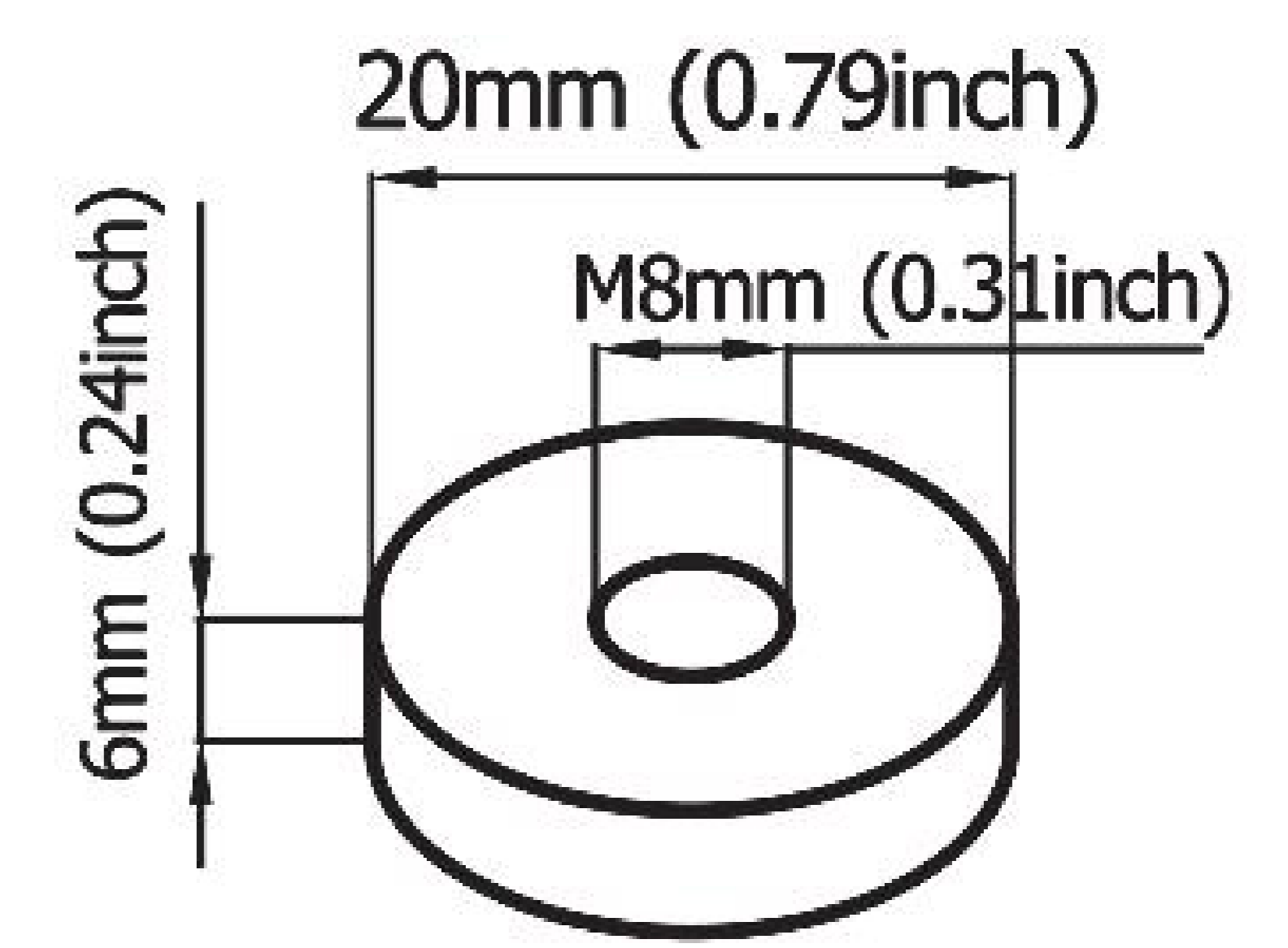

[M8 BOLT]

Terminal Hardware Initial Torque:13(5.5Nm±5%)

### Constant power discharge characteristics at 25°C/77°F Unit:W

F.V/Time	15MIN	30MIN	1HR	2HR	3HR	5HR	10HR	20HR	Charge Voltage	
									Cycle use	2.35-2.40V (±4mV)
1.70V	1462	1190	922	542	427	293	158	89.7	Max Current	200A
1.75V	1346	1142	884	528	417	289	156	88.3		
1.80V	1192	1074	779	514	402	284	154	88.2		
1.90V	886	799	635	472	353	256	138	81.6		

### Constant current discharge characteristics at 25°C/77°F Unit:A

F.V/Time	15MIN	30MIN	1HR	2HR	3HR	5HR	10HR	20HR	Float Use	
									2.25-2.30V (±3mV)	
1.70V	848	688	468	286	212	142	82.0	46.4	Float Use	2.25-2.30V (±3mV)
1.75V	752	624	448	278	208	141	81.0	46.1		
1.80V	626	560	416	266	200	139	80.0	45.9		
1.90V	416	392	312	220	172	124	71.5	42.1		

# OPzV Tubular-Gel Battery

## 2V800AH

### Trickle(or Float) Service Life

### Charge Characteristic

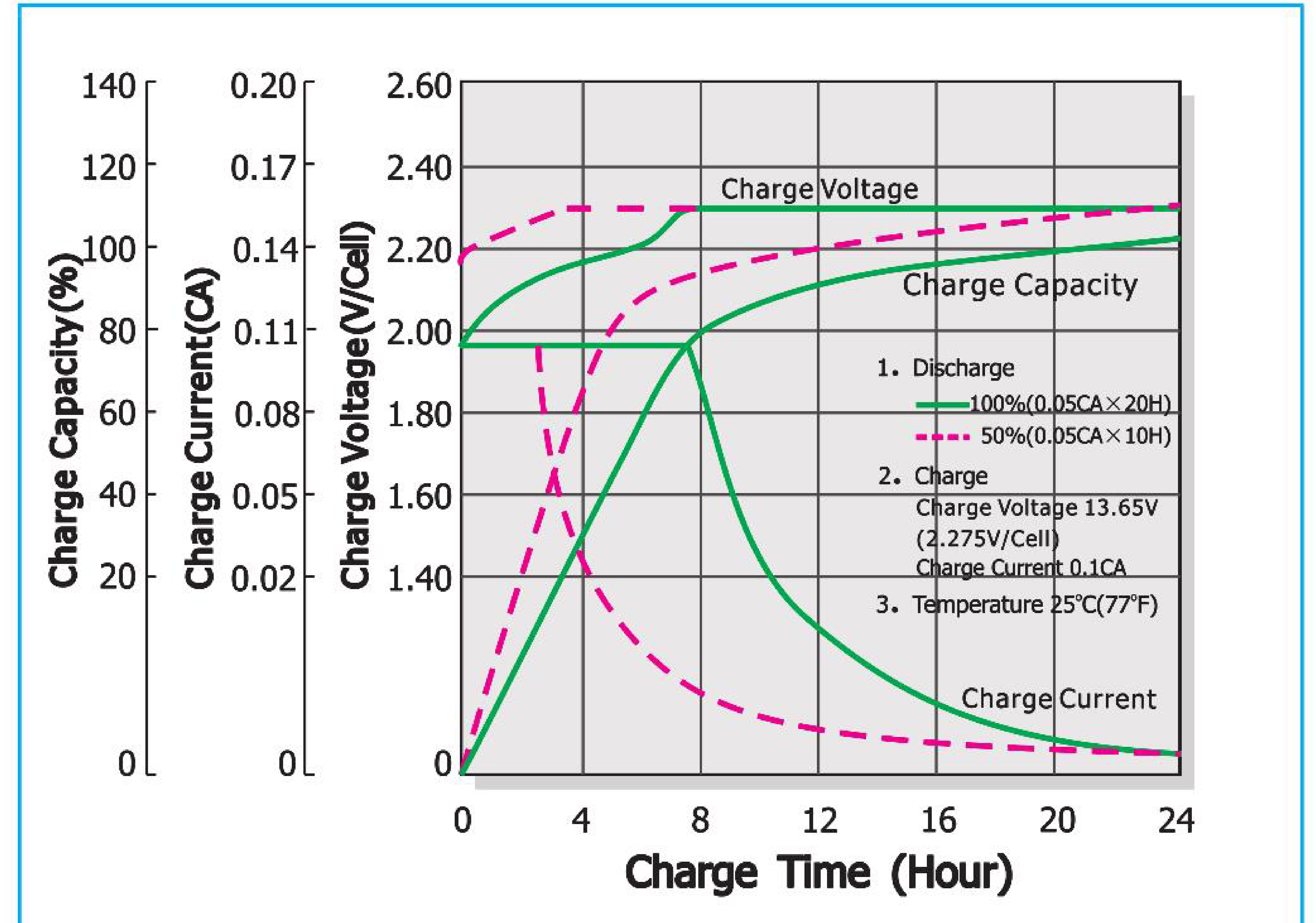
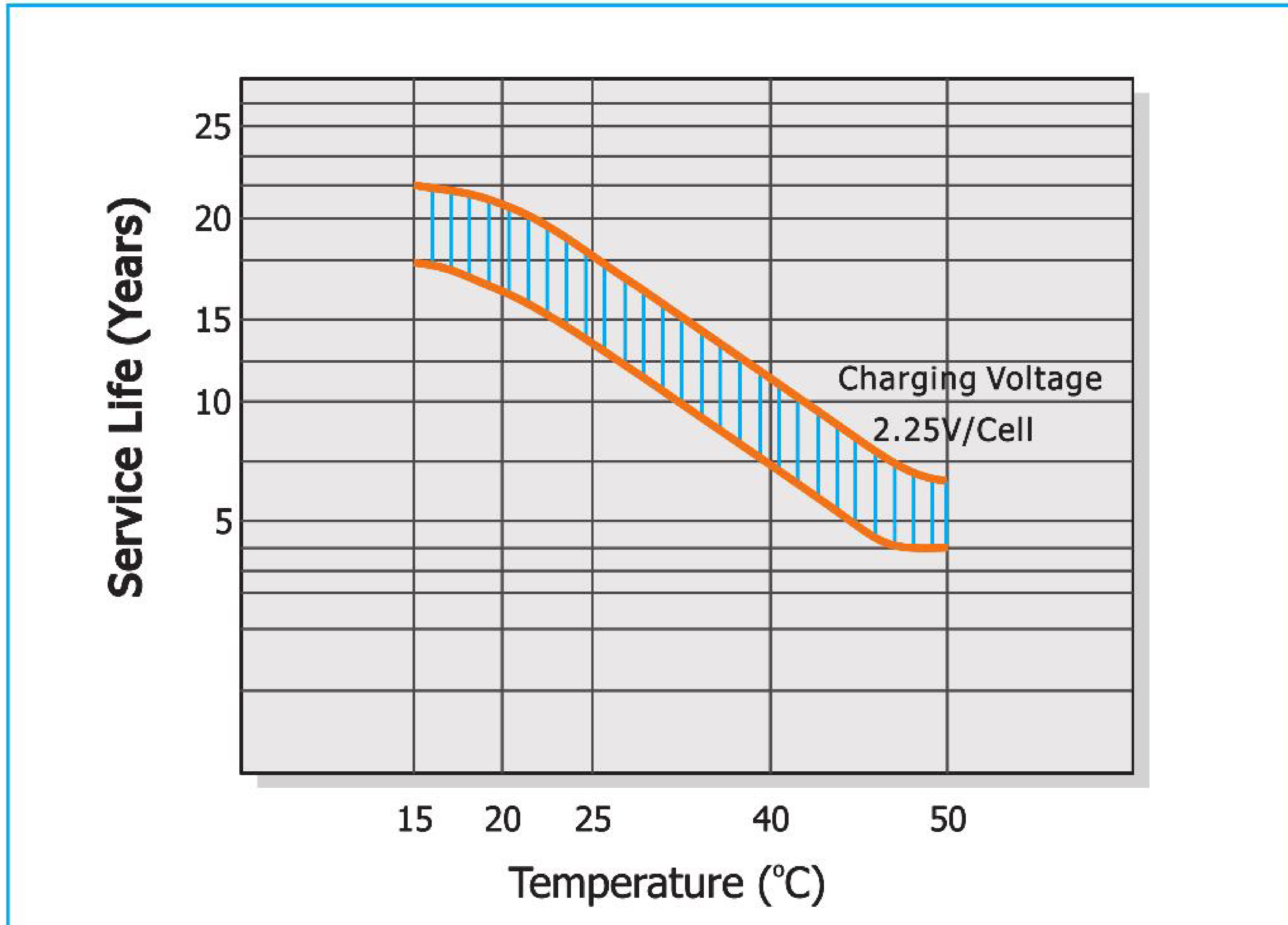

### Cycle Service Life

### Discharge Characteristic

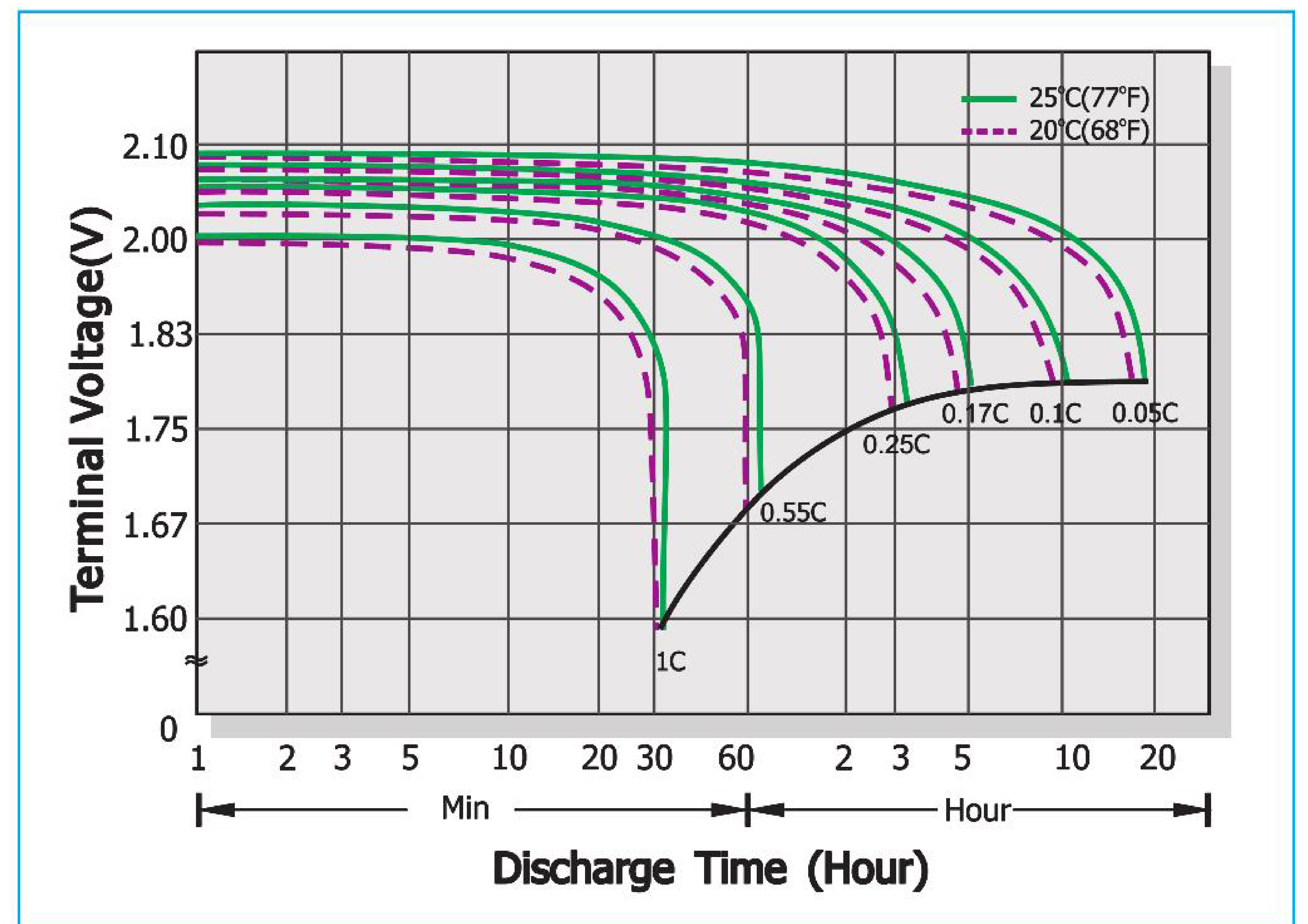
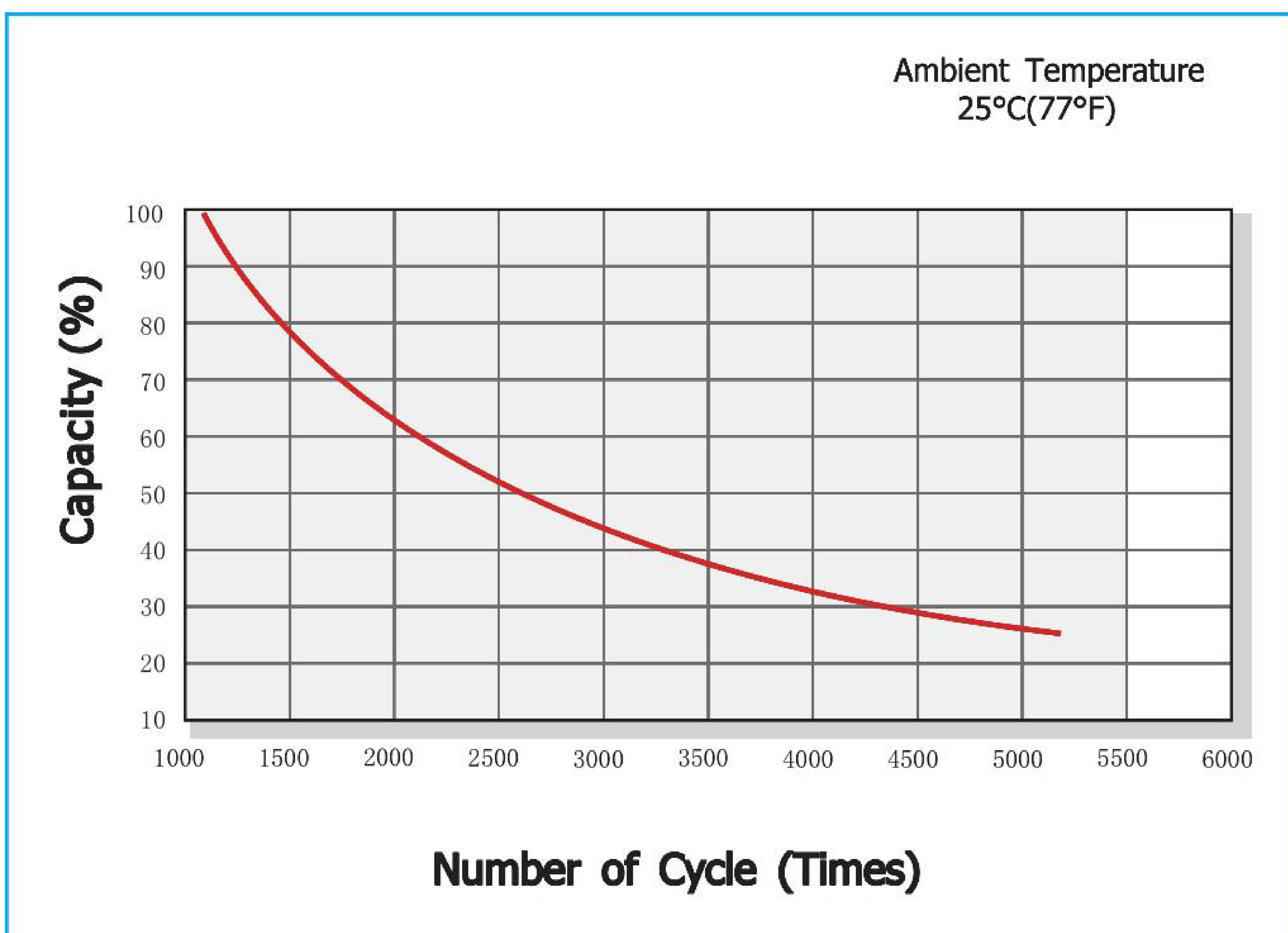

### Capacity Factors With Different Temperature

Battery Type		-20°C	-10°C	0°C	5°C	10°C	20°C	25°C	30°C	40°C	45°C
GEL Battery	6V&12V	55%	75%	85%	88%	90%	98%	100%	102%	104%	105%
	2V	65%	80%	88%	90%	92%	99%	100%	103%	105%	106%
AGM Battery	6V&12V	46%	66%	76%	83%	90%	98%	100%	103%	107%	109%
	2V	55%	70%	80%	85%	92%	99%	100%	104%	108%	110%