



# Data Sheet

**RADIUS** APV-S



## PHOTOVOLTAIC STRING INVERTERS

*Technology from*  
**GEFRAN, Italy**



Generate



Measure



Control



Record



Analyze

## DESCRIPTION

> Rishabh, a leader in industrial sector with vast experience and know-how, presents the new Radius APV-S string inverter. Conforming to the most advanced international standards, the APV-S satisfies the application demands of a market in constant technological evolution.

The RADIUS range of PV inverters represents the most advanced technology in the sector for controlling state-of-the-art industrial and civil PV plants. Maximum energy efficiency, long term reliability, plant monitoring and high-level professional service are the cornerstones of the RADIUS range.

These inverters feature cutting-edge power components and advanced system controls that deliver superior performance with rapid returns on investments.



RADIUS -APV-S

## FEATURES

- ▶ Maximum efficiency up to 98.3%
- ▶ IP -65 structure suitable for both indoor & outdoor installation
- ▶ Full power without derating up to 50°C ambient temperature.
- ▶ Easy O&M.
- ▶ Robust design and latest-generation power components with SiC technology
- ▶ Maximum power point tracking, up to 3 MPPT trackers
- ▶ Wide MPPT voltage range 350 to 800V
- ▶ Large graphical display provides a easy, user-friendly operator interface
- ▶ "Transformerless" versions for enhanced efficiency
- ▶ String fault detection & DC fuses on both poles of string
- ▶ Integrated DC circuit breaker under load
- ▶ Tool free & maintenance free terminals for AC Side
- ▶ Integrated datalogger for operation and fault data logging
- ▶ USB port for quick & handy saving of production and operation data
- ▶ Integrated protections against overcurrent, overtemperature, reverse dc polarity, AC & DC overvoltage
- ▶ Wire Box to allow separate access for easy and quick installation.
- ▶ 2 Rs485 ports for communication interface
- ▶ Integrated inputs/outputs: 3 analog inputs, 2 digital inputs, 2 digital outputs
- ▶ Auxiliary 24 VDC out (500mA max) for connection of environmental sensors



Generate



Measure



Control



Record



Analyze

## VERY HIGH CONVERSION EFFICIENCY LEVEL



Maximum efficiency up to 98.3% makes the APV-S string inverter one of the highest performing products on the market.

The use of SiC technology achieves high efficiency even with low input voltages.

Choice of cutting-edge power components and its intelligent design of the conversion system demonstrate its attention to performance and ensure users the fastest and highest return on their investments.

**SiC** Silicon Carbide  
Technology

## PERFECT IN EVERY INSTALLATION CONDITION

### Full power up to 50°C

The ability to work at high ambient temperatures without derating makes the APV-S ideal even in the harshest environments. See specifications for details.

### IP 65

APV-S is suitable for both indoor and outdoor installations thanks to its IP65 structure.



## RIGHT ANSWER TO ALL ENGINEERING NEEDS



With a very wide range of modular configurations, the APV-S line of inverters ensures users not only the best technical solution but also the best price/performance ratio for every plant engineering need:

- AC power with variable cos phi

The offer is completed with a wide range of options, accessories, and services that make RADIUS the ideal partner for the entire life of the PV system.



Generate



Measure



Control



Record



Analyze

*These specifications may be changed without notice.*

# APPLICATIONS

ADVANCED ENERGY Series APV-S-...k-AE - 50kW

Maximum flexibility and performance even in systems with complex structure.

PLANTS WITH NON-UNIFORM STRINGS



## CODE DESCRIPTION

APV-S-XXk-XX-TL-X X X X X -XX

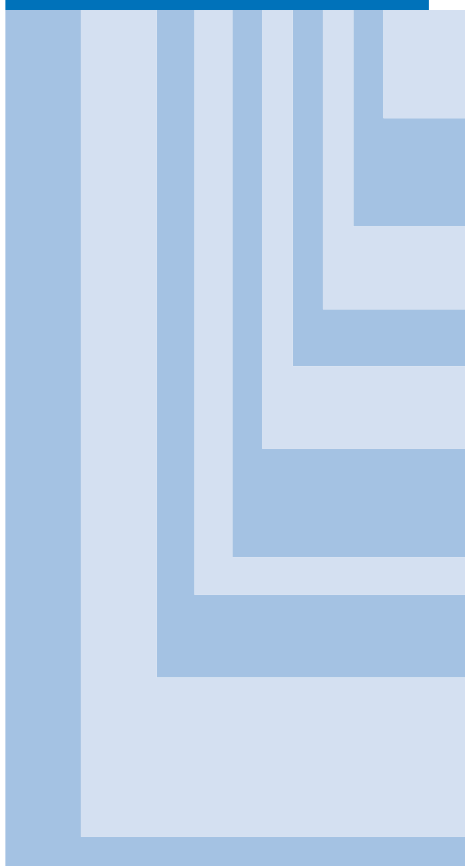
	Display	KA = advanced display
	Grounding kit	X = not included
	Interface protection system to CEI-021 standard and AC3 contactor	X = not included
	DC fuses and Broken string recognition	F = included
	DC circuit breaker under load	S = included
	MPPT numbers	3 = 3 MPPT
	Transformer:	TL = not included
	Model	AE = Advanced Energy
	Inverter power in kW:	50k = 50 kW
Photovoltaic string inverter, APV-S series		



Generate



Measure



Control



Record



Analyze

*These specifications may be changed without notice.*

## GENERAL CHARACTERISTICS

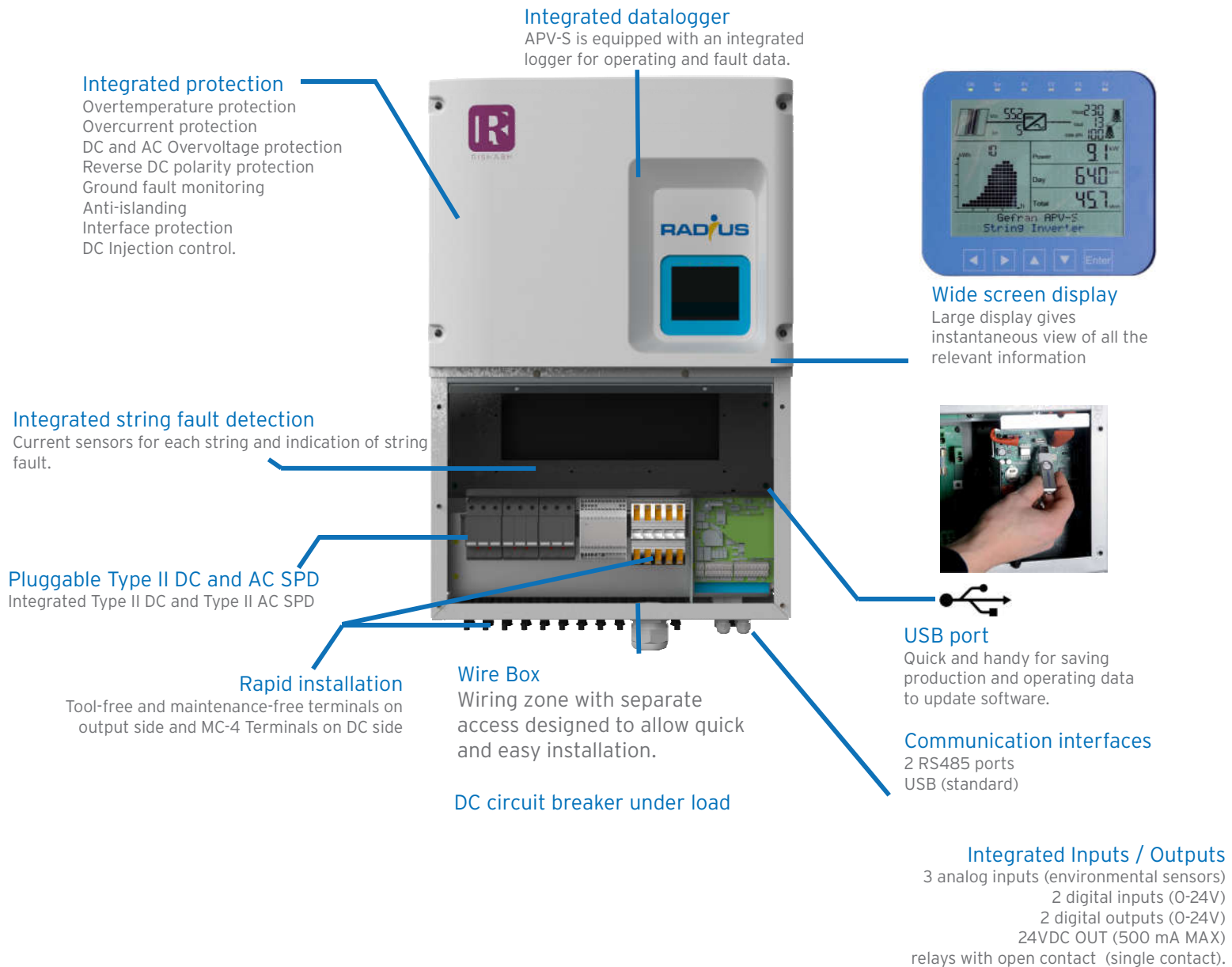

Generate



Measure



Control



Record



Analyze

*These specifications may be changed without notice.*

### CHOOSING THE INVERTER - TECHNICAL DATA

APV-S-...-AE			Radius
			Designed on the Technology Platform of Radius
			50k-AE-TL-3
Input data	Maximum DC voltage	V <sub>DC</sub> max [V]	1000
	MPPT Operating Range	[V]	350..890
	MPPT Range(@ maximum power)	[V]	520..800
	Start- up voltage	[V]	>200
	Max. Recommended PV Power (balanced input)	[kWp]	60
	MPPT number	No. MPPT	3
	Number of strings per each MPPT	No.	4
	Maximum DC current per MPPT	I <sub>DC</sub> max [A]	33.7
Output data	Rated AC Power	P <sub>NOM</sub> AC [kW]	50
	AC rated current/Max current	I <sub>AC</sub> max [A]	72.1/79
	AC voltage	V <sub>AC</sub> [V]	415V (3-phases + Neutral) (output voltage range 320..480) <sup>(1)</sup>
	Rated AC frequency	f <sub>AC</sub> [Hz]	50/60Hz (Output frequency range 47..53/57..63) <sup>(1)</sup>
	Grid connection		TN-C/TN-S/TN-C-S/TT
	THDi	THD grid [%]	≤3
	Power factor (settable)	cosphi	+/- 0.8
Efficiency	Maximum efficiency	[%]	98.1
	European efficiency (Euro ETA)	[%]	97.6
	Interface protections(grid monitor)		Integrated
	Anti-islanding		Integrated (Where required by local regulations)
	Insulation control		Integrated
	Residual current monitoring		Integrated
	Reverse DC polarity protection		Integrated
	AC/DC overvoltage		Type 3 SPD standard with thermal protections & DC side indication Optional: Type 2 pluggable DC SPD & AC SPD <sup>(2)</sup>
	DC injection control		Integrated
	DC circuit breaker		Circuit breaker under load
Protections	DC fuses & string failure detection		12A fuses on both poles of each string + current sensors for each string
	Night Consumption(Standby loss)		< 1W

(1) The output voltage and frequency interval may vary according to the network connection standard.



Generate



Measure



Control



Record



Analyze

These specifications may be changed without notice.

## CHOOSING THE INVERTER - TECHNICAL DATA

APV-S-...-AE		Radius
		Designed on the Technology Platform of Radius
		50k-AE-TL-3
Interface	Display	KA
		KA = 100 x 100mm graphic display with keypad
	Communications	2 Rs485 ports (both with separate in/out) 1 standard USB port (only for firmware updates and downloading of historical data In built GSM based remote monitoring system(optional)
	Inputs/Outputs	3 analog inputs (environment sensors 0..10V) 2 Digital inputs (0-24V) 2 Digital outputs (0-24V) 24V OUT (500mA MAX) 1 relay single contact (30Vdc, 250Vac/2A)
Cooling		Forced Convection
Environmental Data	Temperature Range	-20...+60°C
		Over 50°C derating
	Vibration	1G
	IP protection degree	IP 65
	Environmental conditions	4K4H
	Maximum permissible value for relative humidity, non condensing	100%
	Pollution degree	EN 60721-3-4, free from direct solar radiation To avoid increase in the internal temperature of the inverter and cause a reduction of the output power (derating)
	Altitude	Up to 2000m with derating (1.2% each 1000m above 1000m
Dimension & Weight	Dimensions	W x H x D: 551 x 864 x 377mm
	Weight(Kg)	103
Standards	Approvals	Designed to meet all the relevant applicable IEC standards

(2)The complete series of Radius including new model of 50kW is available under manufacturer name Rishabh.



Generate



Measure



Control



Record



Analyze

These specifications may be changed without notice.



## APV-S- 50kW-AE DIMENSION

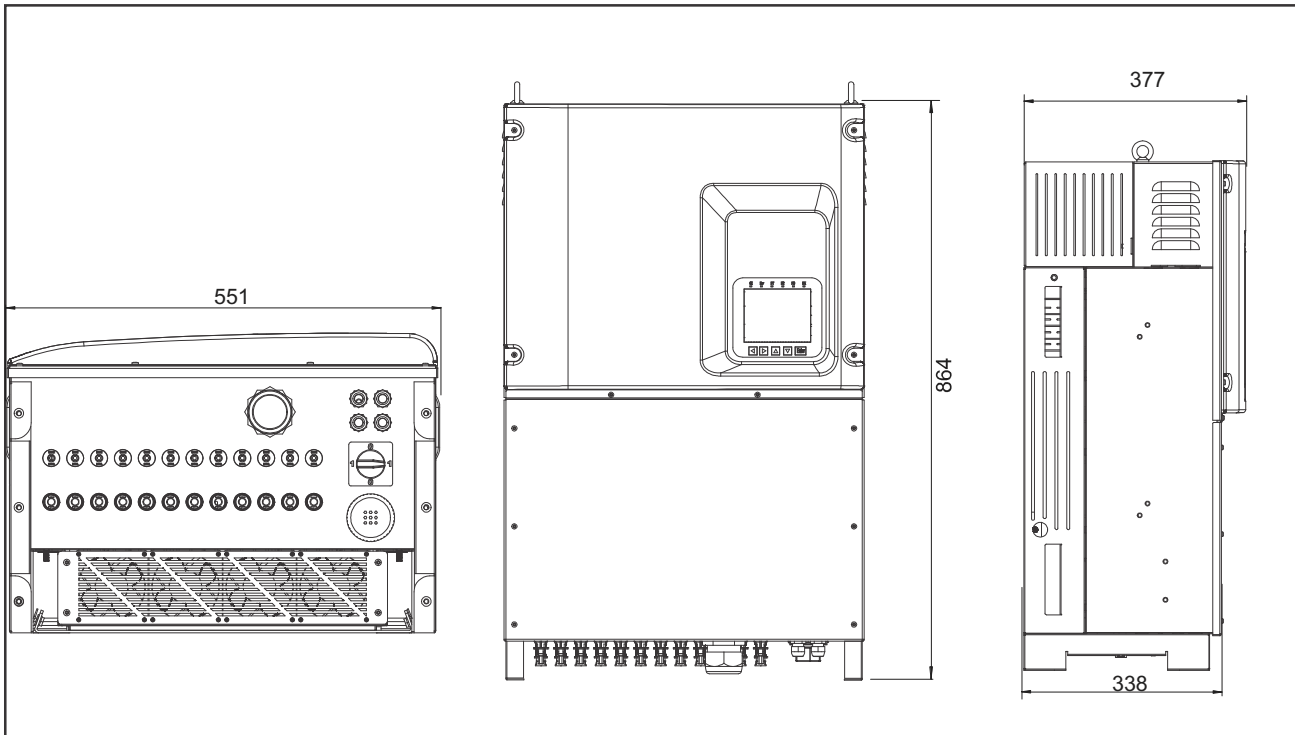

Generate



Measure



Control



Record



Analyze

*These specifications may be changed without notice.*





SOLAR ON-GRID INVERTERS  
from



RISHABH



Generate



Measure



Control



Record



Analyze

**RISHABH INSTRUMENTS PVT. LTD.**

Trishala Unit, C-6, NICE Area, MIDC, Satpur, Nashik - 422007, In

Tel: +91 253 2202019 | Fax: +91 253 2351064 | Email: [inverters@rishabh.co.in](mailto:inverters@rishabh.co.in) | [www.radius.rishabh.co.in](http://www.radius.rishabh.co.in)