

MULTI-OPERATION MODE



- ✔ Pure Sine Wave solar inverter with up-to 93% peak efficiency
- ✔ 4.3" large coloured LCD Display with touch buttons & customizable LED Ring with RGB lights
- ✔ Inbuilt kWh Meter and Grid Feed-in/Export option
- ✔ Selectable timer for grid charging
- ✔ Customizable supply priority and customer adjustable charging current and voltage
- ✔ Built in Wi-Fi monitoring via mobile app
- ✔ Communication port for BMS - RS485
- ✔ Can be used without batteries & compatible with Lead Acid, Lithium-Ion and LiFePO4 Batteries
- ✔ Connect up-to 9 inverters in parallel in single phase & three phase



Direct Power from Solar

FlinInfini Turbo allows you to choose on how to power your loads: Either share loads between solar & utility or share loads between solar & battery. Intelligent system allows you to power load directly from solar power during the day time keeping grid and/or battery power only for back-up. Wide MPPT range (120 – 430 VDC) of the built-in solar charge controller offers more flexibility to the users and reduces installation costs

Net Metering Feature

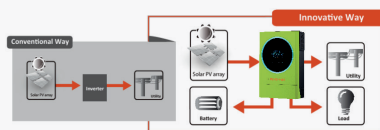

Feed-in to Grid + Load + Battery Charging

FlinInfini Turbo converts the solar power generated to power the load and charge the batteries. All excess power generated will feed-in to the Grid if net metering is activated.

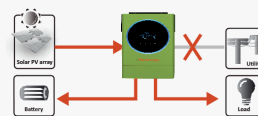

Battery Backup when AC Fail

If the Grid is not available, FlinInfini Turbo will continue to power the load directly from the solar power and the extra solar energy generated is used to charge the batteries.

Battery Compatibility



FlinInfini Turbo is next generation ready. It can be used with or without batteries. It is compatible with Lead Acid, Lithium-Ion and LiFePO4 Batteries. With existing BMS port and multiple options available for lithium-ion batteries, you can pick a lithium bank from a wide variety.

Customizable Display with RGB LED Ring



FlinInfini Turbo comes with big 4.3" LCD Display with touch buttons. It offers three effects for the lighting and multiple settings to custom set the RGB lights as per user. It is designed to offer great flexibility in user operation. The touch buttons on the display allow you to customize more than 30 settings. LED ring lights-up in different colours to depict the operation mode, energy source, battery capacity and load level.

Specifications of FlinInfini Turbo Solar Hybrid Inverter



WiFi



RGB Ring



Wide 4.3inch Display



Modular

| MODELS | 5.6 kW-48V |
|---------------------|--------------------|
| RATED POWER | 5600 VA / 5600 W |
| Parallel Capability | Yes, up to 9 units |

| INPUT | |
|--------------------------|---|
| Voltage | 230 VAC |
| Selectable Voltage Range | 170-280 VAC (For UPS Mode); 90-280 VAC (For Appliance Mode) |
| Frequency Range | 50 Hz/60 Hz (Auto sensing) |

| OUTPUT | |
|------------------------------------|--|
| AC Voltage Regulation (Batt. Mode) | 230 VAC \pm 5% |
| Surge Power (for 5 seconds) | 11200 VA |
| Efficiency (Peak) | 93% |
| Transfer Time | 10 ms (For UPS Mode); 20 ms (For Appliance Mode) |
| Waveform | Pure Sine Wave |
| No Load Power Consumption | < 50 W |

| BATTERY & AC CHARGER | |
|--------------------------------|--------|
| Battery Voltage | 48 VDC |
| Floating Charge Voltage | 54 VDC |
| Overcharge Protection | 66 VDC |
| Maximum Solar Charging Current | 120 A |
| Maximum AC Charging Current | 120 A |

| SOLAR CHARGE CONTROLLER | |
|-----------------------------|--------------|
| Solar Charger Type | MPPT |
| Maximum PV Array Power | 6000 W |
| Maximum PV Input Current | 27A |
| MPPT Voltage Range | 120 ~ 430 VD |
| Max PV Open Circuit Voltage | 450 VDC |

| PHYSICAL & COMMUNICATION | |
|--------------------------|------------------------|
| Dimension (D x W x H) mm | 140 x 295 x 468 |
| Net Weight (kgs) | 12 kgs |
| Communication | RS232/Dry-Contact/WiFi |

| OPERATING ENVIRONMENT | |
|-----------------------|--|
| Humidity | 5% to 95% Relative Humidity (Non-condensing) |
| Operating Temperature | -10°C - 50°C |
| Storage Temperature | -15°C - 60°C |

*Product specifications are subject to change without further notice