

Mysolar

BLACKROOF BlackFrame

SUPO SHINGLED 66SA

SUPER PERC MONO
SHINGLED MODULE

380-400W

POSITIVE TOLERANCE 0~+6W
PERC MONO

New Energy, Smart Living



WHY MYSOLAR?



ECA Tech

Mysolar SHINGLED panel uses ECA (Electrically Conductive Adhesive) instead of Busbar that can reduce heat loss and micro-cracks

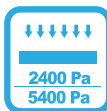

Strong and Safe

Mysolar panels are certified to withstand 2400 Pa negative load of wind and 5400 Pa positive load of snow.



1500V System Voltage

Mysolar panels are of 1500V system voltage design compatible to 1000V/1500V and reduces BoS cost greatly.



PID-Resistant

Mysolar panels are PID-resistant which were tested to the industry's most rigorous durability standards in accordance to IEC 62804.



Better Low Light Output

Mysolar uses the best solar glass, cells, and assembling technology to guarantee good performance in cloudy days or low light conditions.



Salt-resistant & Ammonia-Resistant

Mysolar solar panels are salt mist and ammonia resistance certified.



Positive Tolerance

Mysolar guarantees that all solar modules manufactured by Mysolar have 0~6W positive tolerance.



Confident Warranty

Mysolar offers 30 years limited product warranty and 30 years performance warranty for the Shingled panels.



Higher Output

With multi-busbar (5BB) cells, and 1500V system voltage, super solar glass, Mysolar panels have higher output than its competitors'.



High Reliability

Mysolar has complete testing facilities for tests of UV, TC, HF, EL, etc tests. 100% of Mysolar panels were tested & minimum twice EL tests guaranteed.

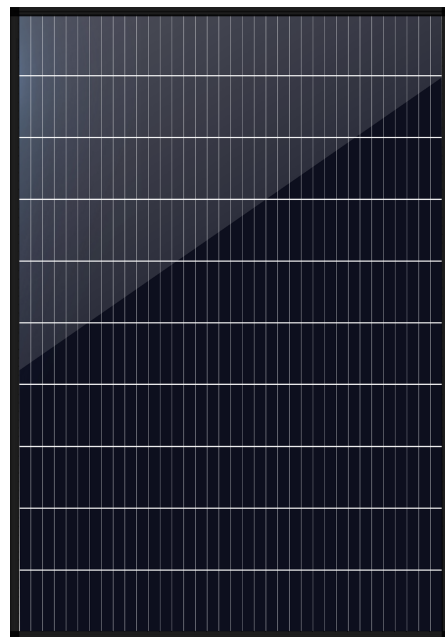

LINEAR PERFORMANCE WARRANTY

30 Year Product Warranty · 30 Year Linear Power Warranty

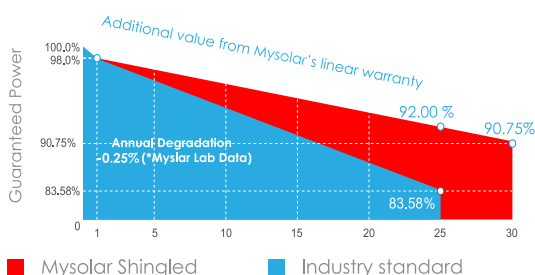

- ISO9001:2015 Quality management systems
- ISO14001: 2015 Quality management systems
- OHSAS18001: 2018 Occupational health and safety management systems
- IEC61215, IEC61730, UL1703 certified product



SPECIFICATIONS

Module Type	MSxxxPM5-66SA, xxx=380-400W				
Maximum Power-Pm [W]	400	395	390	385	380
Open Circuit Voltage-Voc [V]	49.6	49.4	49.3	49.3	49.1
Short Circuit Current-Isc [A]	10.12	10.07	10.03	9.98	9.93
Maximum Power Voltage-Vm [V]	41.0	40.9	40.8	40.8	40.6
Maximum Power Current-Im [A]	9.76	9.66	9.56	9.44	9.36
Module Efficiency-η [%]	21.3	21.1	20.8	20.5	20.3
Operating Temperature (°C)	-40°C~+85°C				
Maximum System Voltage	1500VDC/1000VDC				
Maximum Series Fuse Rating	20A				
Power Tolerance	0~+6W				
Temperature Coefficients of Pmax	-0.34%/°C				
Temperature Coefficients of Voc	-0.27%/°C				
Temperature Coefficients of Isc	0.04 %/°C				
Nominal Operating Cell Temperature (NOCT)	45±2 °C (42.3±2°C in NMOT)				

STC: Irradiance 1000W/sqm Cell Temp: 25 °C AM=1.5 °C

NOCT: Irradiance 800W/sqm Ambient Temp: 20 °C AM=1.5 Wind Speed 1m/s

* Power measurement tolerance: -/+3%

I-V Curve

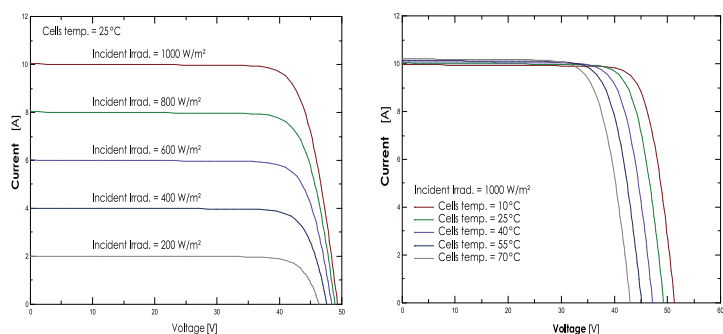

Mechanical Diagrams

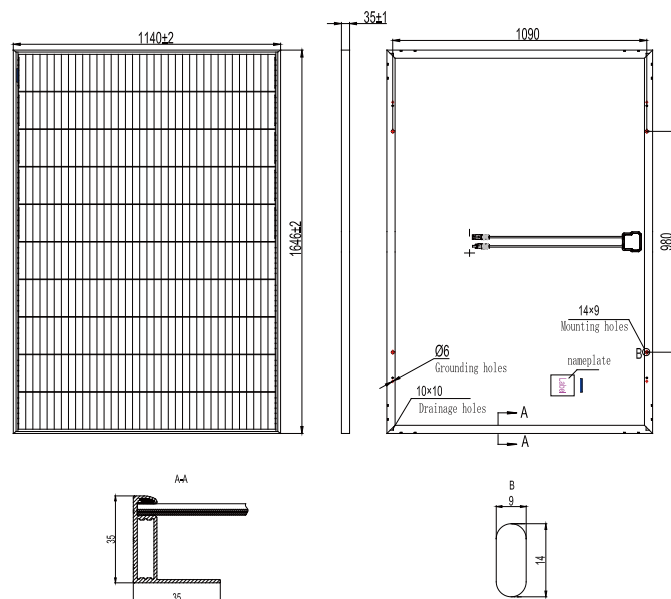

Mechanical Characteristics

Cell Type	Mono PERC 158.75×158.75mm(6.25×6.25inch)
No. of cells	360 (36×10)
Dimensions	1646*1140*35mm
Weight	20.50kg Approx
Front Glass	3.2mm, Anti-Reflection Coating, High Transmission, Tempered Glass
Frame	Anodized Aluminium Alloy
Junction Box	IP67/IP68, 2 diodes
Cable & Connector	4mm² cable MC4 compatible

Packaging Info

(Two pallets = One stack)

31pcs/pallet, 62pcs/stack, 868pcs/40'HQ Container, 310pcs/20' GP

Mysolar reserves the right to make necessary adjustment to the information described herein at any time without further notice due to continuous innovation and product improvement. Please be kindly noted installation of Mysolar solar modules shall be done by professional skilled people. Please read the installation manual carefully before using Mysolar solar panels.

Mysolar is a **Mamibot** company and brand. **Mysolar** and **Mamibot** are trademarks of Mamibot Manufacturing USA Inc.

Mamibot Manufacturing USA Inc.

www.mamibot.com Tel: 001 302 428 9888 sales@mamibot.com Head Office: Orange St. #600, Wilmington, New Castle, 19899, Delaware, USA

Manufacturer: Mysolar Manufacturing (Shanghai) Co., Ltd.

www.mamibot.com/mysolar Tel: 0086 21 62147369 North Part, 21ST Fl, No.1, LN1040, Caoyang Rd, Putuo Dist, Shanghai, P.R.C.