

**LINDNER**



**KOMET 2200 HP | 2800 HP  
STATIONARY SECONDARY SHREDDING**

**UNABASHEDLY  
STRONG.**

ONLY LINDNER CLIENTS CAN TRULY SAY:

# THAT'S HOW TO ACHIEVE UNPARALLELED THROUGHPUT.

## GIVES YOUR PROCESSES A BOOST: MORE KNIVES, MORE EFFICIENCY.

The Lindner Komet HP is synonymous with high performance in secondary shredding. With an output 60% higher than the standard Komet series and two additional knife rows, the shredder guarantees enormous production capacities. High-precision electronics in combination with particularly robust housing components ensure the machine's enormous durability, even under the toughest conditions. And it produces consistently high-quality SRF – which is what the name Komet stands for.



### 1. HYDRAULIC MAINTENANCE DOOR

**Remove non-shreddables quickly and cleanly** with the maintenance door at position 2.

**100% safe operation** due to the mechanical safety lock and the pusher's special parking position.

**Enjoy convenient maintenance access** to the cutting chamber with the maintenance door at position 3.



### 2. HIGH-PERFORMANCE BELT DRIVE

**More output** with high-performance ABB motors.

**High-precision electronics** for precise drive control.

**Efficient, stable and gearless** belt drive.

**Global availability** of easily exchangeable standard parts.



### 3. TORQUE-LIMITING SAFETY CLUTCH

**Complete drive protection** thanks to the drive unit's instant mechanical disengagement.

**Fully adjustable** to various materials.

**Secure power down** with our proven sensors.

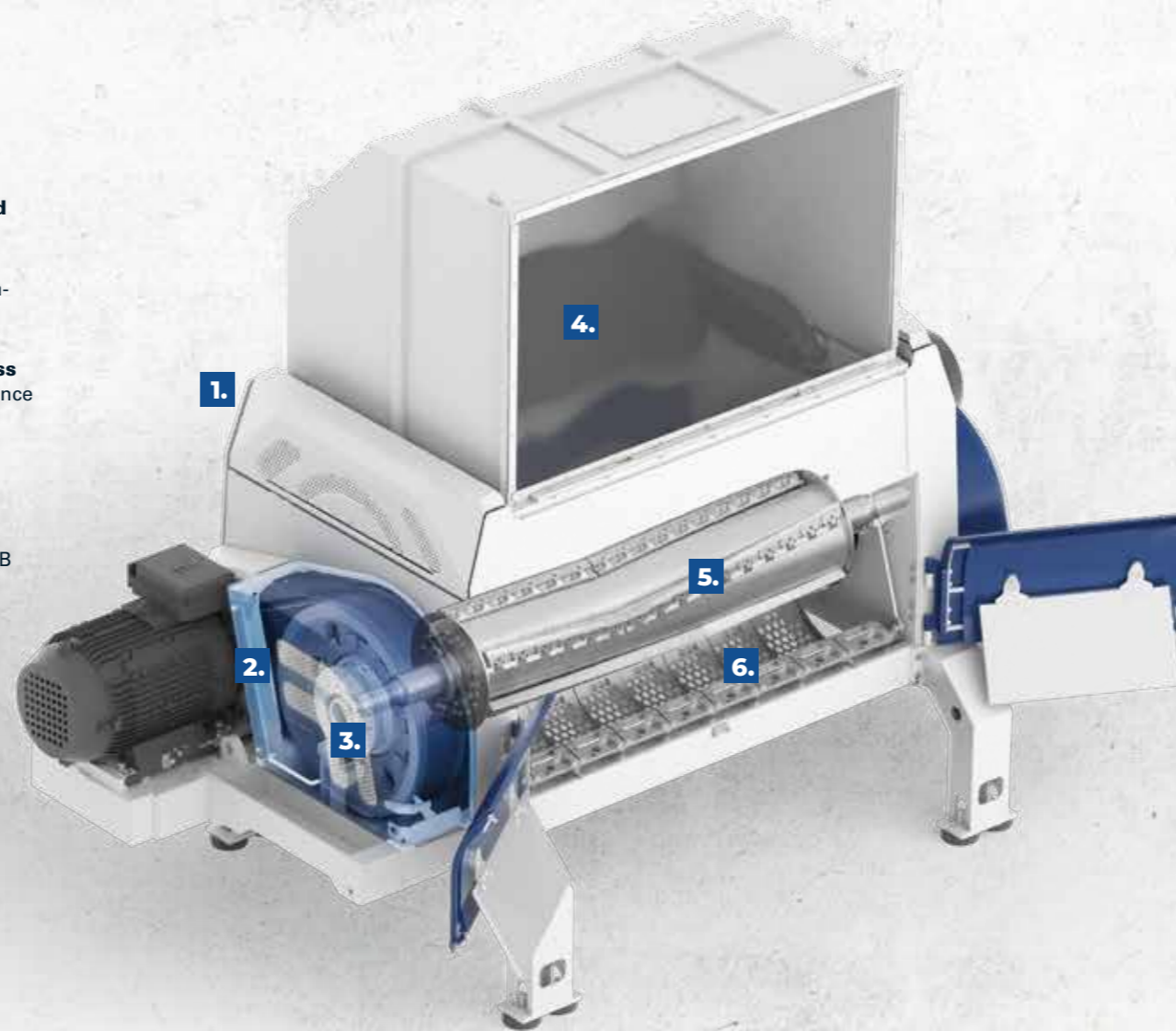

### 4. INTERNAL PUSHER

**Continuous shredding** due to smooth feeding.

**Easy feeding** with a completely internal construction.

**Delightfully maintenance-free** thanks to the absence of guide elements.



### 5. HIGH-PERFORMANCE SHEAR CUTTING SYSTEM

**Seven rows of knives** for over 5,000 cuts per minute.

**Consistent particle size** with a cutting gap fully adjustable even during operation.

**Parts storage made easy** thanks to identical knives, counter knives and scrapers.

**Maximum service life** ensured by quadruple-use, quick-change knives.



### 6. PLUG & GO SCREEN UNIT

**Flexible output sizes** made possible with screen units in various hole sizes..

**Easy access for maintenance and fitting** thanks to the swivel-mounted, hydraulically operated design.

**Extremely safe operation** with the electromagnetically locked screen access point, preventing access to the cutting chamber while the machine is in operation.



# TECHNICAL DATA

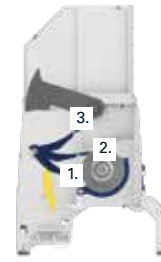
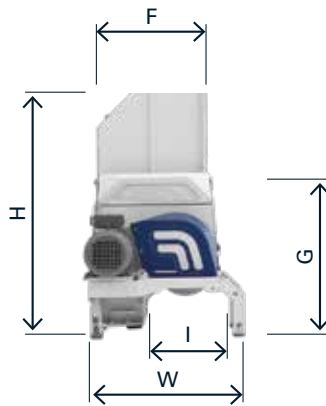
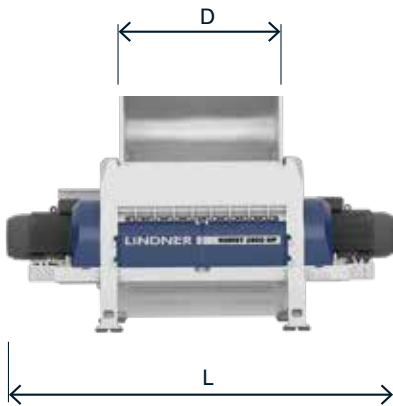

Hydraulic door for maintenance and removal of foreign objects

1. Operating position
2. Position for removal of foreign objects
3. Position for maintenance

## KOMET 2200 HP

## KOMET 2800 HP

### DIMENSIONS\*

Measure (LxWxH)	mm	5813 x 2925 x 3111	6827 x 2925 x 3111
Hopper opening (DxF)	mm	2135 x 2030	2825 x 2030
Capacity	m <sup>3</sup>	4	5.3
Outlet width (I)	mm	960	960
Weight	kg	23200	29000

### CUTTING UNIT\*

Length	mm	2115	2805
Speed	min <sup>-1</sup>	355	367
Standard tool		blade knives 172R	blade knives 172R
Number of knives	pcs.	84	112
Screens		hexagonal/round	hexagonal/round
Number of screens	pcs.	6	8
Final output	mm	10–100	10–100

### DRIVE UNIT\*

Type		belt drive	belt drive
Motor	kW	2 x 200	2 x 250
Power control		frequency converter	frequency converter

\*The stated values refer to standard machine versions with a standard hopper and raised feet. The right to make technical changes is reserved.



Atex explosion protection



Water sprinkling system



Fire extinguishing system  
with spark detection



Cutting system cooling

## Lindner-Recyclingtech GmbH

Villacher Strasse 48 | 9800 Spittal/Drau | Austria  
t.: +43 4762 2742 | f.: +43 4762 2742-9032 | office@lindner.com

[www.lindner.com](http://www.lindner.com)